

A  
1505-200

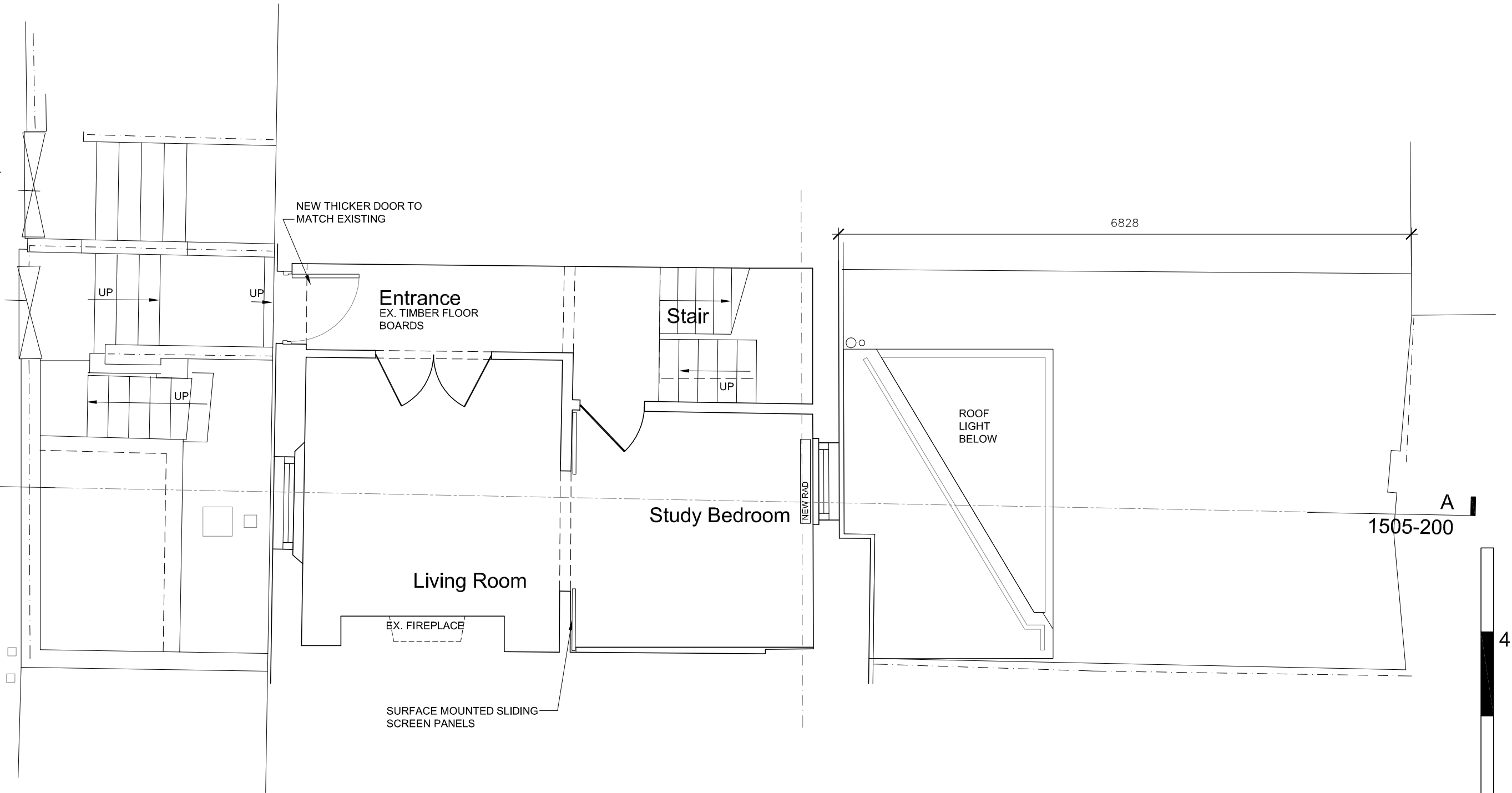

Proposed Ground Floor Plan

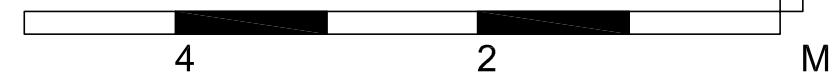

**general notes**

THIS DRAWING IS COPYRIGHT OF CLIFTON INTERIORS LTD. THIS DRAWING MUST BE READ IN CONJUNCTION WITH THE DESIGNER'S RISK ASSESSMENT, SPECIFICATION AND ALL OTHER RELEVANT DOCUMENTATION AND DRAWINGS. CLIFTON INTERIORS LTD ACCEPT NO LIABILITY FOR ANY EXPENSE, LOSS OR DAMAGE OF WHATSOEVER NATURE AND HOWEVER ARISING FROM ANY VARIATION MADE TO THIS DRAWING OR IN THE EXECUTION OF THE WORK TO WHICH IT RELATES WHICH HAS NOT BEEN REFERRED TO THEM AND THEIR APPROVAL OBTAINED.

DO NOT SCALE FROM THIS DRAWING OR THE COMPUTER DIGITAL DATA. ONLY FIGURED DIMENSIONS ARE TO BE USED.

IF IN DOUBT ASK.

**purpose of issue**  
**PLANNING & LISTED BUILDING**

**notes**

\* do not scale from this drawing.  
\* check all dimensions on site.

**project name**

ANN & LAWRENCE JACOBS  
57 FLASK WALK  
LONDON NW3 1EY

**drawing title**

CLIFTON INTERIORS  
PROPOSED GENERAL  
ARRANGEMENT  
GROUND FLOOR

scale 1:50@A3	date 18.01.16	project ref. 1505	drawing no. 1505 - P - 101	revision #
drawn by MZ	checked -			

**CLIFTON INTERIORS LTD**  
168 Regents Park Road  
Primrose Hill, London NW1 8XN  
t : 020 7586 5533  
f : 020 7586 1987  
e : info@cliftoninteriors.com  
www.cliftoninteriors.com