

Camline Ref: LONDON GENERAL/LL434 TYBALDS ESTATE/Camline Work/Drawings/LL434-100-TENDER [Ref: LL434REF-300-PUBLIC REALM BASES: LL434REF-300-OS BASE:]

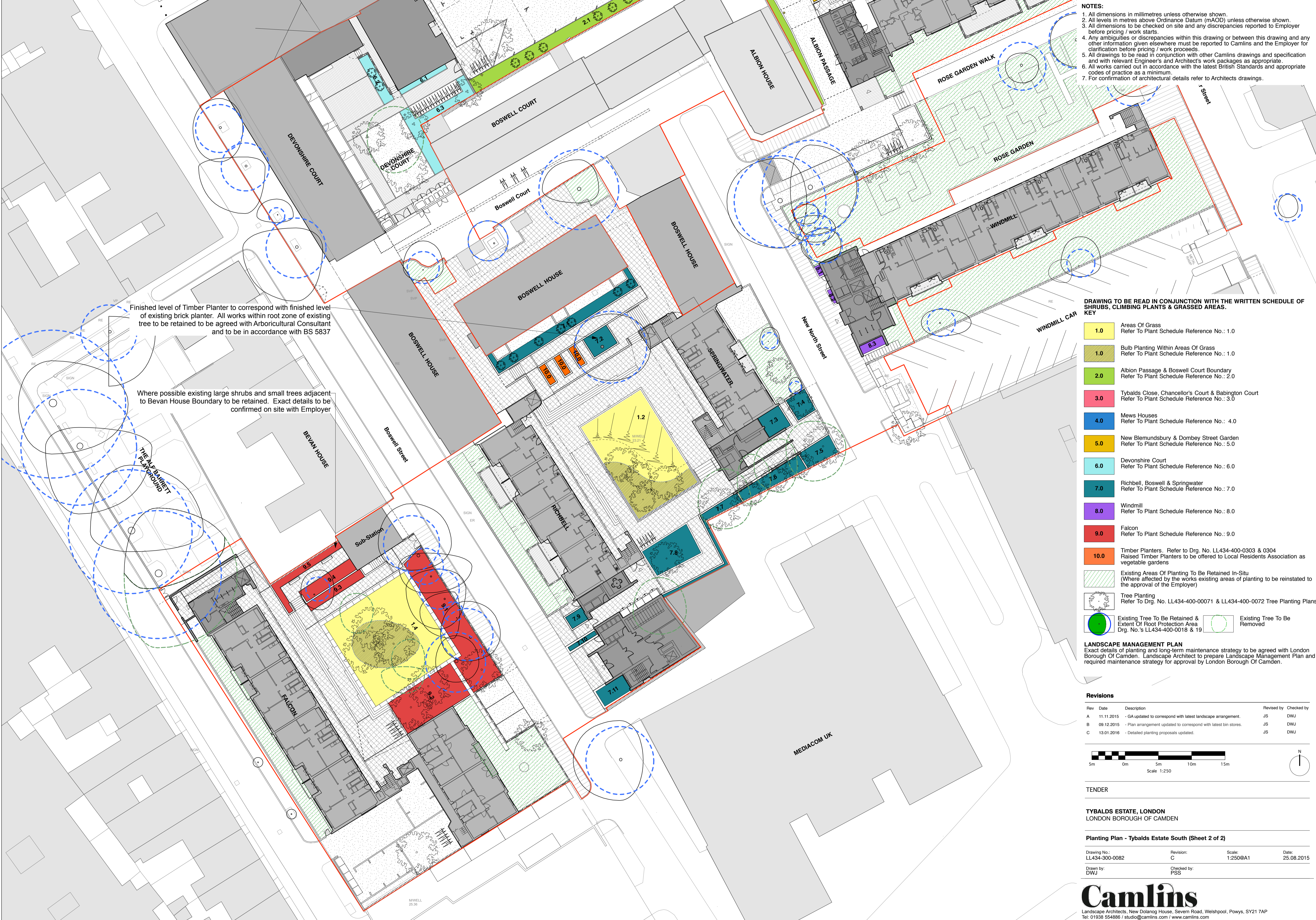

- NOTES:**
1. All dimensions in millimetres unless otherwise shown.
 2. All levels in metres above Ordnance Datum (mAOD) unless otherwise shown.
 3. All dimensions to be checked on site and any discrepancies reported to Employer before pricing / work starts.
 4. Any ambiguities or discrepancies within this drawing or between this drawing and any other information given elsewhere must be reported to Camlins and the Employer for clarification before pricing / work proceeds.
 5. All drawings to be read in conjunction with other Camlins drawings and specification and with relevant Engineer's and Architect's work packages as appropriate.
 6. All works carried out in accordance with the latest British Standards and appropriate codes of practice as a minimum.
 7. For confirmation of architectural details refer to Architects drawings.

Finished level of Timber Planter to correspond with finished level of existing brick planter. All works within root zone of existing tree to be retained to be agreed with Arboricultural Consultant and to be in accordance with BS 5837

Where possible existing large shrubs and small trees adjacent to Bevan House Boundary to be retained. Exact details to be confirmed on site with Employer

DRAWING TO BE READ IN CONJUNCTION WITH THE WRITTEN SCHEDULE OF SHRUBS, CLIMBING PLANTS & GRASSED AREAS. KEY

- 1.0 Areas Of Grass Refer To Plant Schedule Reference No.: 1.0
- 1.0 Bulb Planting Within Areas Of Grass Refer To Plant Schedule Reference No.: 1.0
- 2.0 Albion Passage & Boswell Court Boundary Refer To Plant Schedule Reference No.: 2.0
- 3.0 Tybalds Close, Chancellor's Court & Babington Court Refer To Plant Schedule Reference No.: 3.0
- 4.0 Mews Houses Refer To Plant Schedule Reference No.: 4.0
- 5.0 New Blomundsburly & Dombey Street Garden Refer To Plant Schedule Reference No.: 5.0
- 6.0 Devonshire Court Refer To Plant Schedule Reference No.: 6.0
- 7.0 Richbell, Boswell & Springwater Refer To Plant Schedule Reference No.: 7.0
- 8.0 Windmill Refer To Plant Schedule Reference No.: 8.0
- 9.0 Falcon Refer To Plant Schedule Reference No.: 9.0
- 10.0 Timber Planters Refer to Drg. No. LL434-400-0303 & 0304 Raised Timber Planters to be offered to Local Residents Association as vegetable gardens
- Existing Areas Of Planting To Be Retained In-Situ (Where affected by the works existing areas of planting to be reinstated to the approval of the Employer)
- Tree Planting Refer To Drg. No. LL434-400-00071 & LL434-400-0072 Tree Planting Plans
- Existing Tree To Be Retained & Extent Of Root Protection Area Drg. No.'s LL434-400-0018 & 19
- Existing Tree To Be Removed

LANDSCAPE MANAGEMENT PLAN
Exact details of planting and long-term maintenance strategy to be agreed with London Borough Of Camden. Landscape Architect to prepare Landscape Management Plan and required maintenance strategy for approval by London Borough Of Camden.

Revisions

| Rev | Date | Description | Revised by | Checked by |
|-----|------------|------------------------------------------------------------------|------------|------------|
| A | 11.11.2015 | - GA updated to correspond with latest landscape arrangement. | JS | DWJ |
| B | 09.12.2015 | - Plan arrangement updated to correspond with latest bin stores. | JS | DWJ |
| C | 13.01.2016 | - Detailed planting proposals updated. | JS | DWJ |

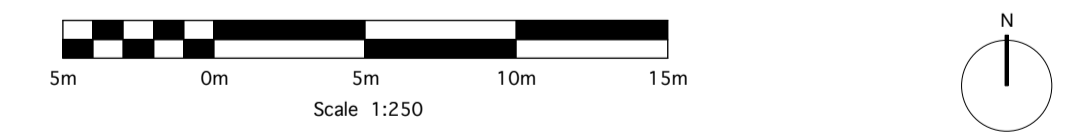

TENDER

TYBALDS ESTATE, LONDON
LONDON BOROUGH OF CAMDEN

Planting Plan - Tybalds Estate South (Sheet 2 of 2)

| | | | |
|-----------------------------|-----------------|-----------------|------------------|
| Drawing No.: LL434-300-0082 | Revision: C | Scale: 1:250@A1 | Date: 25.08.2015 |
| Drawn by: DWJ | Checked by: PSS | | |