

No. 17

No. 15

No. 13

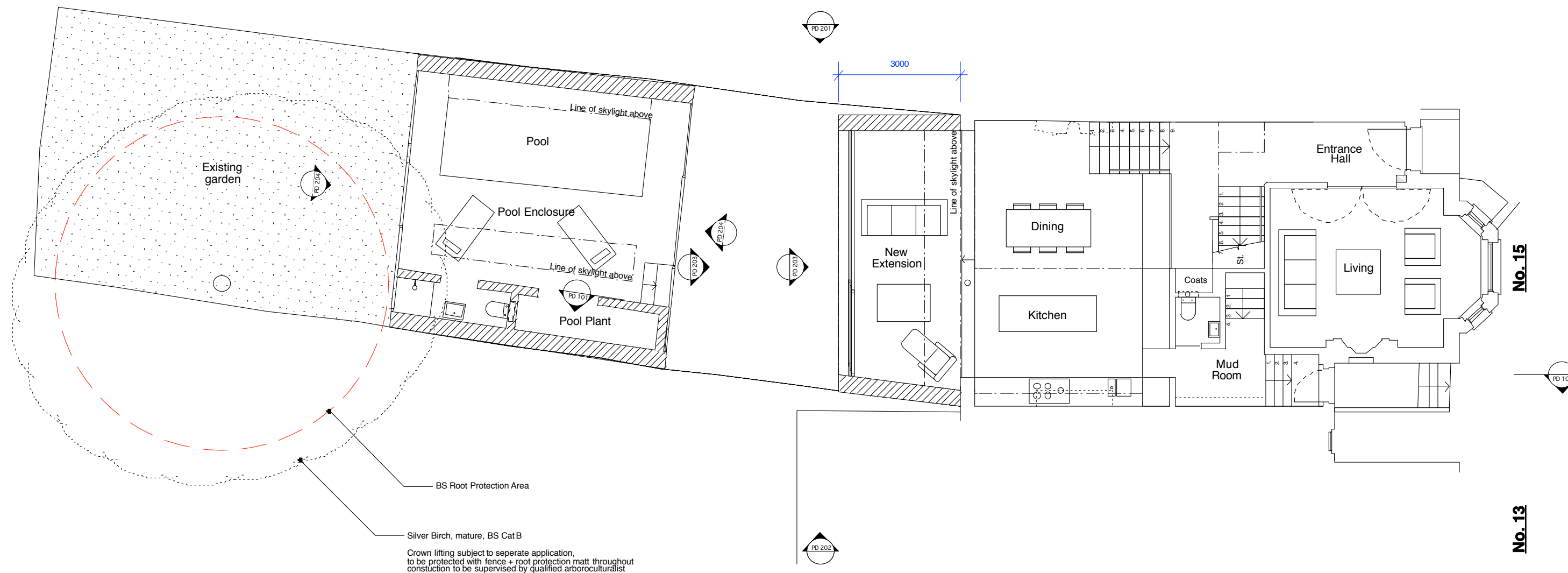

Crown lifting subject to separate application, to be protected with fence + root protection matt throughout construction to be supervised by qualified arboriculturalist

**Notes**

These plans and specifications prepared by Robert Dye Architects LLP as instruments of professional service shall remain the property of Robert Dye Architects LLP.

These plans may not be copied or re-used without the express written consent of Robert Dye Architects LLP. The use of these plans for construction is permitted only when specifically released for construction reference by a dated authorised signature.

These plans are project and site specific and shall only be used for their intended purpose unless otherwise permitted by written consent of Robert Dye Architects LLP.

All dimensions shown are indicative and must be double checked on site by the contractor. Any inconsistencies found must be reported to Robert Dye Architects LLP.

DO NOT SCALE FROM THE DRAWING

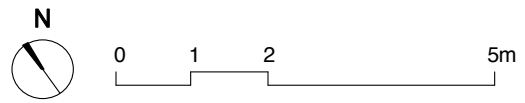

Rev	Date	Notes	robertdye	
A	22.01.16	Revised as agreed with planning officer	Robert Dye Architects LLP 4 Ella Mews, Cressy Road London NW3 2NH tel: 020 7267 9388 fax: 020 7267 9345 www.robertdye.com email: info@robertdye.com	
B	27.01.16	Revised as agreed with planning officer		
			project	project no
			15 Platts Lane	255
			drawing	scale
			Proposed Ground Floor	1:100@A3
			drawing no	rev
			PD 001	B
			date	Nov 2015
			dwg status	Planning