

BASEMENT / GARDEN PLAN
SHOWING FOUNDATIONS AND UNDERPINNING.

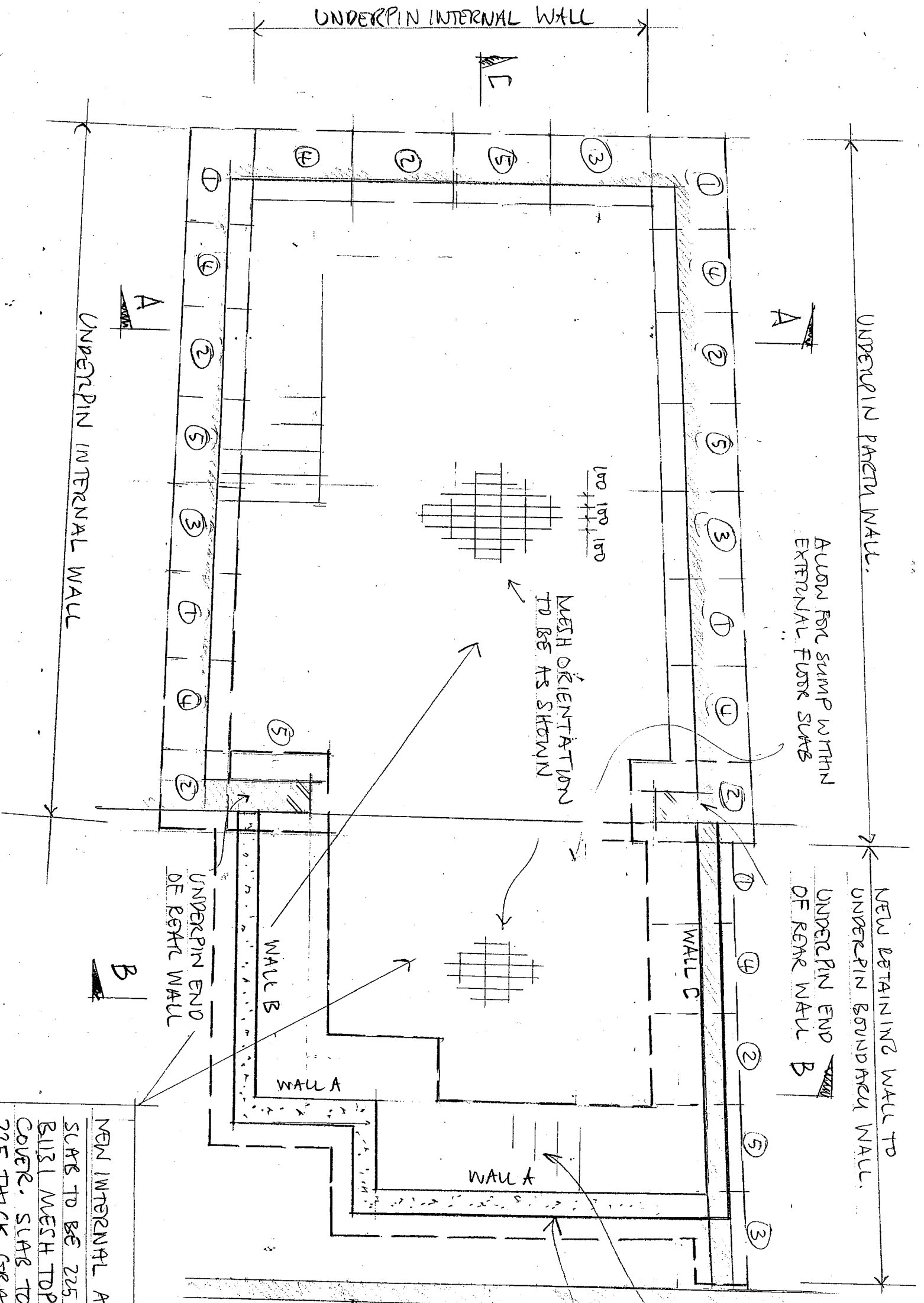

NEW INTERNAL AND EXTERNAL FLOOR SLAB.
 SLAB TO BE 225 THICK REINFORCED WITH
 BLIST MESH TOP AND BOTTOM - WITH 40mm
 COVER. SLAB TO BE ON CELLCORE CP
 225 THICK GRADE 9/13

EXISTING GARDEN WALL
 TO BE RETAINED AND SUPPORTED
 DURING WORKS

REFER DRAWING SHEET 6
 FOR UNDERPINNING
 SPECIFICATION.
 SEQUENCES SHOWN ON PLAN
 TO BE CONFIRMED BY
 BUILDER

GARDEN STEPS FORMED IN
 REINFORCED CONCRETE
 WITH 150 WAIST

REINFORCED CONCRETE
 GARDEN RETAINING WALL
 250 THICK

- REINFORCED CONCRETE**
1. CONCRETE WORK TO BE IN ACCORDANCE WITH THE NATIONAL STRUCTURAL CONCRETE SPECIFICATION FOR BUILDING CONSTRUCTION.
 2. CONCRETE TO BE DESIGNATED MIX RC35/40 TO BS8500. 20mm NOMINAL AGGREGATE. 75mm SLUMP.
 3. ALL REINFORCEMENT TO BE FIXED IN PLACE USING THE WIRE AND PURPOSE MADE CHAIRS AND SPACERS PRIOR TO PLACING CONCRETE.
 4. COMPACT CONCRETE USING VIBRATING POKER.
 5. FLOATED FINISH TO ARCHITECT'S SPECIFICATION.
 6. COVER TO REINFORCEMENT 50mm TO TOP, 50mm TO BOTTOM AND SIDES.
 7. 50mm THICK CONCRETE BLINDING TO BE PROVIDED UNDER SLABS.
 8. REINFORCEMENT LAPS 42 x BAR DIAMETER MINIMUM.
 9. PILE PENETRATION INTO CAPPING BEAMS 50mm.
 10. REINFORCEMENT FROM PILES TO HAVE FULL ANCHORAGE LENGTH INTO CAPPING BEAMS.

REV A 16/12/15. WALL C REVISD

| | |
|---------|--|
| CLIENT | |
| PROJECT | 28 COMPAYNE GARDENS LONDON NW6 |
| DRAWING | INTERNAL & EXTERNAL ALTERATIONS STRUCTURAL DETAILS SHEET 3 OF |

| | | | |
|---|-------|-----------|----------|
| DRAWN | BP | CHECKED | FILE NO. |
| | SCALE | | |
| <p>BIRD Associates CONSULTING ENGINEERS</p> <p>324 St. Johns Road Epsom Surrey TD11 2JN 439653 Tel: 01724 473763 Fax: 01724 473765 Email: mail@bird-associates.co.uk</p> | | | |
| DATE | | 6724/03 A | |

FIR TENDER