

Internal Plant
Green&Cool Pack
Model: Crystat CO2vin Pack EM1600H2500H 1500H
Dimension: 2450mm(w) x 650mm(d) x 1950mm(h)

External Plant
Green&Cool Gas Cooler
Model: GASCO AL91 CO2 2MSD EC M2 SV
Weight: 500kg
Dimension: 4170mm(L) x 1137mm(D) x 1530mm(H)
Sound pressure : 26dB(A) @ 10m

Manager's office AC unit
(Unit only operational during store trading hours)
Model: FXS35L
Dimension: 765mm(w) x 285mm(d) x 550mm(h)
Sound pressure level: 48dB(A) @ 1m

Electrics
TP&N supply to the new plant.
Nominal Current: 45Amps
Max Current: 75Amps

Single Phase supply to the unit
4.10amp running current
10amp fuse rating

25A TP&N supply to the ref dis board for remote cases and coldrooms.

Refrigeration contractor shall liaise with Box Clever to install the plantroom ventilation.

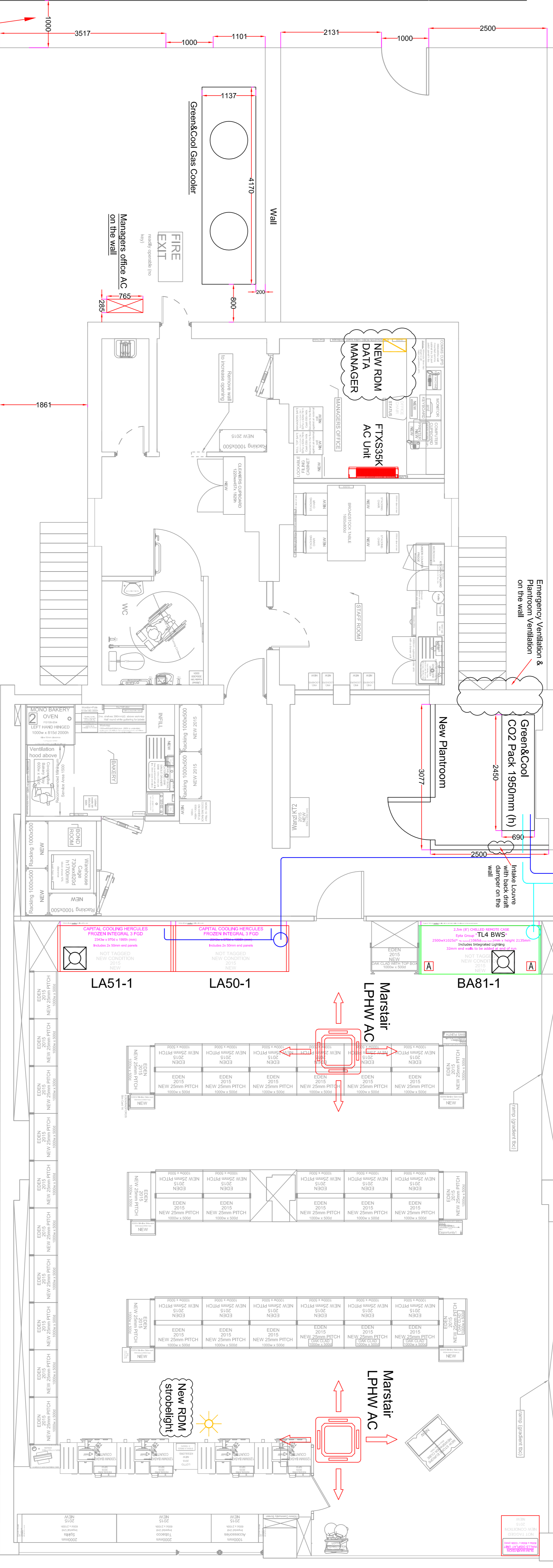

Gas Cooler to be shifted through this 1m wide alley way by removing the legs and tilted to its side. Specialist Lift and Shift assistance required.

AC Units
Sales area heating by Low Pressure Hot Water system utilising CO2 heat recovery.
Single Split wall mounted AC to manager's office.

Alarm System
New RDM Data Manager.
Install new sales area strobe light.

- Builder's works**
- Task lighting similar to LED floodlight at the external plant location
 - Task lighting at internal pack location
 - Holes through the walls for services and making good
 - Removal and refitting of ceiling tiles for services installation
 - Aesthetic cladding of internal services where necessary
 - Provide a drain up stand in the warehouse to terminate condensate drain pipework
 - Flat, level and smooth concrete plinth for the external condenser

- Builder's works**
- Wire mesh above the coldrooms to prevent goods storage. There shall be a maintenance access door for the service engineer
 - Minimum 100mm gap between the top of the integral case and the bottom of the fascia boards to allow air flow.
 - Minimum 100mm gap to the rear of integral case as per manufacturer's recommendations
 - Ensure the fascia/freeze boards are removable for maintenance access to case controllers on top of BWS chillers

Key

- HT pipe route
- LT pipe route
- Discharge
- Liquid
- Single riser
- Double riser
- Services drop
- Condensate drain pump
- Drain upstand
- AC cassette
- AC wall mounted unit
- AC outdoor unit
- RDM panel
- RDM beacon

J	JGM	11/01/16	Gas cooler noise level corrected.
H	JGM	06/01/16	Gas cooler location changed.
G	JGM	21/10/15	Office AC sound pressure level added.
F	JGM	21/10/15	Ventilation location added.
E	JGM	12/10/15	Design Notes added.
D	SW	06/10/15	Freezers changed to remote cases.
C	JGM	02/07/15	Plant changed to CO2 pack & Gas Cooler.
B	JGM	07/04/15	AC Location changed. Condenser transfer role added.
A	JGM	01/04/15	Attenuated Housing for the AC.

Client
The co-operative
good with food

Project
ICG
Cricklewood, Broadway

Bridge Mills
Huddersfield Road
Holmfirth
HD9 3TW

Tel: 01484 680069
Fax: 01484 680041
E-Mail: info@bjarefr.com

PROPOSED
GENERAL LAYOUT
OF REFRIGERATION

Scale: NTS
Date: 07/10/15
Drawn: SW
Checked: [Signature]
Approved: [Signature]

Drawing No: 2015010074-01
Rev: J

Notes:
This drawing is for refrigeration design only.
The design is based on the information provided and is not a guarantee of performance.
All dimensions are to be checked on site and any discrepancy to be reported immediately.
All works to comply with current building regulations health and safety standards.