

Avenue Road

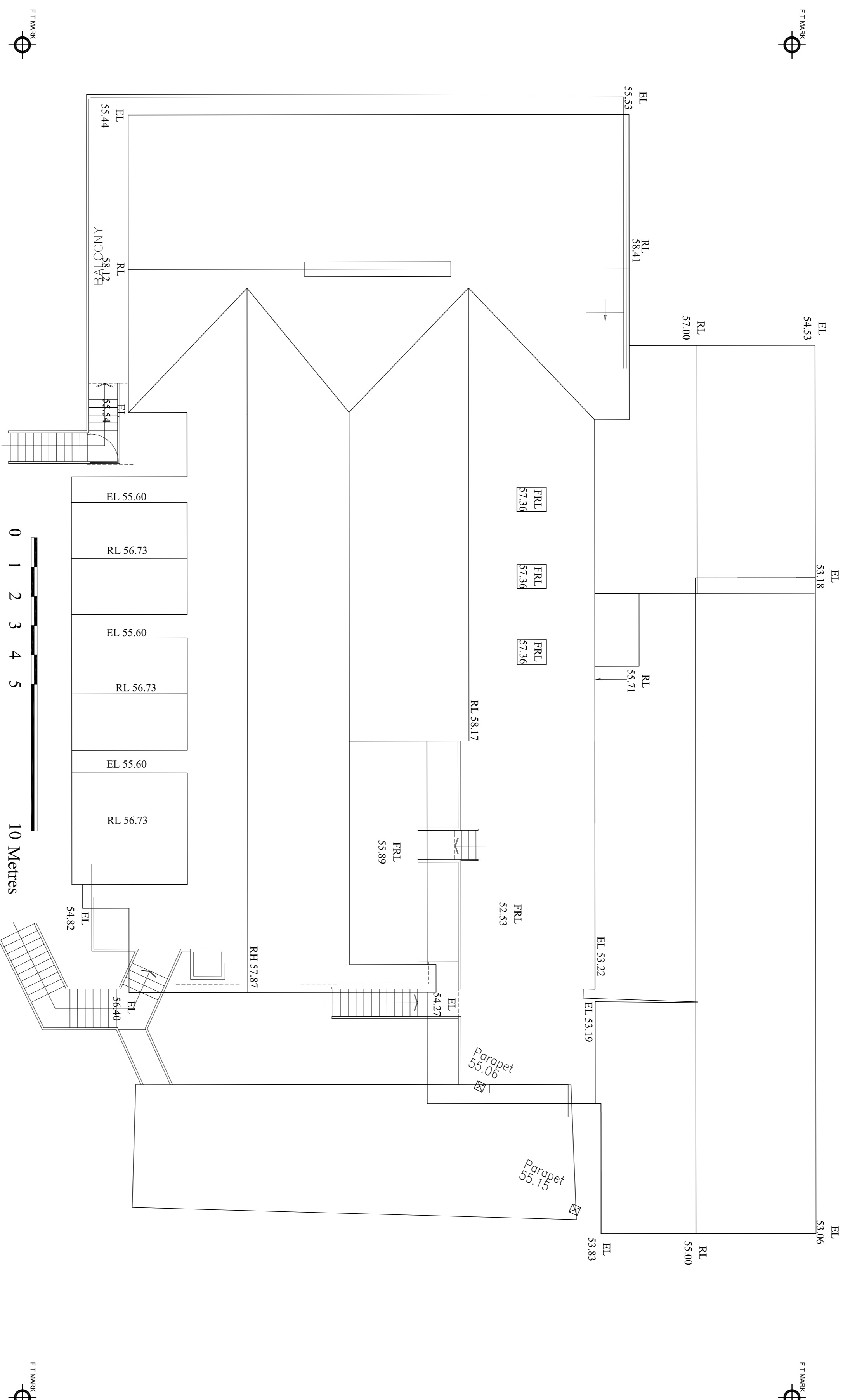

Finchley Road

REVISION A :-11.11.2015 PRE APP SUBMISSION

Notes:

- 1.0 GENERAL
All rights described in Chapter IV of the Copyright and Patents Act 1988 have been generally asserted. All dimensions to be checked on site.
No part shall be copied, stored in a retrieval system, or transmitted in any form or by any means, electronic, mechanical, photocopying, recording, or by any information storage and retrieval system, without the prior consent in writing of ANDREWS AND BOYD. This drawing is not to be scaled for the purposes of setting-out. Dimensions to be checked on site and verified prior to commencing.
- 2.0 CONDITIONS
All works to comply with BS 6187
Ensure that existing and adjacent structures are fully weather tight throughout the work. Contractor is fully responsible for all temporary support throughout.
- 3.0 CONCRETE WORKS
All works to comply with BS 5228 & BS 8110
- 4.0 BRICKWORK AND BLOCKWORK
All works to comply with BS 5625
- 5.0 ASPHALT
All asphalt tacking to comply with BS 6229
- 6.0 STRUCTURAL TIMBER
All works to comply with BS 5187
Ensure that existing and adjacent structures are fully weather tight throughout the work. Contractor is fully responsible for all temporary support throughout.
- 7.0 LEADWORK
All works to comply with BS 1179 and LVA recommendations.

- 8.0 CARPENTRY AND JOINERY
All work to be finished in waterproof sand and cement mortar on girt.
All work to be finished in waterproof sand and cement mortar on girt.
All work to be finished in waterproof sand and cement mortar on girt.
- 9.0 VENTILATION
All work to be mechanically ventilated in accordance with Building Regulations Part F1
- 10.0 DRAINAGE
All work to be in accordance with BS 8301 & Part H4 of the Building Regulations 1991 and BS 6397. All below ground drainage to be in 100mm diameter on approved bed and access and cording points to be provided as necessary. Aluminium waste diameters: soil 100, vent, clean, sewer 38, boiler 52, and kitchen appliances 50.
- 11.0 ELECTRICAL INSTALLATION
All works must comply with IEE regs latest edition. Test certificate required upon completion.
- 12.0 GAS INSTALLATION
All work must comply with Gas Safety regs 1972 & Gas Safety regs Amendments 1984.

North	Client	ANDREWS AND BOYD	Project	THE OLDE SWISS COTTAGE, 98 FINCHLEY ROAD, ST JOHN'S WOOD, LONDON, NW3 9EL.
	Scale			
Project No.	Date	Revision	Drawing No.	
	MAY 2015	A	E004	
<p>Andrews + Boyd Consultants Limited</p> <p>24 Old Burlington Street. London. W1S 3AW</p>				