

Do not scale from this drawing
All dimensions to be checked on site

Notes:

PROPOSED LIGHTWELL ELEVATIONS:

Annotations:

1. WINDOW TO BE REPLACED WITH A FIRE RATED WINDOW FIXED SHUT. WINDOW WILL BE WHITE PAINTED TIMBER WITH GLAZING BARS TO MATCH EXISTING.

2. EXISTING WINDOWS TO BE OVERHAULED OR REPLACED WHERE REQUIRED.

GENERAL NOTE:
NEW GLAZING TO HAVE LIGHT TRANSMITTANCE FACTOR OF 0.8 OR BETTER, REFER TO RIGHTS OF LIGHT CONSULTING LTD REPORT.

Amendments:
REV #, 2015-11-11.
REV A, 2016-01-14.

Drawing type:
PLANNING

Client:
L. B. CAMDEN

Project:
GREAT RUSSELL MANSIONS

Title:
PROPOSED LIGHTWELL ELEVATIONS - FLAT 3:
ELEVATION 1, 2

Scale: 1:100@A3 Date: 11/11/2015

Drawn: JMArchitects Checked: SB

Drg.no: 5922-S(1)004

Rev: A

Heritage Surveys Ltd.

Heritage Surveys Limited
20 Hanover Square
London
W1S 1JY
www.heritage-surveys.com



7.000M

ELEVATION 1

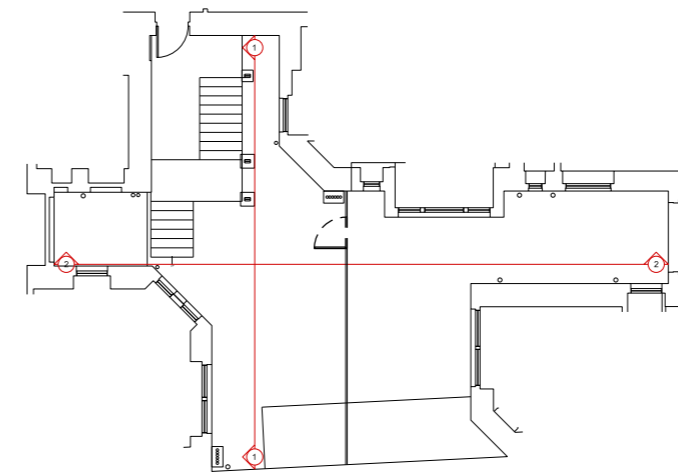

LIGHTWELL A



7.000M

ELEVATION 2