

Copyright: All rights reserved. This drawing must not be reproduced without permission.
 Only the original drawing should be relied upon. Contractors, sub-contractors and suppliers must verify all dimensions on site before commencing any work or making any shop drawings.
 All shop drawings to be submitted to the architect / interior designer for comment prior to fabrication.
 This drawing is to be read in conjunction with the architect's / interior designer's specification, bills of quantities / schedules, structural, mechanical & electrical drawings and all discrepancies are to be reported to the architect / interior designer.
 Do not scale from this drawing. Dimensions are in millimetres unless otherwise stated.

NOTES

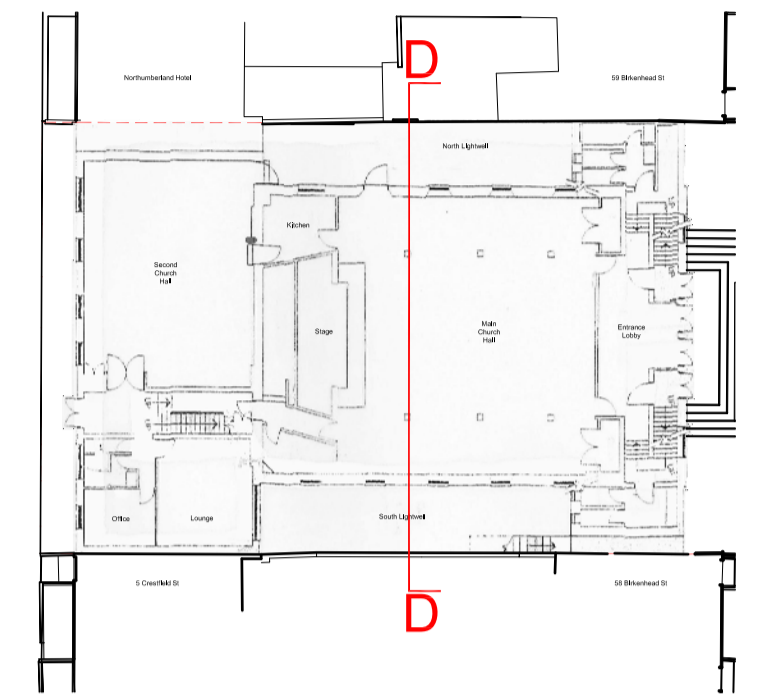

Existing Section DD
 Scale 1:200 @A3
 1:100 @A1

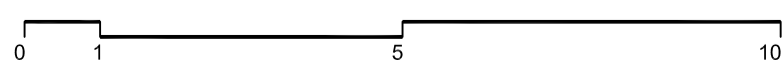

rev	amendments	date	by
P0	Issued for planning	19.01.16	JB

dexter moren associates <small>architecture urban design interior design creative media www.dextermoren.com dmaj@dextermoren.com</small>	57d jamestown road london nw1 7db UK
architecture	t: 020 7267 4440 f: 020 7267 6044

project	King's Cross Methodist Church
client	West London Mission Circuit of the Methodist Church (WLM)
drawing title	Existing Section DD
drawing status	Planning

scale	date	drawn by	checked by
1:100 @ A1	19.01.16	JB	HL
1:200 @ A3			

job no.	drawing no.	revision
0948	A-025-124	P0