

1 Proposed head detail through front elevation  
DETAILED SECTION A - A - 1:5

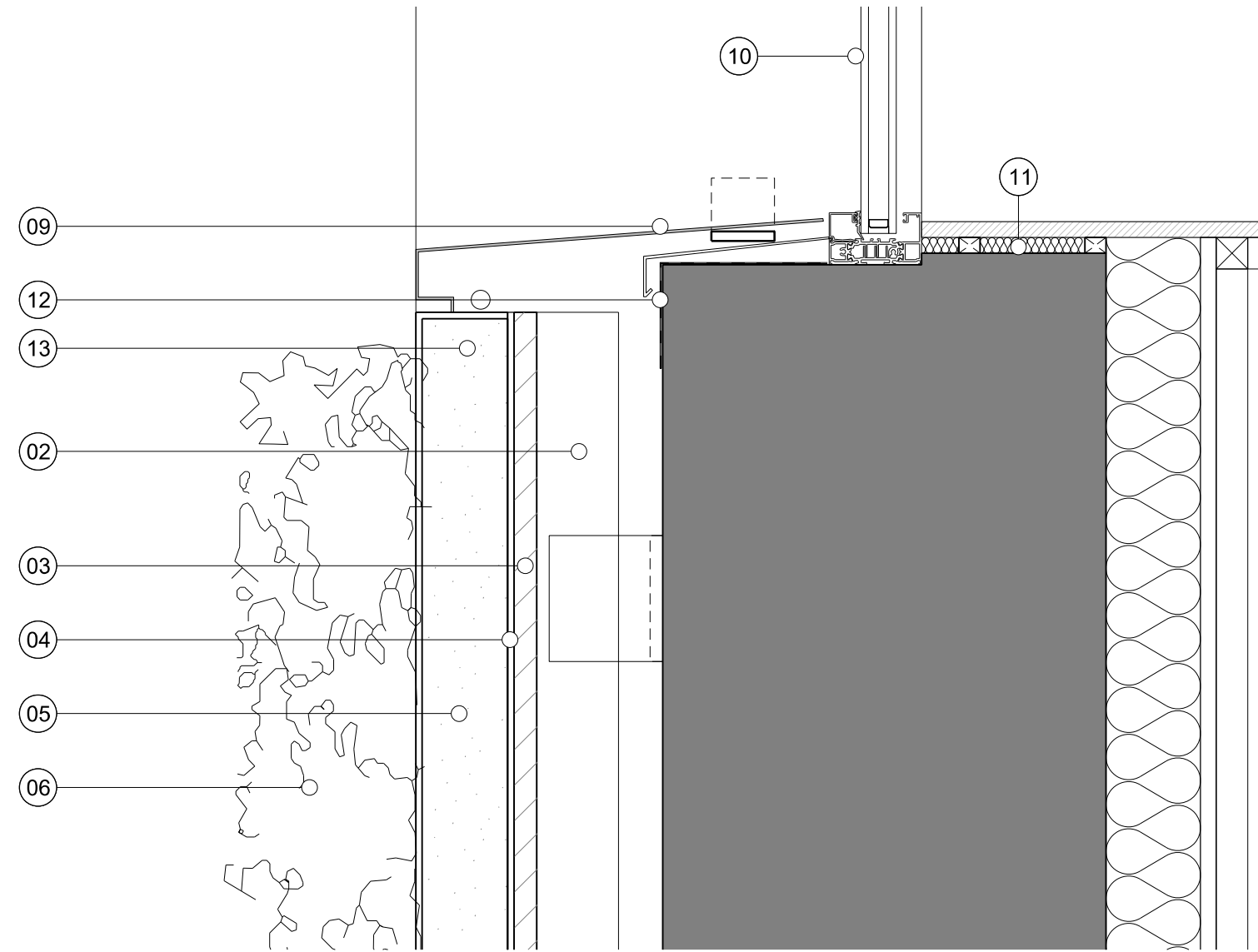

2 Proposed cill detail through front elevation  
DETAILED SECTION A - A - 1:5

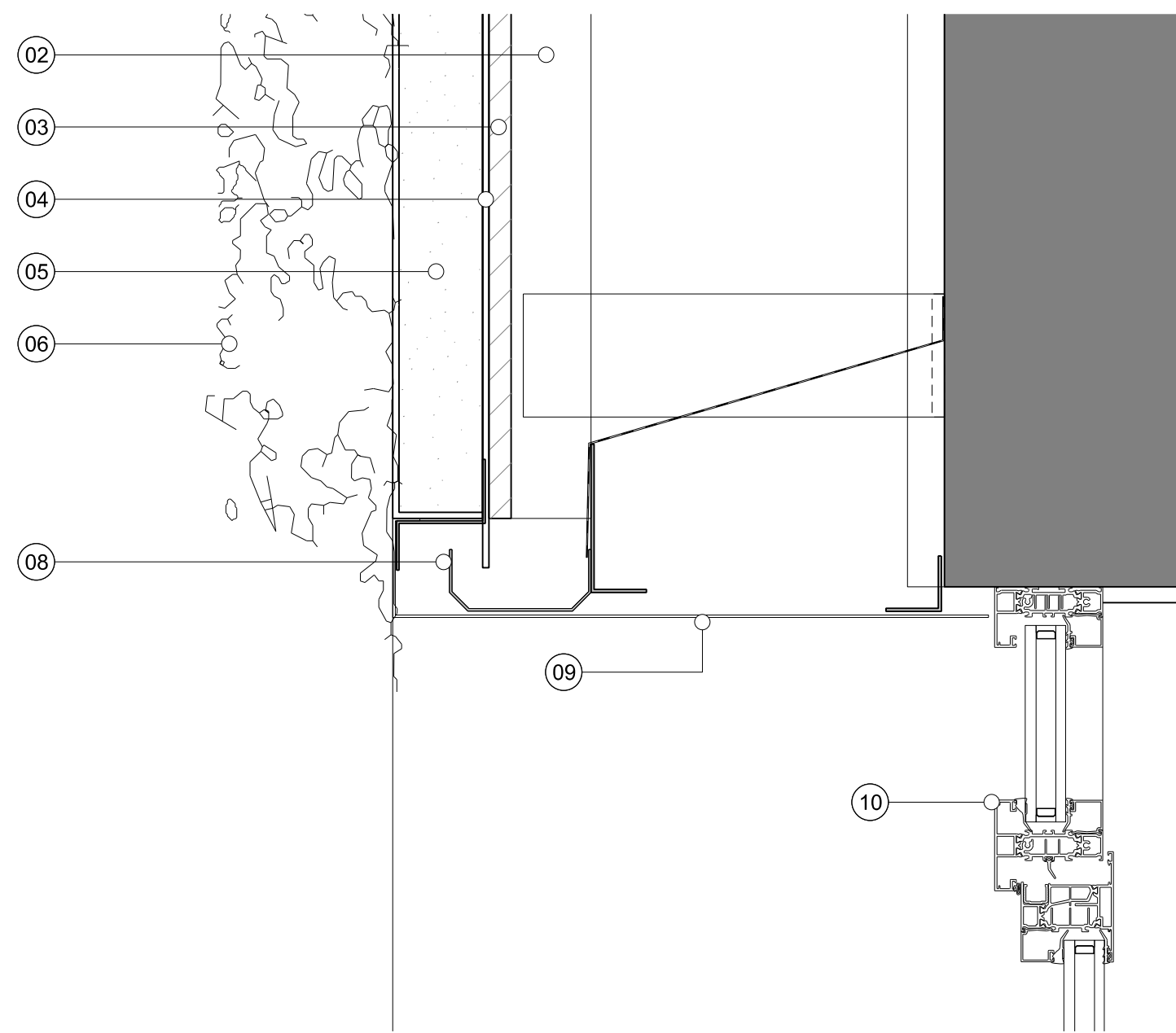

3 Proposed head detail through front elevation  
DETAILED SECTION A - A - 1:5

Notes  
© David Morley Architects  
Do not scale off drawings  
Check all dimensions on site and advise any discrepancies  
before commencing work.  
All dimensions in millimetres unless otherwise noted.

Legend:

- 01 Existing Masonry
- 02 Living Wall support structure
- 03 18mm Ecoboard
- 04 4mm Geotextile void former
- 05 Living Wall Panel
- 06 Living Wall Planting
- 07 Flexible polyurethane foam sealant strip
- 08 Pressed Aluminium Gutter
- 09 PPC Aluminium Flashing - RAL 7012 to match windows
- 10 Inward opening double glazed aluminium window
- 11 Window board
- 12 EPDM
- 13 Drip line
- 14 Clip off flashing to hide neighbouring properties cables
- 15 Assumed party wall line

Note:

Refer to Structural Engineers drawings for details of the living wall carrier strategy.

Refer to Biotope drawings for details of the planting tiles, drainage and irrigation strategy

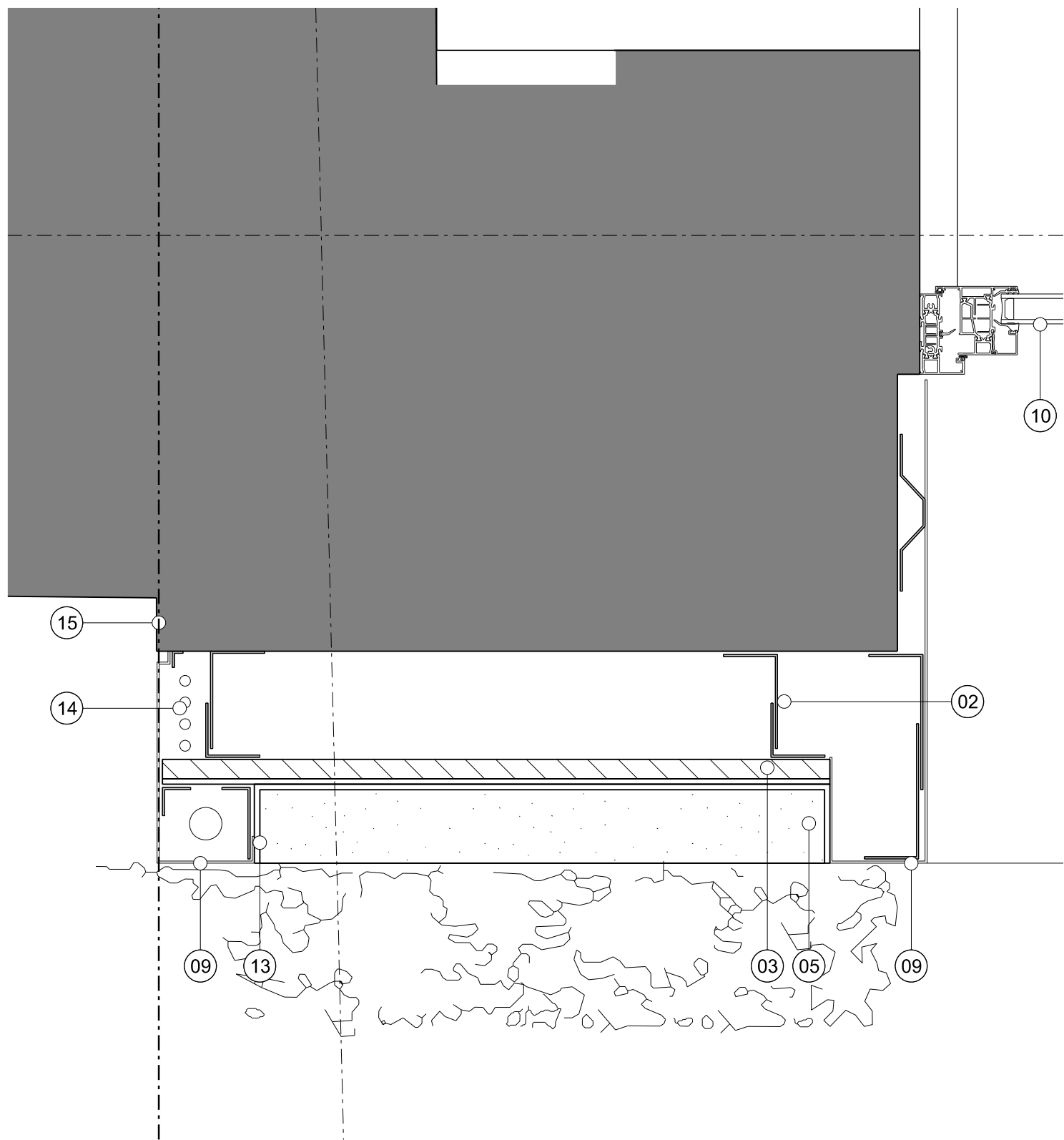

4 Proposed plan through front elevation  
PLAN - 1:5

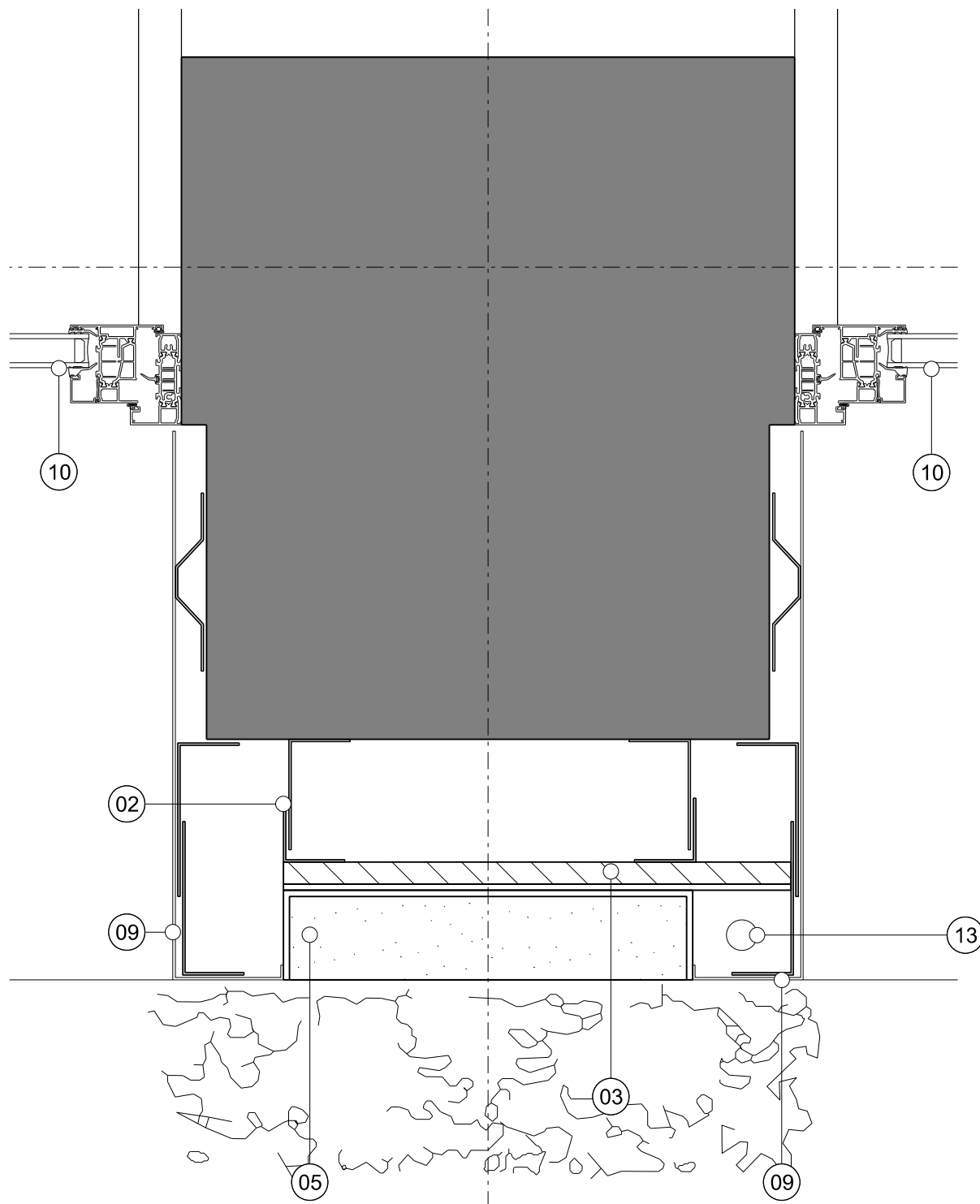

5 Proposed plan through front elevation  
PLAN - 1:5

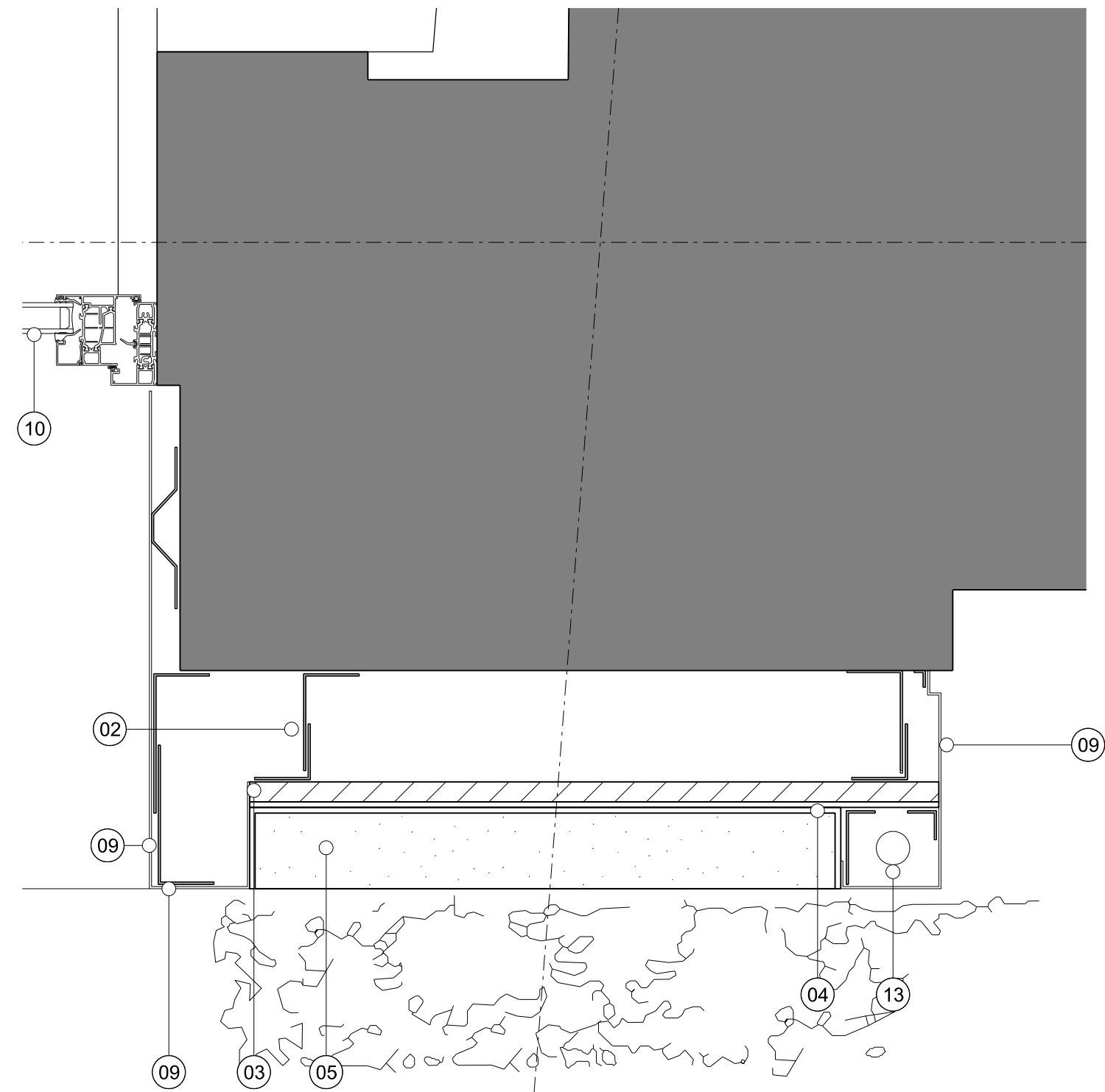

6 Proposed plan through front elevation  
PLAN - 1:5

0 0.25m

Rev.	Description	06/05/14
7	Planning Application Issue	15/12/15
A	Updated for Planning Issue	
DAVID MORLEY ARCHITECTS		
18 Hutton Place London EC1N 8RU		
Tel: 020 7430 2444 Fax: 020 7430 2443		
davidmorleyarchitects.co.uk		
Client		
Panatura Properties A Ltd		
Project		
Synergy House		
Drawing		
Details - Junctions and Windows		
Job No.	Drawing No.	Revision
568	10-001	A
Date of First Issue	Scale @ A1	Revision Date
06/05/2014	1:5	15/12/15

© David Morley Architects  
Do not scale off drawing.  
Check all dimensions on site and advise any discrepancies before commencing work.  
All dimensions in millimetres unless otherwise noted.

Note:  
Refer to Structural Engineers drawings for details of the living wall carrier strategy.  
Refer to Biotechture drawings for details of the planting tiles, drainage and irrigation strategy

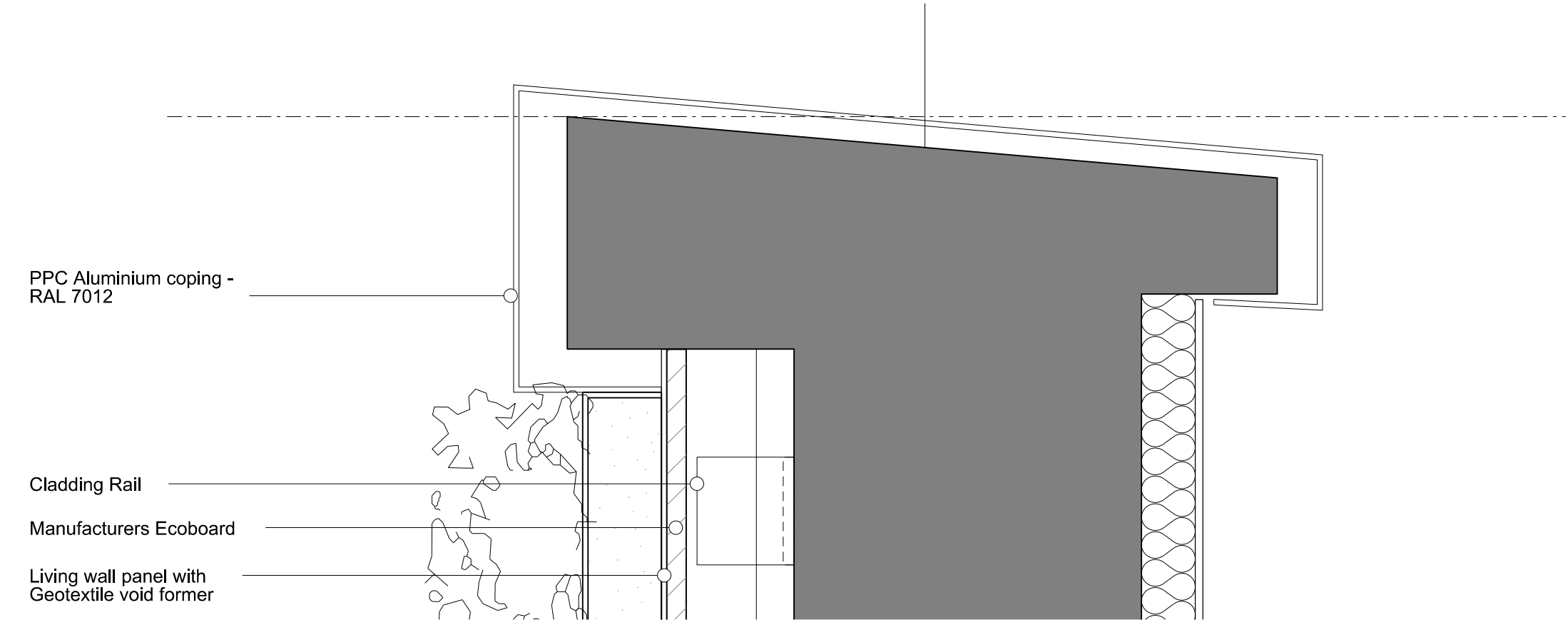

1 Living Wall Head Detail  
DETAILED SECTION @ 1:5

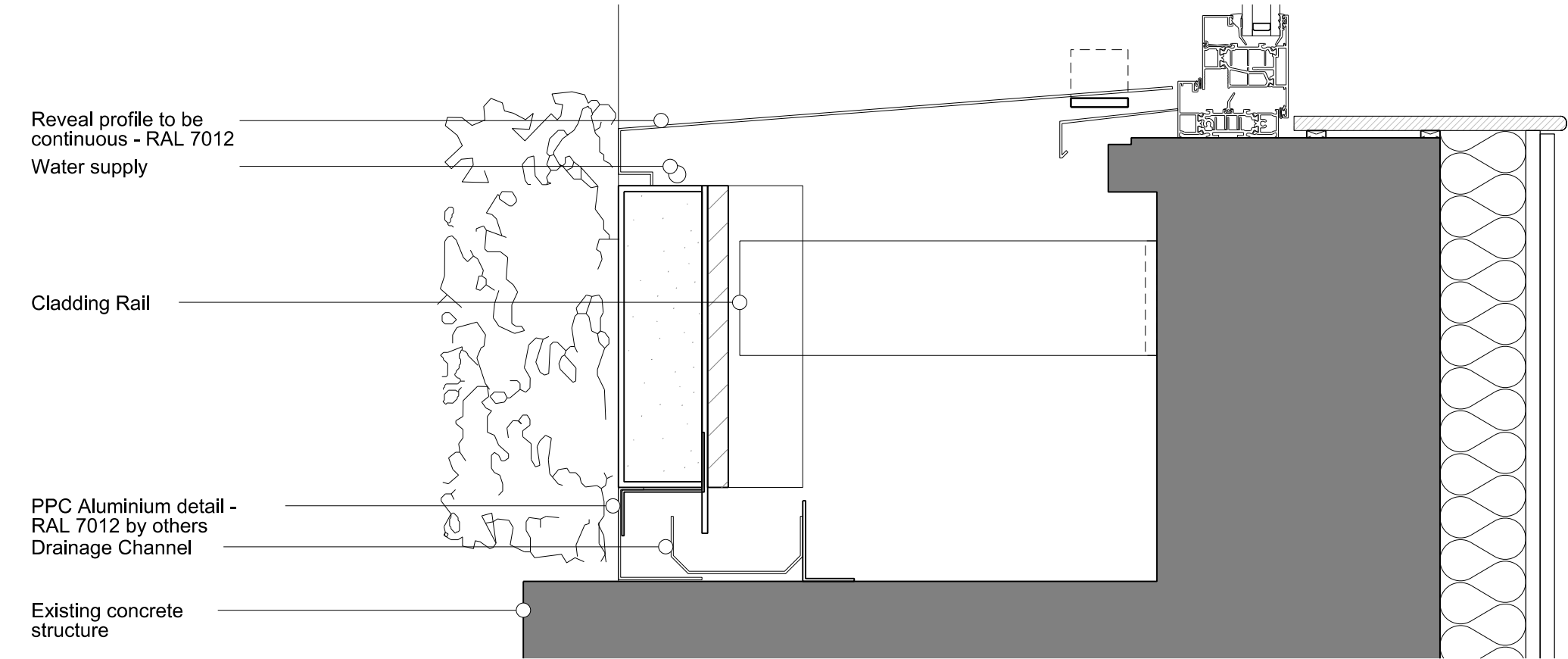

2 Living Wall Base Detail  
DETAILED SECTION @ 1:5

First Issue		15/12/15
Rev.	Description	Date
DAVID MORLEY ARCHITECTS		
18 Hatton Place London EC1N 8RU		
Tel: 020 7430 2444 Fax: 020 7430 2443		
davidmorleyarchitects.co.uk		
Client		
Panatura Properties A Ltd		 SYNERGY HOUSE
Project		
Synergy House		
Drawing		
Living Wall Head and Base Details		
Job No.	Drawing No.	Revision
568	10-002	First Issue
Date of First Issue	Scale @ A3	Revision Date
15/12/15	1:5	-





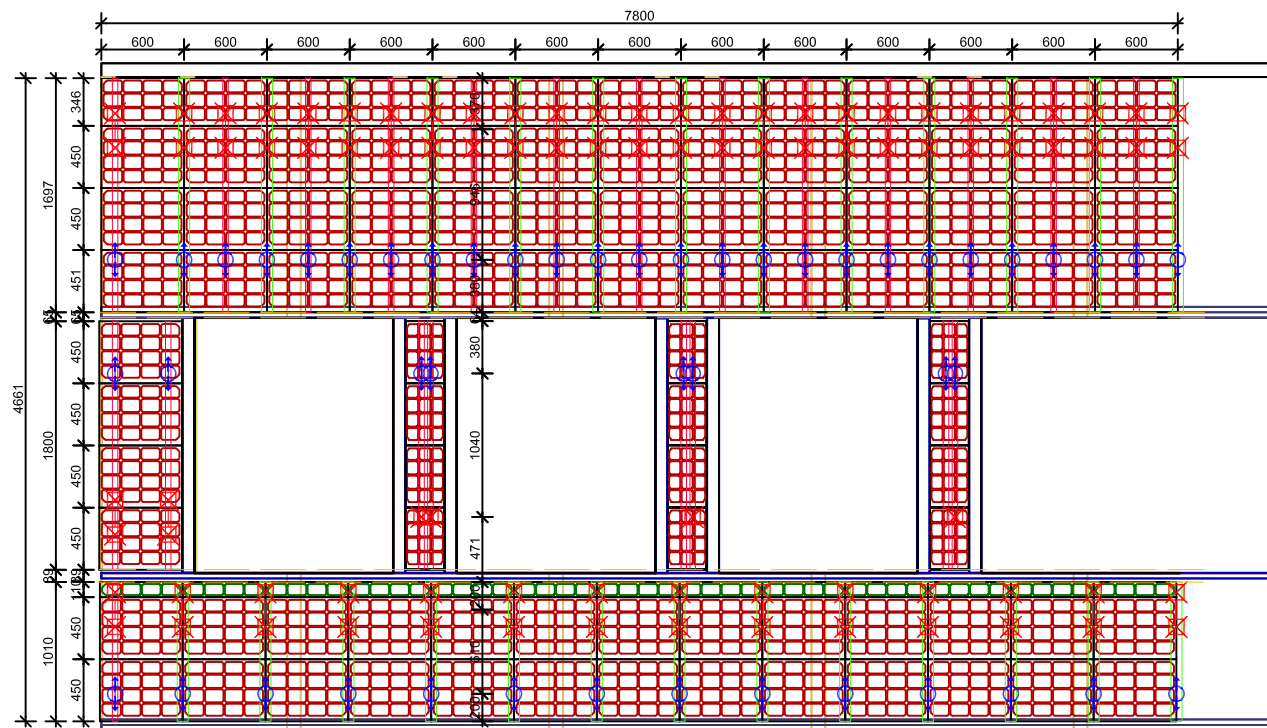



# Mounting scheme for Project: Synergy House

## Customer: Biotechure



### MFT-MFI - MacFOX

#### EXPLANATION/LEGENDE:

-  MFT-MFI 185 M 11 (flexible point/Gleitpunkt)  
fastening in elongated holes/Verschraubung in Langlöchern
-  MFT-MFI 185 M 11 (fix point/Fixpunkt)  
fastening in round holes/Verschraubung in Rundlöchern
-  MFT-MFI 185 double/Doppel M 11 (fix point/Fixpunkt)  
fastening in round holes/Verschraubung in Rundlöchern
-  Profile/ Profil MFT-L 60x40 1,8 vertical/vertikal
-  Profile/ Profil MFT-T 60x100 1,8 vertical/vertikal
-  Profile joint /Profilstoß
-  constructive edge/Konstruktive Kante
-  S-AD 01 S(SS) 5,5x19  
Screw for fixing the profiles to the bracket - 1st layer  
Schraube zur Befestigung der Profile mit dem Distanzhalter 1.Lage

-  HRD-H 10x80  
Base fastener/Untergrundbefestiger

#### Base of Calculation:

Facade- System: MTA-v-100	Elements of cladding: Biotechure	Producer of facade elements: n/a	Base Material: solid brick
Isolation: 150mm	Wall distance to the Profile : 185-225mm	Fastening of the facade elements: rivets/screws	Editor : Dario Kalcic 25.11.2015

The mounting guidelines from producers should be followed for all facade elements and fixings!  
Technical modifications are subject to change.



Indicative Photomontage



Architectural drawing extracted from David Morley Architects drawing  
'Proposed Front Elevation 568 1-010 Draft'

Plants: Indicative Images



Armeria maritima



Euonymus fortunei 'Dart's Blanket'



Hedera helix 'Green Wonder'



Heuchera 'Green Spice'



Liriope 'Monroe White'



Pachysandra terminalis 'Green Carpet'



Pachysandra terminalis 'Variegata'



Polypodium vulgare



Sarcococca humilis



Vinca minor 'Bowles Purple'



Vinca minor 'Gertrude Jekyll'

Notes:

Plants subject to availability. Plant images specified here are indicative and for the purpose of graphic information. Dimensions and site survey information were provided by Biotecture Ltd.  
Appropriate care should be taken when handling any plant material. Contractors are not to scale dimensions from this drawing.

Green Graphite  
Landscape Design

14 Smith Close  
London  
SE16 5PB  
T: +44(0)20 7231 5344  
E: info@GreenGraphite.com  
www.GreenGraphite.com



Client  
**Biotecture Ltd**

Project  
**Panatura Properties / Synergy House**

Description  
**Living Wall Design - Exterior  
Indicative Photomontage and  
Planting Design Strategy**

Status  
For Information

Scale	Drawn	Date
NTS	SM	15.12.15
Client Ref	Job number	Drawing number
021B	624-41	L102



Planting Plan

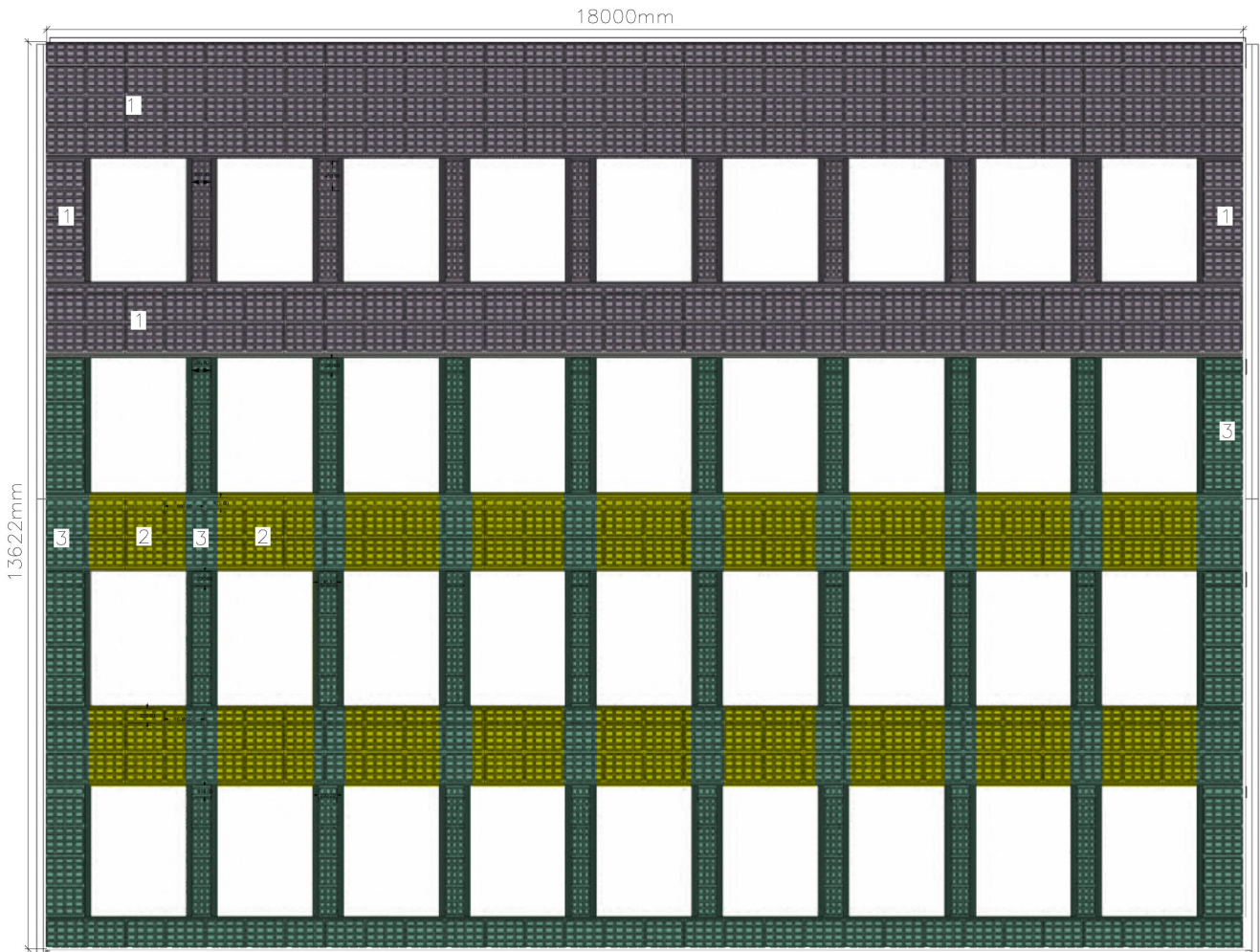

Plants: Indicative Images



Armeria maritima



Euonymus fortunei 'Dart's Blanket'



Hedera helix 'Green Wonder'



Heuchera 'Green Spice'



Liriope 'Monroe White'



Pachysandra terminalis 'Green Carpet'



Pachysandra terminalis 'Variegata'



Polypodium vulgare



Sarcococca humilis



Vinca minor 'Bowles Purple'



Vinca minor 'Gertrude Jekyll'

Notes:

Plants subject to availability. Plant images specified here are indicative and for the purpose of graphic information. Dimensions and site survey information were provided by Biotecture Ltd. See Biotecture's drawing '0218 Synergy House Panel Layout'. Appropriate care should be taken when handling any plant material. Contractors are not to scale dimensions from this drawing.

Planting Design Intention

The design accentuates the geometry of the building facade of horizontal bands between the floors and vertical stripes between the windows to soften the building frontage and display a fresh facade.

The matrix of plants is mainly of green tones throughout the wall, with the top floor accented with mauve blossoms and the remaining floor levels with white blossoms for year round interest.

Plants were also chosen to suit site conditions being fairly sheltered, with a west-facing aspect providing full sun to partial shade. All plants are fully hardy and evergreen to ensure no bare patches in winter months.

Planting Area	Area m2	Plant Name	%	Quantity (60 plants/ m2)	Notes
1	54.6	Armeria maritima	15	491	In groups of 3-5 randomly planted.
		Euonymus fortunei 'Dart's Blanket'	20	655	In groups of 2-3 randomly planted.
		Hedera helix 'Green Wonder'	10	328	In groups of 1-2 randomly dotted throughout.
		Heuchera 'Green Spice'	15	491	In groups of 3-5 randomly planted.
		Pachysandra terminalis 'Green Carpet'	15	491	In groups of 1-2 randomly dotted throughout.
		Polypodium vulgare	15	491	In groups of 2-3 randomly planted.
		Vinca minor 'Bowles Purple'	10	328	In groups of 2-3 randomly planted.
2	37.25	Euonymus fortunei 'Dart's Blanket'	20	447	In groups of 3-5 randomly planted.
		Hedera helix 'Green Wonder'	10	224	In groups of 2-3 randomly planted.
		Liriope 'Monroe White'	15	335	In groups of 3-5 randomly planted.
		Pachysandra terminalis 'Variegata'	15	335	In groups of 3-5 randomly planted.
		Polypodium vulgare	15	335	In groups of 1-2 randomly dotted throughout.
		Sarcococca humilis	15	335	In groups of 3-5 randomly planted.
		Vinca minor 'Gertrude Jekyll'	10	224	In groups of 2-3 randomly planted.
3	30.35	Euonymus fortunei 'Dart's Blanket'	30	546	In groups of 2-3 randomly planted.
		Hedera helix 'Green Wonder'	20	364	In groups of 2-3 randomly planted.
		Pachysandra terminalis 'Green Carpet'	25	455	In groups of 2-3 randomly planted.
		Polypodium vulgare	25	455	In groups of 1-2 randomly dotted throughout.
Total Area	122.2	Total Plants		7332	

D Revised plant list	8.12.15
C reverted to 'option 1 layout'	2.12.15
B revised plant list and calculations	20.11.15
A revised graphics to include 'special panels'	20.11.15
REVISIONS	

Green Graphite Landscape Design

14 Smith Close  
London  
SE16 5PB  
T: +44(0)20 7231 5344  
E: info@GreenGraphite.com  
www.GreenGraphite.com

Client  
Biotecture Ltd  
Project  
Panatura Properties / Synergy House  
Description  
Living Wall Design - Exterior  
Planting Plan

Status  
For Planning  
Scale  
1: 75@A3  
Client Ref  
0218  
Drawn  
SM  
Job number  
624-41  
Date  
20.11.15  
Revision  
L300 D