

02048902 NO. 11 Section of Blemundsbury Houses cycle store

02048902 NO. 12 Section of Blemundsbury Houses cycle store

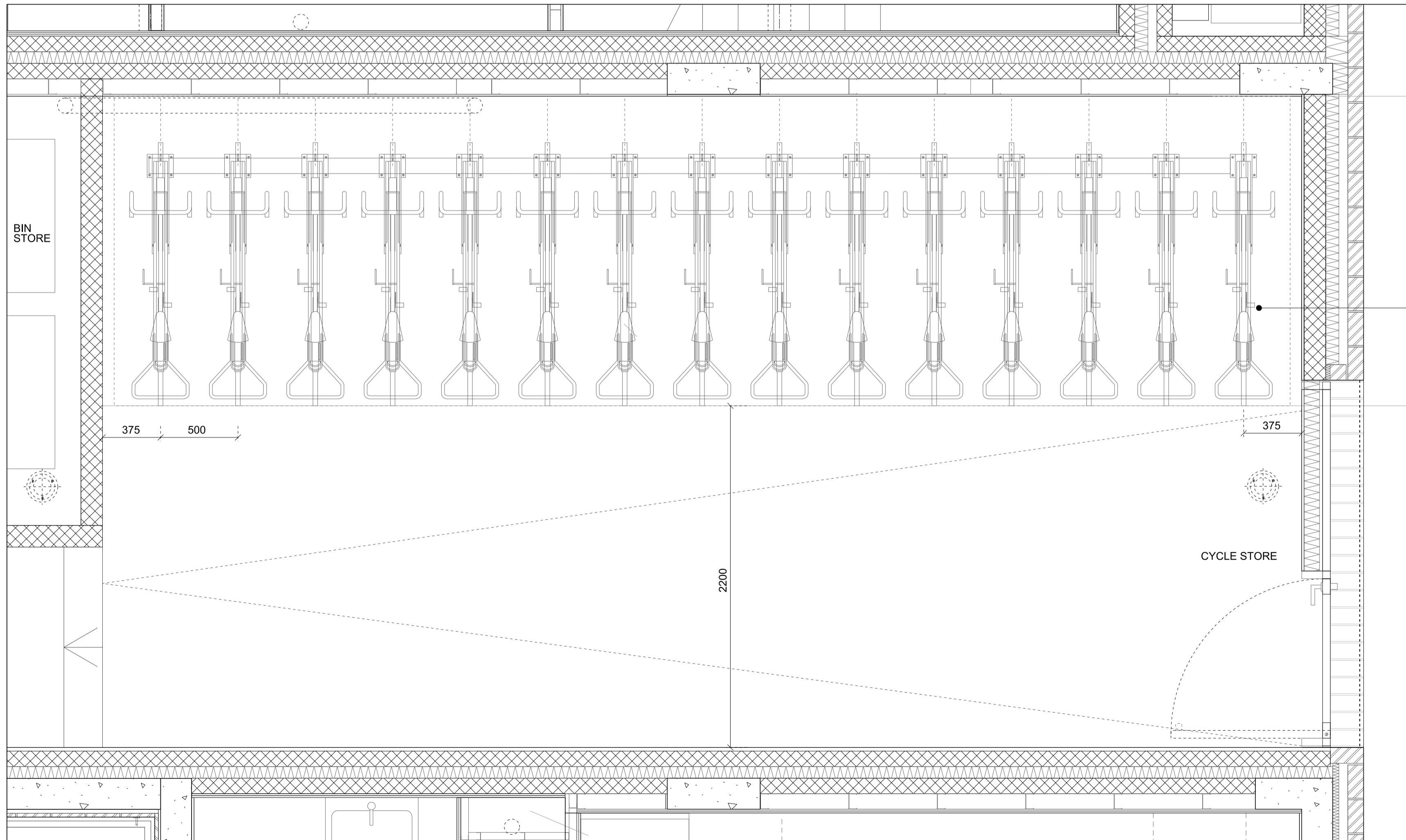

'Josta' 2 tier bike stand
 30 space provision
 29 space requirement
 Mews BK x 3
 Mews Houses x 20
 Mews Booked x 6
 500 mm c/c
 Min 1700mm activity to front of stand

02048902 NO. 13 Plan of Blemundsbury Houses cycle store

revision	date	amendment

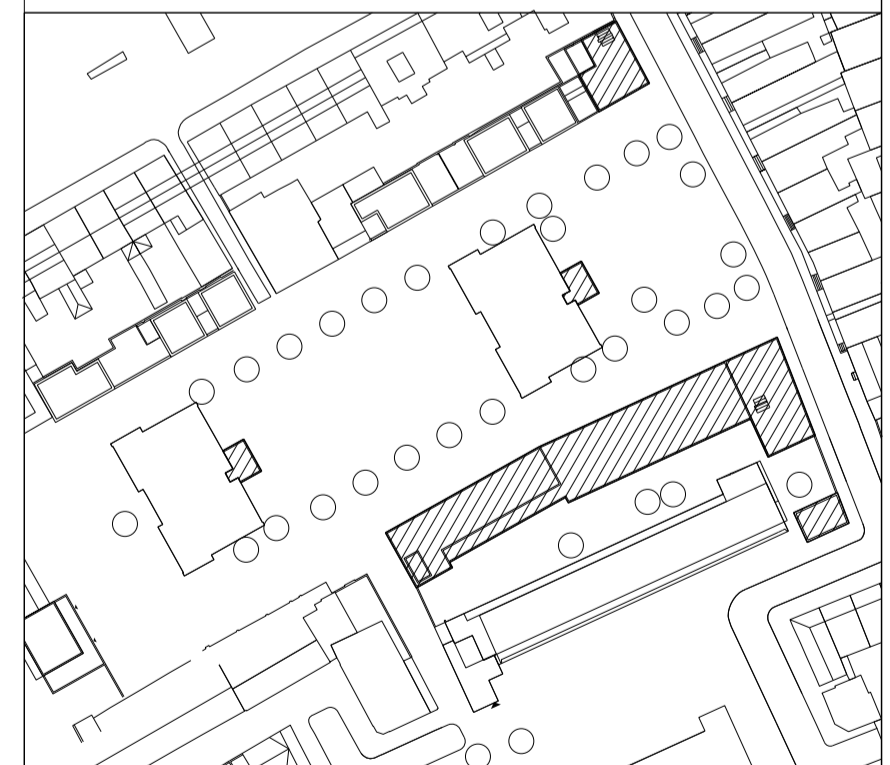

DUGGAN MORRIS ARCHITECTS
 Duggan Morris Architects Ltd
 Unit 7, 16-24 Underwood street, London, N1 7JQ
 Telephone 020 7566 7440
 www.dugganmorrisarchitects.com

- Do not scale from this drawing
- All dimensions to be checked on site by the Contractor
- And such dimensions to be their responsibility
- Report all drawing errors and omissions to the Architect
- All dimensions in millimeters unless noted otherwise
- If in doubt ask Contract Administrator

job title
 TYBALDS ESTATE REGENERATION

drawing title/location
 CYCLE STORE (BLEMUNDSBURY HOUSES)

status	PLANNING				
scale	1:10 @ A1		1:20 @ A3		
job no	source	zone	element	drawing no.	revision
A186	A	Z2	(44)	445	