

NOTES

- DO NOT SCALE THIS DRAWING.
- THIS DRAWING IS TO BE READ IN CONJUNCTION WITH ALL OTHER RELEVANT ENGINEER'S AND ARCHITECT'S DRAWINGS AND SPECIFICATIONS.
- DO NOT SCALE FROM THIS DRAWING. USE FIGURED DIMENSIONS ONLY.
- ALL DIMENSIONS TO BE CONFIRMED BY THE ARCHITECT PRIOR TO CONSTRUCTION.
- FOR SITE SETTING OUT REFER TO THE ARCHITECT'S DRAWINGS.
- FOR MATERIAL NOTES REFER TO DRAWING GEN.01



STAGE 1

- REFER ALSO TO AB1115_SEQ_0004

STAGE 1 DEMOLISH EXISTING SOUTH GABLE END OF THE BUILDING AND REAR SUPERSTRUCTURE OF MAIN BLOCK
 SOFT STRIP OF EXISTING BUILDING INCLUDING REMOVING ALL WINDOWS AND DOORS
 MAKE ALTERATIONS TO THE UPPER FLOORS AND ROOF
 PROVIDE TEMPORARY PROPPING TO REMAINING SUPERSTRUCTURE AS REQUIRED. 

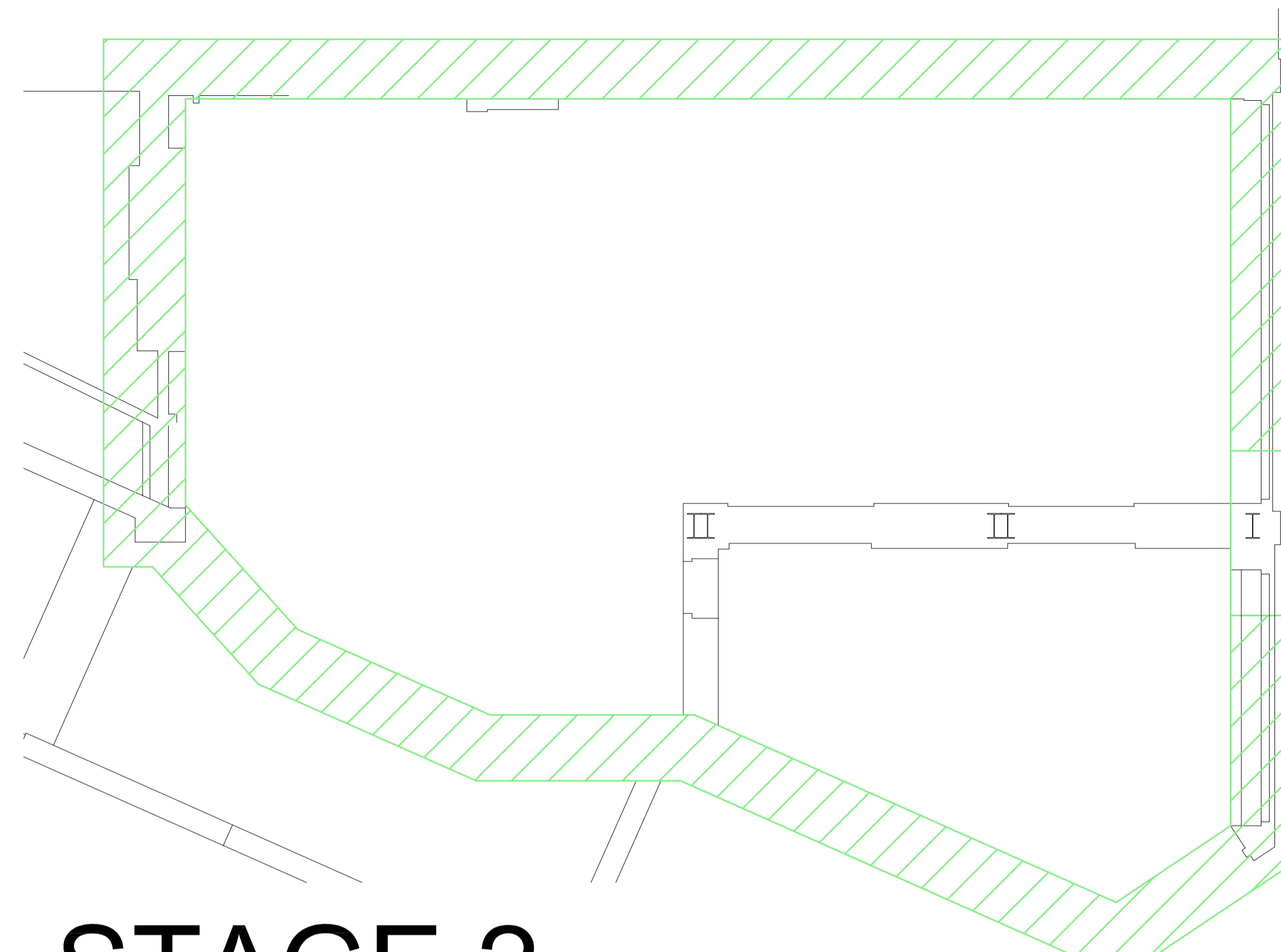

STAGE 2

- REFER ALSO TO AB1115_SEQ_0004 & AB1115_SEQ_0005

STAGE 2 CARRY OUT MASS CONCRETE UNDERPINNING BELOW THE NORTH PARTY WALL AND TO THE FRONT AND REAR ELEVATION WALLS IN ORDER TO EXTEND THE FOUNDING LEVEL OF THESE EXISTING WALLS TO BELOW THE NEW BASEMENT SLAB LEVEL. EACH PIN TO BE EXCAVATED, CAST THEN BACKFILLED IN MAX 1m STRIPS

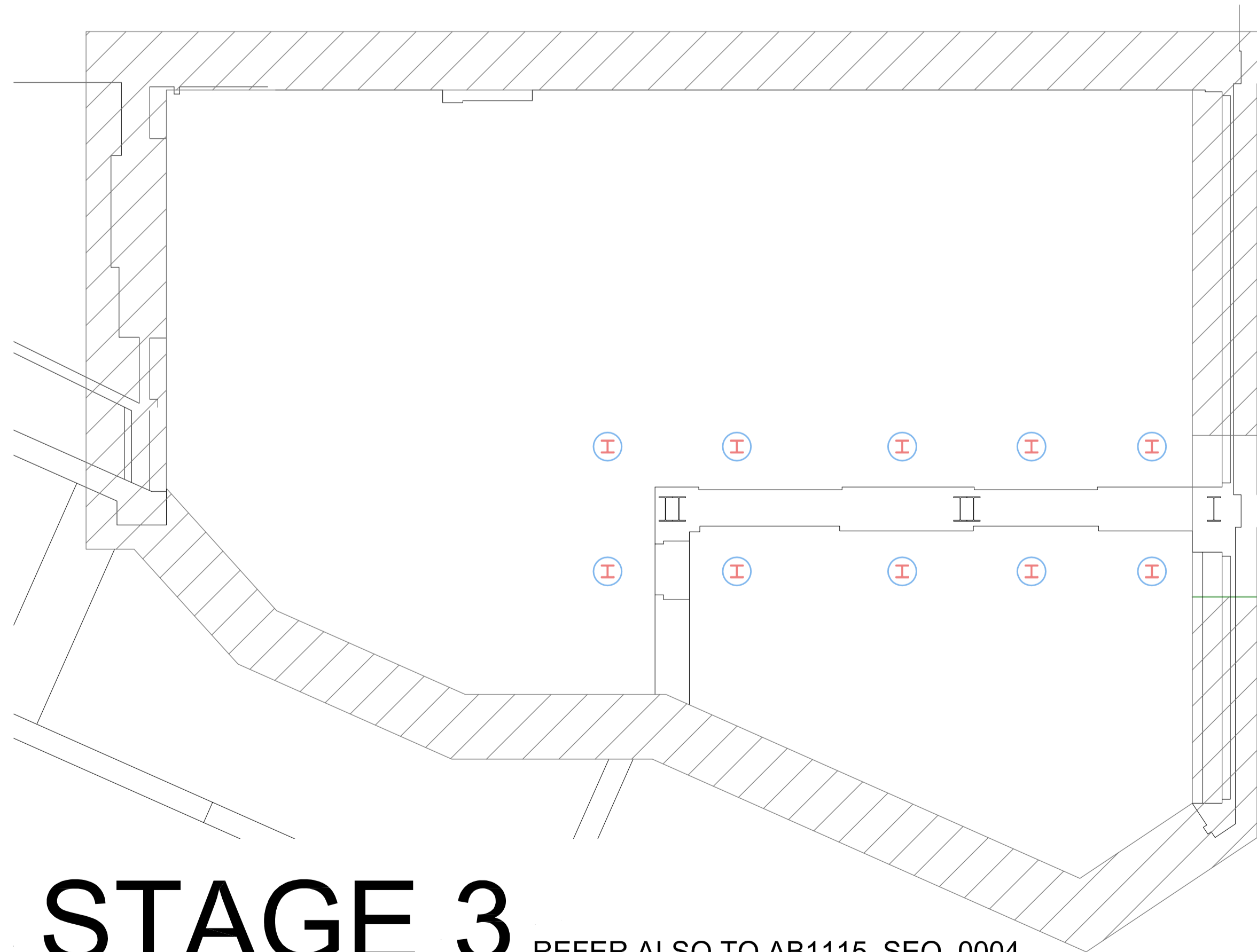

STAGE 3

- REFER ALSO TO AB1115_SEQ_0004

STAGE 3 INSTALL NEW SACRIFICIAL TEMPORARY FOOTINGS FOR TEMPORARY VERTICAL PROPPING
 INSTALL TEMPORARY VERTICAL PROPPING OF SUPERSTRUCTURE OVER. 

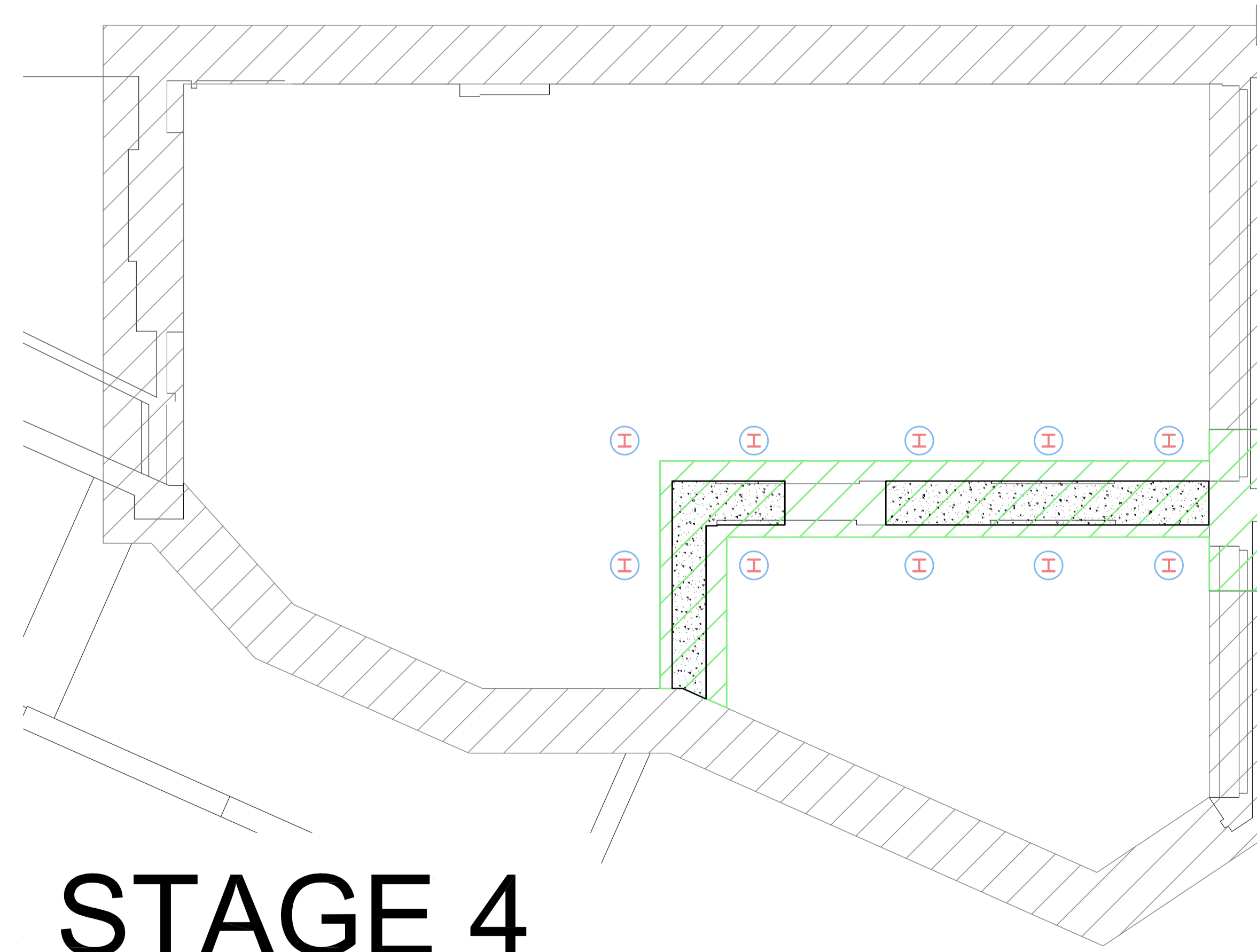

STAGE 4

STAGE 4 REMOVE EXISTING INTERNAL COLUMN FOOTINGS, 'SPINE WALL' FOOTINGS AND FRONT COLUMN FOOTING.
 CONSTRUCT NEW PERMANENT FOOTINGS TO BE FORMED AT THE NEW BASEMENT LEVEL VIA UNDERPINNING METHOD.
 LOCALISED CONSTRUCTION OF NEW RC WALLS WITHIN THE BASEMENT TO RE-SUPPORT THE COLUMNS AND SPINE WALL OVER.

CDM REGULATIONS 2015 RESIDUAL HAZARDS

RESIDUAL HAZARDS IDENTIFIED 

- TEMPORARY WORKS BY MAIN CONTRACTOR - METHOD STATEMENT REQUIRED.

THIS REGISTER IS A NON-EXHAUSTIVE LIST OF RESIDUAL HAZARDS RELATING TO THE WORKS SHOWN ON THIS DRAWING THAT HAVE BEEN IDENTIFIED DURING THE DESIGN STAGE.

Mark	Date	By	Chkd.	Revision notes
B	16/11/15	PO	HJ	NOTES ADDED
A	15/06/15	AB	APB	NOTES ADDED
-	17/03/15	PO	APB	PRELIMINARY ISSUE

abstract
 consulting engineers
 Lime Tree House, 15 Lime Tree Walk, Sevenoaks TN13 1YH
 LONDON + SEVENOAKS Tel: 03330 113 401 info@abstract-llp.com

Job Title
4No NEW RESIDENTIAL UNITS
 465-467 FINCHLEY ROAD
 NW3 6HS

Drawing Title
BASEMENT CONSTRUCTION
 SEQUENCE:
 STAGES 1 - 4

Client
A.GOVANI

Scale at A1:
1:50

Drawn:
 PO
 Date:
 March 2015

Checked:
 APB
 Date:
 17/03/2015

Drawing No.:
AB1115_SEQ_0001

Revision:
B

PRELIMINARY ISSUE