

© Lees Munday Ltd

Figured dimensions only are to be taken from this drawing. All dimensions are to be checked on site before any work is put in hand.

KEY:

- Application boundary
- Adjacent ownership boundary

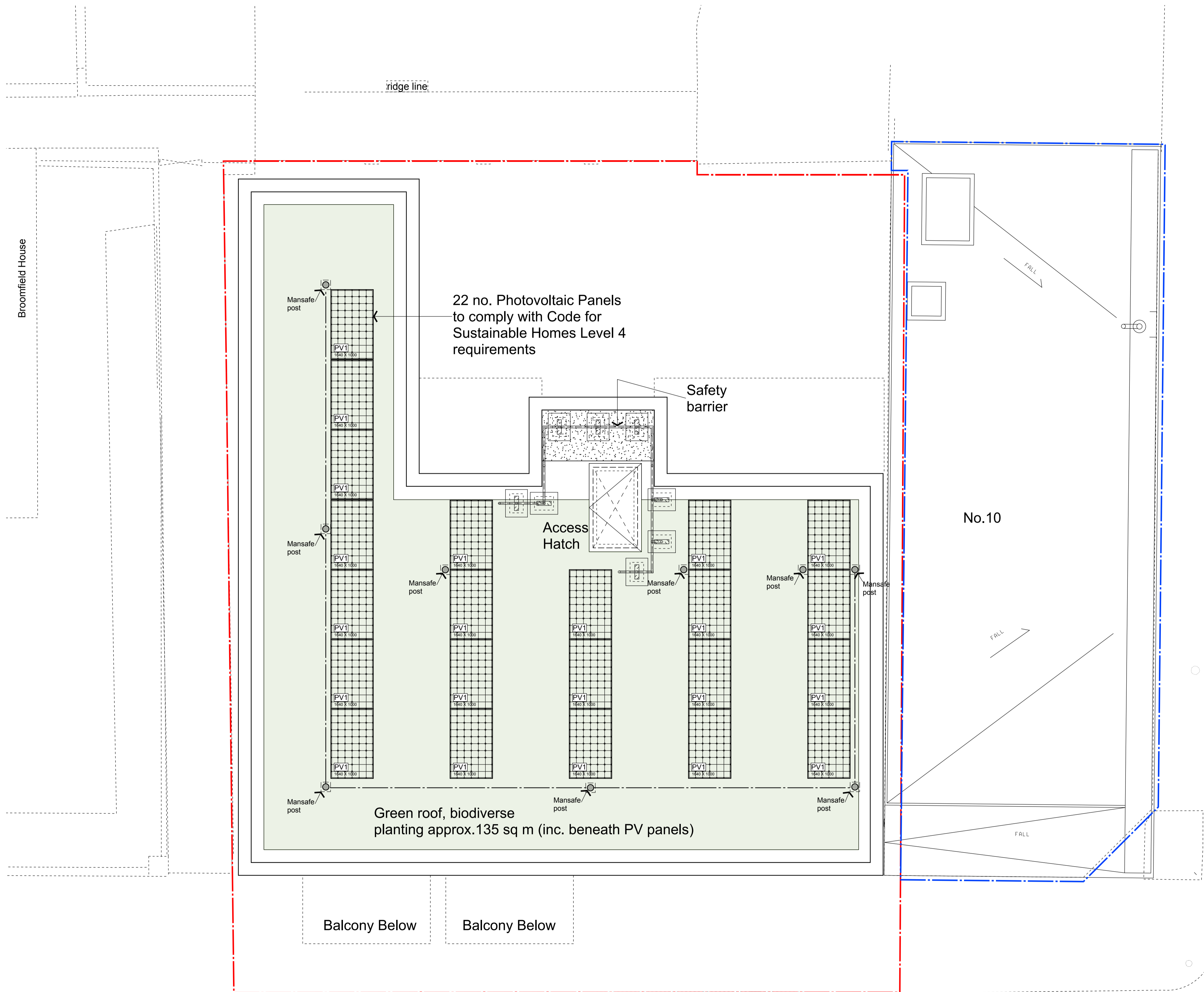

22 no. Photovoltaic Panels to comply with Code for Sustainable Homes Level 4 requirements

Safety barrier

Access Hatch

No.10

Green roof, biodiverse planting approx. 135 sq m (inc. beneath PV panels)

Balcony Below

Balcony Below

Positions and numbers of PV panels revised for TP Condition 11 submission and to comply with Code for Sustainable Homes Level 4. Safety barrier adjusted to suit litchway system.

07	4. Safety barrier adjusted to suit litchway system.	YM	11Jan16	DL
06	General update. Greeb roof area noted.	YM	16Sep14	DL
05	Boundary extent revised and PV's added	SH	18Dec13	DL
04	Issued for Town Planning	SH	25Nov13	DL
03	Green Roof added	SH	22Nov13	DL
01	Issued to Rights of Light Specialist	SH	15Nov13	DL
00	Issued for Pre-app	SH	03Oct13	DL

Mark Revision Date Checked

lees munday • architects

Netley House
 Shere Road
 Gomshall
 Guildford
 Surrey GU5 9QA
 01483 331945 / 07795 158754 / 07946 203056
 mail@leesmunday.com

Client's name
Optic Realm

Job title
Ferdinand Street

Drawing title
**Plan Level 04
Roof Plan**

Scale
1 : 50 @ A1, 1 : 100 @ A3

Drawn	Checked	Date
YM	DL	09May13

Job No	Drawing No	Rev
13-011	412-105	07

Status
TP SUBMISSION