





-  Main Entrance
-  Entrance Security Buzzer (door power assist button)
-  Rainwater Pipes
-  Indicative Level (+0.150)  
(note-levels use lobby as datum +0.00)
-  Aluminium framed secondary glazing
- 1** Widened opening
- 2** Timber parquet flooring
- 3** Timber reception desk enclosure with sliding glazed panels
- 4** Tea point
- 5** Storage
- 6** Door replaced with timber framed glazed panel
- 7** Existing door undercut to allow for change in floor finishes (approx 20mm). Threshold strip at door to match parquet flooring.
- 8** New partitions - floor to ceiling

**NOTE**  
Hatched area indicates where Planning and Listed Building Consent has been previously granted. Refer to **2015/0684/P** and **2015/0997/L**.

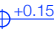

**mountain**  
3 Greenland Place  
Camden Town London NW1 0AP  
07967 111 660

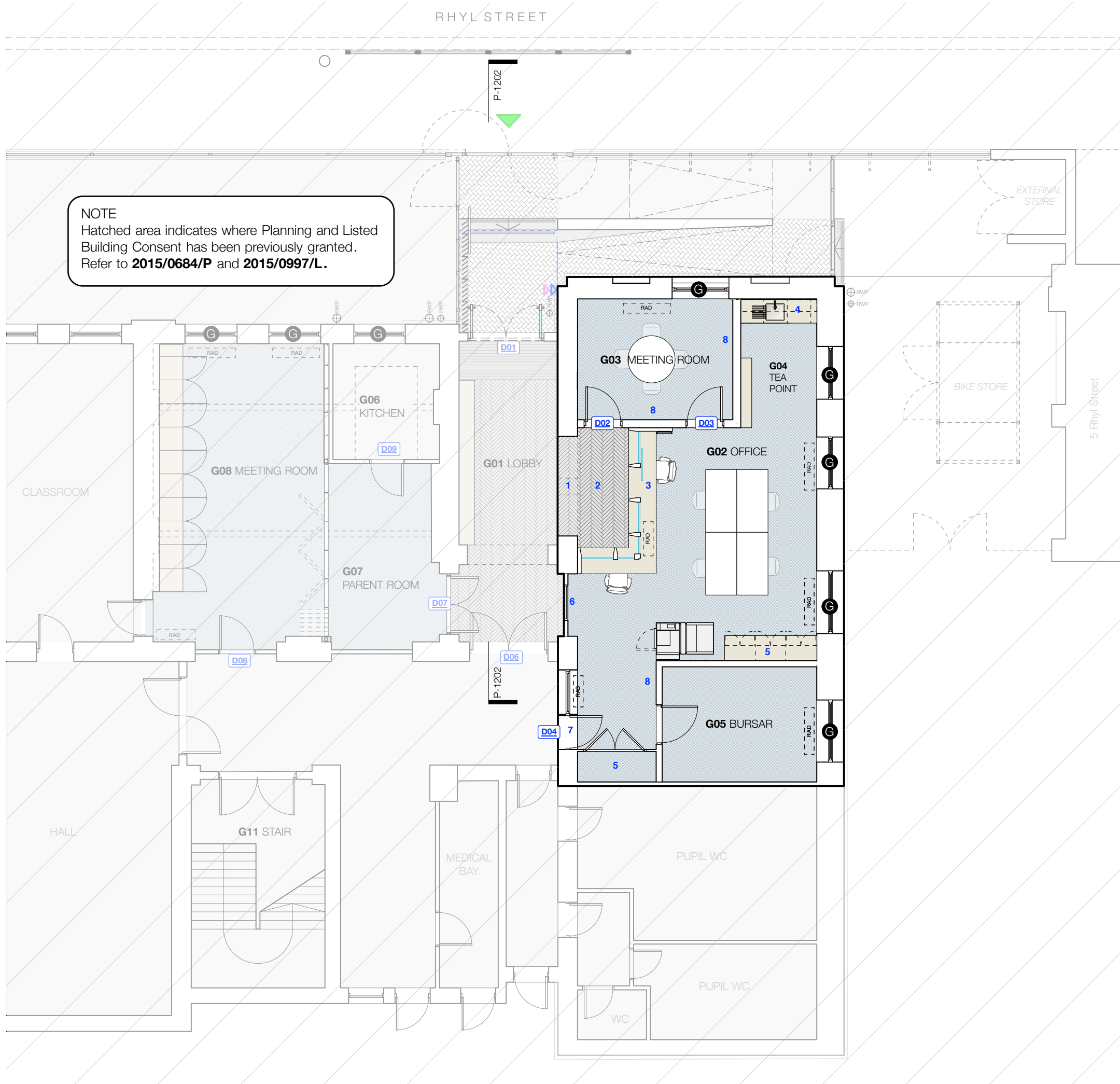

Rhyll Primary School  
Job  
For Planning Approval  
status

All dimensions to be checked on site  
Levels are not co-ordinated to Ordnance Survey standards and are indicated for guidance using the lobby floor as a datum +0.00

**notes**

rev 13.01.16 planning issue

GA Ground Floor Plan  
Proposed  
**title**

1403A\_P\_1102  
**drawing number**

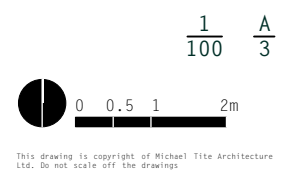

1/100 A/3