

▼ Main Entrance

⊕+0.150 Indicative Level
(note-levels use lobby as datum +0.00)

Demolition/removal of fixed installations/partitions/doors

Void formed in existing slab (The existing slab is anticipated to be between 100-150mm thick - a section of which will be locally cut out and recast at a minimum of 150mm thick, allowing for the 75mm trench above.)

- 1 Reception desk widened
- 2 Door removed (surround retained)
- 3 Tea point removed

GENERALLY -

- All floor coverings removed. Floors made level where necessary with latex screed)
- Blinds removed throughout
- All lighting to be replaced where possible
- Partitions, lay-in grid suspended ceilings, doors and FF+E removed in offices, G02, G03, G04 and adjacent corridor.
- Where services are mounted on removed partitions, services are to be relocated.
- Fixed furniture in G05 Bursars office to be retained as current

NOTE
Hatched area indicates where Planning and Listed Building Consent has been previously granted.
Refer to **2015/0684/P** and **2015/0997/L**.

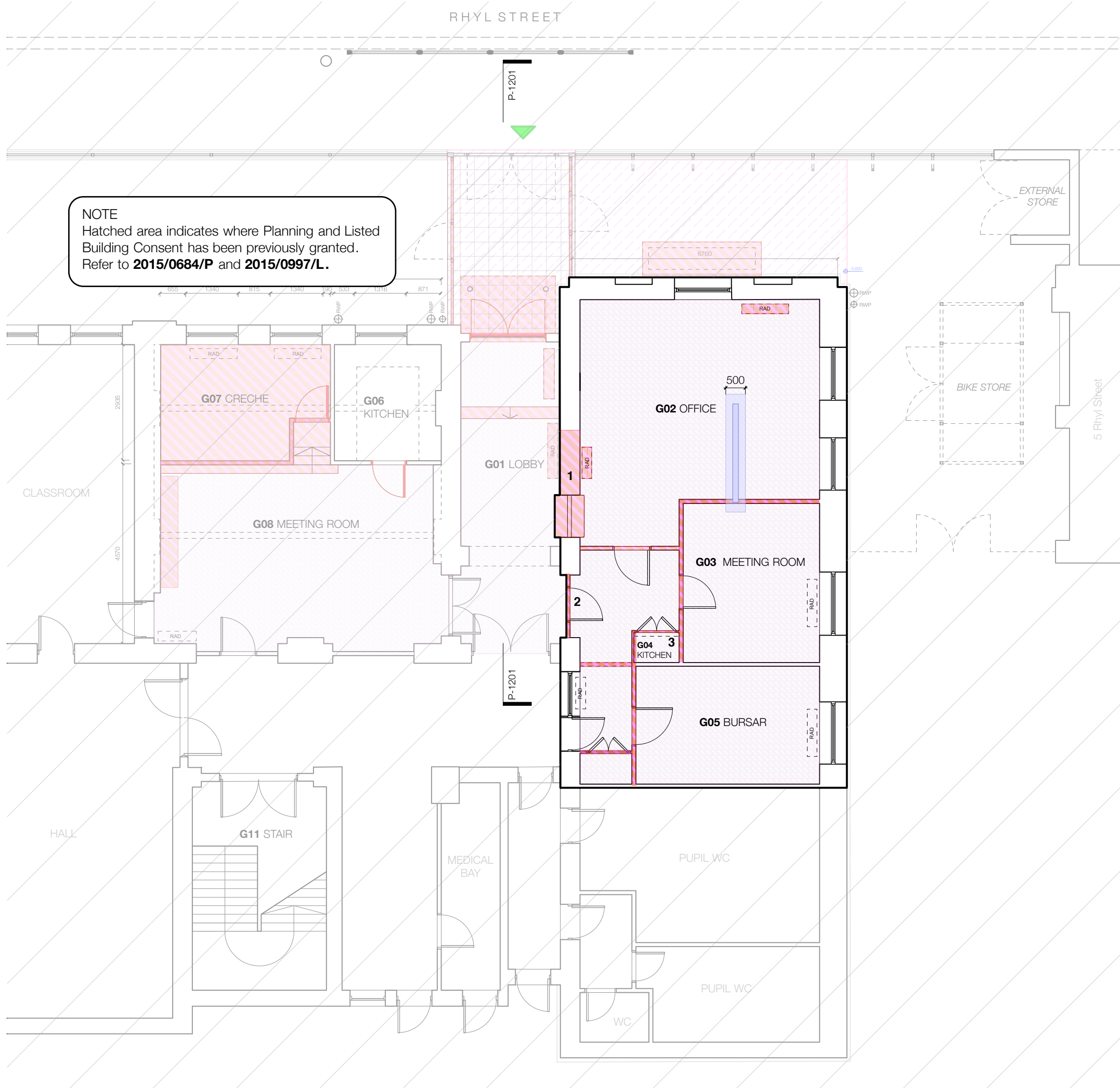

mountain
3 Greenland Place
Camden Town London NW1 0AP
07967 111 660



Rhyll Primary School
Job
For Planning Approval
status

All dimensions to be checked on site
Levels are not co-ordinated to Ordnance Survey standards and are indicated for guidance using the lobby floor as a datum +0.00

Refer to schedule of works in design and access statement for more information

Drawing to be read in colour

notes

- 13.01.16 planning issue

rev

GA Ground Floor Plan
Demolitions
title

1403A_P_1101
drawing number

1/100 A/3

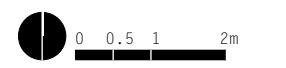

This drawing is copyright of Michael Tite Architecture Ltd. Do not scale off the drawings