

**Fitzjohn's Avenue, NW3**

Prepared for the London Borough of Camden

**Planning, Design and Access Statement**

Planning report - Rainwater pipes



## Rainwater pipes

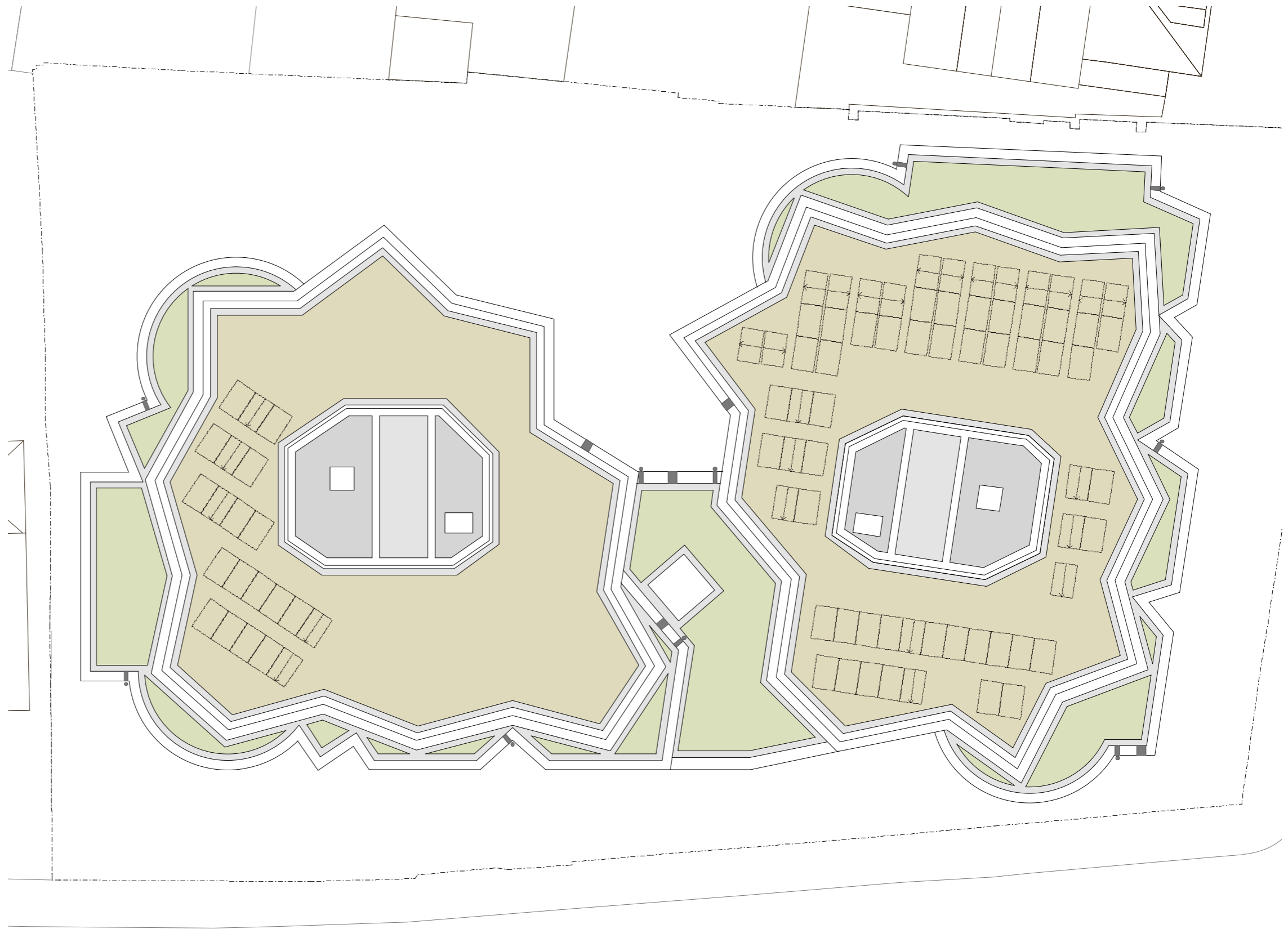

Extensive, warm, green roof

Sedum, warm, green roof

Gravel ballast

PV panels

Rainwater downpipe

Rainwater overflow

The rainwater pipes for the lower roofs have been carefully distributed along the façade to minimize its appearance.

The downpipes are always located in the inner corners, between the bays of the building, in order to appear recessed from the main elevations.

Finish: Powder coated metallic finish to match balustrades.

Elevation detail  
Rainwater pipes



1



2



3

- 1 Powder coated sample.
- 2 Palette of materials for Fitzjohns Avenue project.
- 3 Example of exposed rainwater pipe on brick facade. SergisonBates building in Wingene, Belgium.



Elevation detail  
Rainwater pipes

Rainwater downpipe

Detail of Fitzjohns Avenue  
main elevation