

05
15.12.05

06
15.12.06

08
15.12.08

07
15.12.07

08
15.12.08

09
15.12.08

10
15.12.10

04
15.12.04

02
15.12.05

01
15.12.05

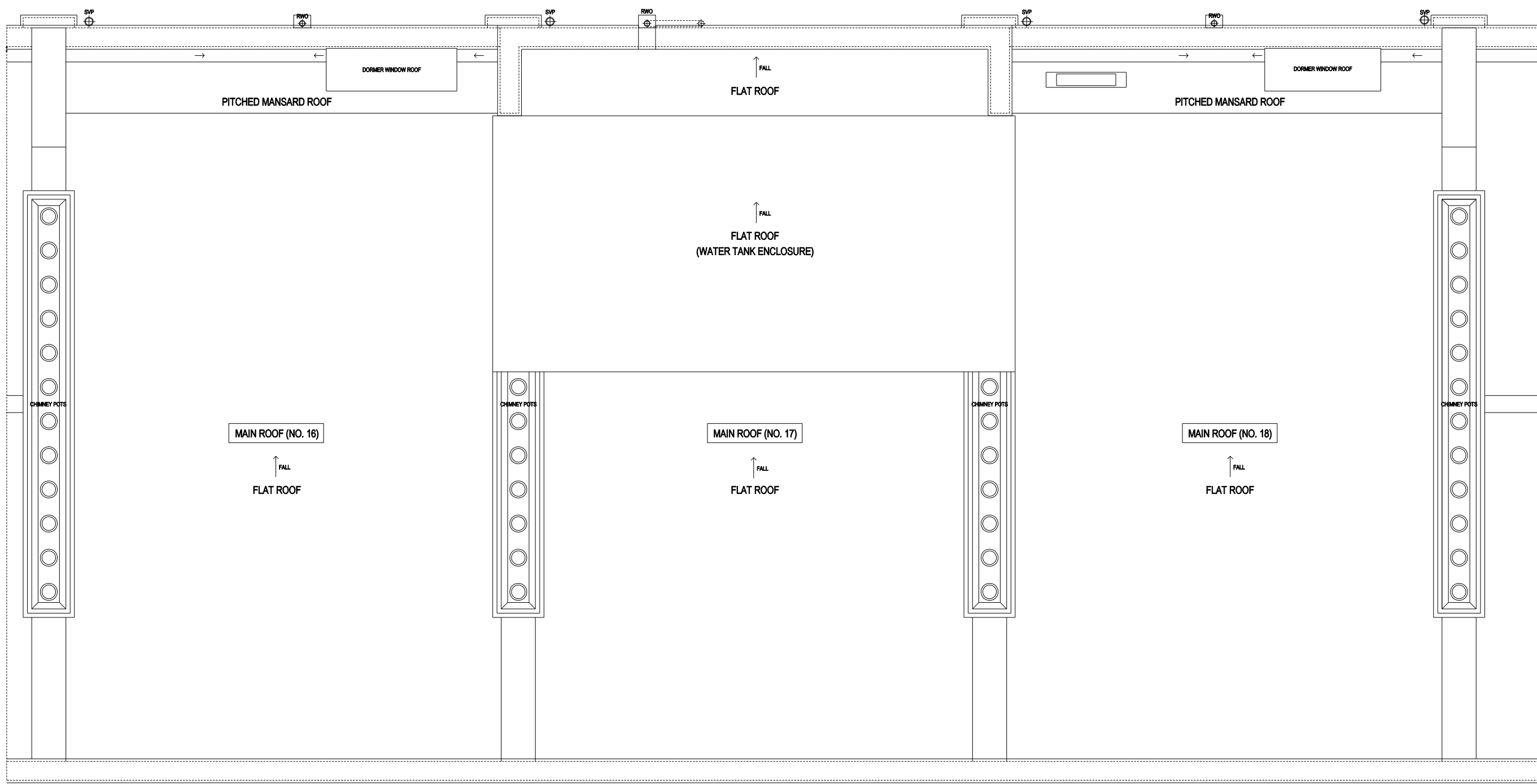

07 PROPOSED ROOF: GENERAL ARRANGEMENT PLAN 07
Scale 1:50 (@A1 SIZE)

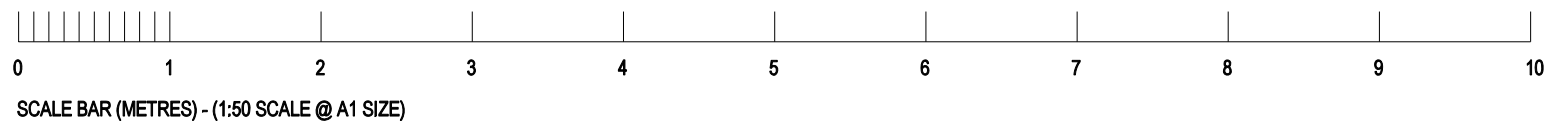
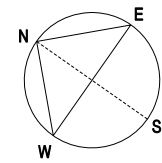

31.10.15 ISSUE FOR PLANNING & LISTED BUILDING CONSENT
rev date reason by



Unit 6: Masons Yard
177 Westbourne Street t: +44 (0) 1273 201 830
Hove e: steve@searyarchitects.co.uk
East Sussex BN3 5FB w: www.searyarchitects.co.uk

project:	Montana Hotel: 16-18 Argyll Square, Kings Cross, London, WC1H 8AS
client:	The St. Pancras Hotel Group
dwg title:	Proposed Roof: GA Plan 07
dwg no:	15-11-07
scale:	1:50 (@A1 SIZE)
project no:	1814
rev:	
date:	31.10.15
status:	PLANNING & LBC

all dimensions must be checked on site and not scaled from this drawing
© copyright seary architects