

05  
15.02.05

06  
15.02.06

08  
15.02.08

07  
15.02.07

08  
15.02.08

09  
15.02.09

10  
15.02.10

04  
15.02.04

02  
15.02.02

01  
15.02.01

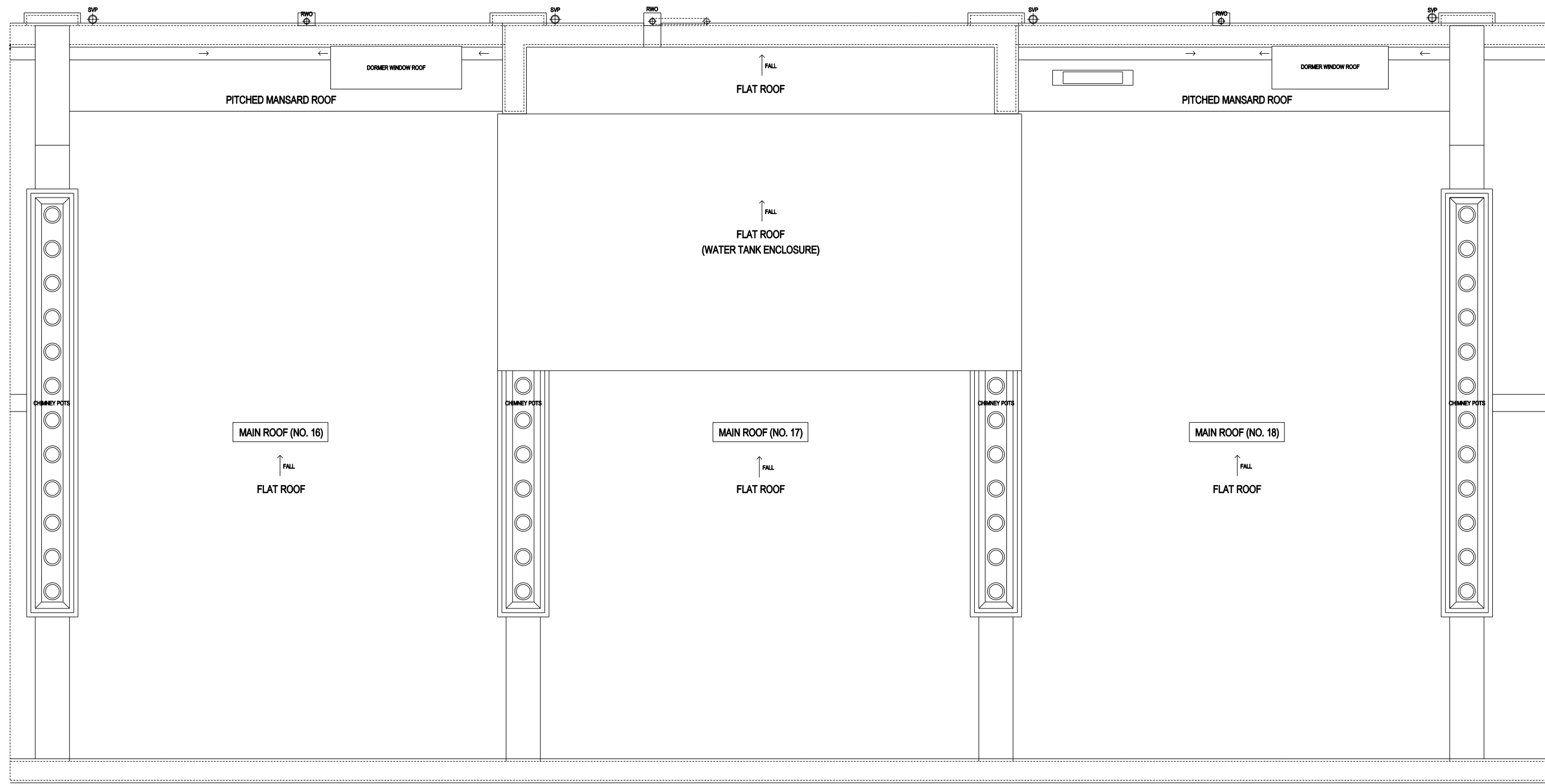

07 EXISTING ROOF: GENERAL ARRANGEMENT PLAN 07  
Scale 1:50 (@A1 SIZE)

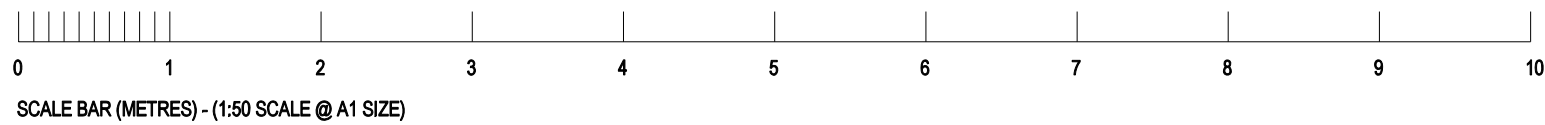
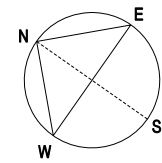

rev	date	reason	by
31.10.15		ISSUE FOR PLANNING & LISTED BUILDING CONSENT	



Unit 6: Masons Yard  
177 Westbourne Street t: +44 (0) 1273 201 830  
Hove e: [steve@searyarchitects.co.uk](mailto:steve@searyarchitects.co.uk)  
East Sussex BN3 5FB w: [www.searyarchitects.co.uk](http://www.searyarchitects.co.uk)

project:	Montana Hotel: 16-18 Argyle Square, Kings Cross, London, WC1H 8AS
client:	The St. Pancras Hotel Group
dwg title:	Existing Roof: GA Plan 07
dwg no:	15-01-07
scale:	1:50 (@A1 SIZE)
project no:	1814
rev:	
date:	31.10.15
status:	PLANNING & LBC

all dimensions must be checked on site and not scaled from this drawing  
© copyright seary architects