

NOTES:-

- 1. THIS DRAWING AND DESIGN IS THE COPYRIGHT OF ALAN BAXTER PARTNERSHIP AND MUST NOT BE COPIED IN PART OR WHOLE WITHOUT CONSENT.
- 2. DO NOT SCALE THIS DRAWING.
- 3. THIS DRAWING IS TO BE READ IN CONJUNCTION WITH ALL ARCHITECTS AND ENGINEERS DRAWINGS.

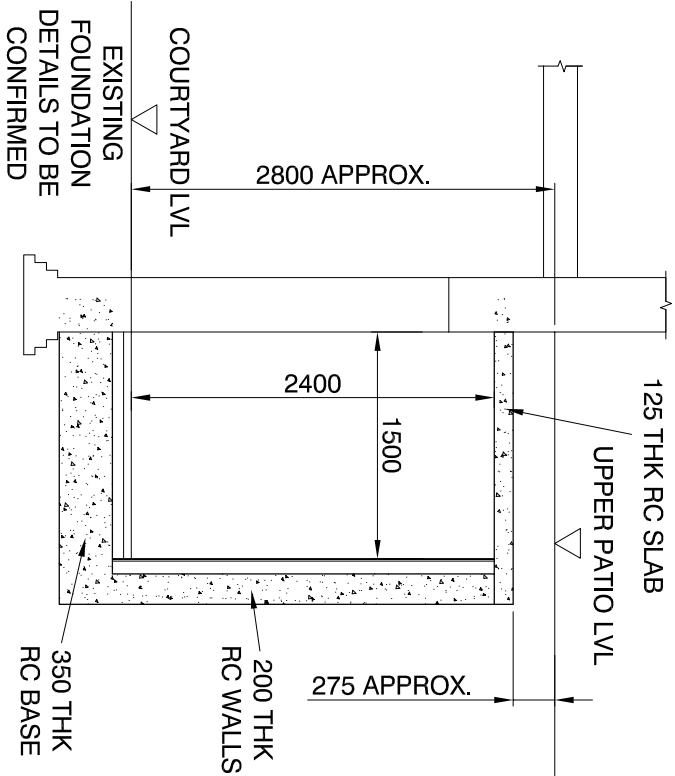

Typical Section Through

Corridor

(1:50 @ A3)

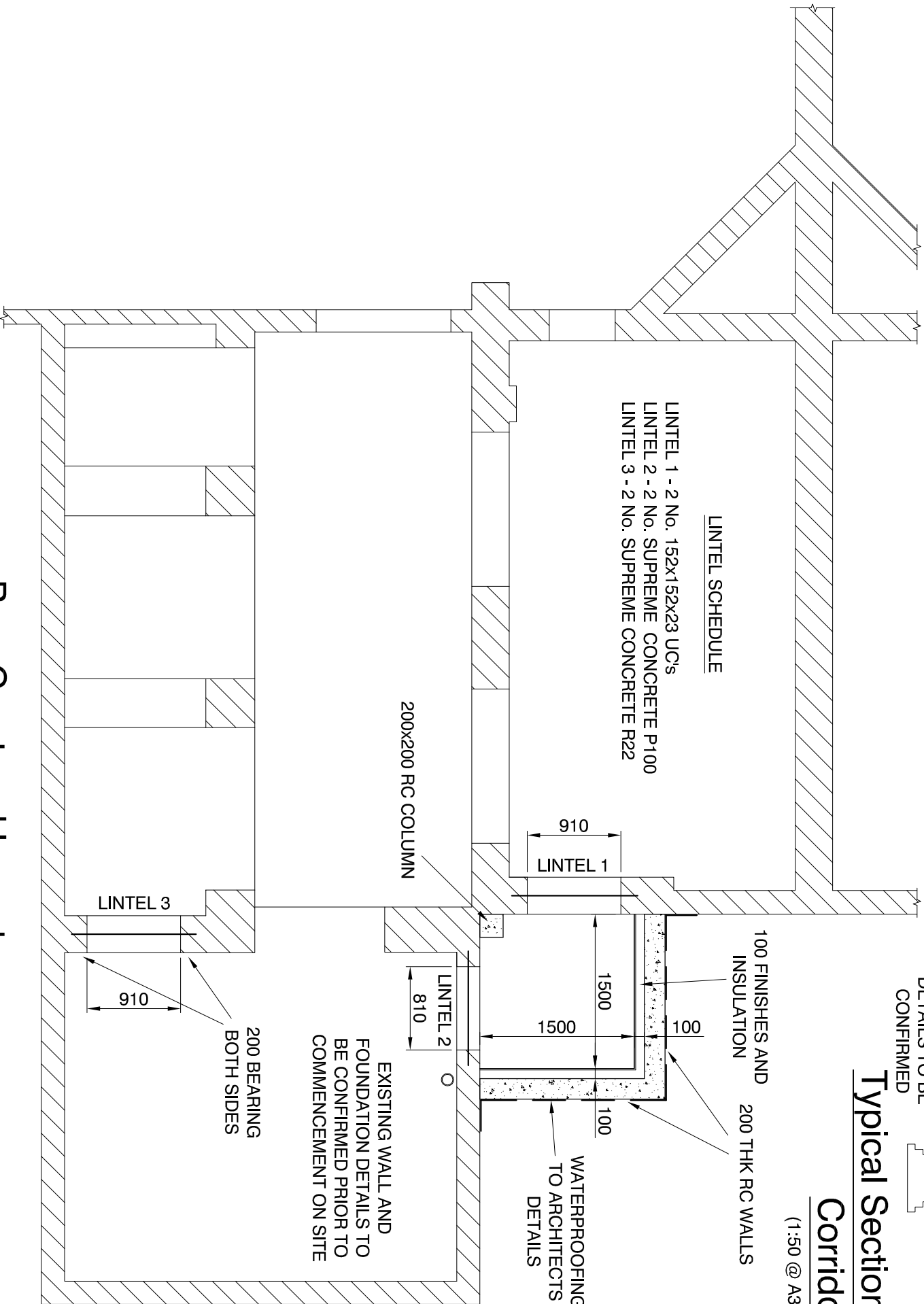

LINTEL SCHEDULE

LINTEL 1 - 2 No. 152x152x23 UC's  
LINTEL 2 - 2 No. SUPREME CONCRETE P100  
LINTEL 3 - 2 No. SUPREME CONCRETE R22

PRELIMINARY

Rev	Description	Drm	Chk	Date

**ALAN BAXTER PARTNERSHIP** LLP  
CONSULTING STRUCTURAL ENGINEERS  
THE CLOCK BUILDING  
PYMPES COURT  
BUSBRIDGE ROAD  
LOOSE  
MAIDSTONE  
KENT ME15 0HZ  
TELEPHONE: 01622 744263  
FAX: 01622 749270  
EMAIL: mail@abpengineers.co.uk



Project  
**10A Great Ormond Street**  
**London**  
**WC1N 3RB**

Drawing  
**Proposed Basement Passage**  
**and Related Works to Rear**  
**Courtyard**

Date	Nov '15	Scale	1:50 @ A3	Rev
Ref	<b>B1455-A3-01</b>			

Rear Courtyard Layout

(1:50 @ A3)