

DO NOT SCALE OFF THIS DRAWING
 ALL AMBIGUITIES OR DISCREPANCIES
 TO BE REPORTED TO ARCHITECT
 BEFORE COMMENCING

- POSTMEN'S SORTING OFFICE**
1. Perforated metal panel balustrade.
 2. External floor finish carried through new semi-internal walkway.
 3. Stairs and landing in granite effect, plank paving finish.
 4. Granite effect, plank paving to new ramp.
 5. Smooth finish, aggregated concrete planters to form handrails. Planted with grasses and light plants subject to detailed design by landscape designer.
 6. Reinstated plinth to Postmen's Sorting Office - smooth finish, grey aggregated concrete to match ramp and planter elements.
 7. LED uplighters set in paving.
 8. Granite effect, plank paving.
 9. Perforated metal panels.
 10. Gate in perforated metal panels and steps to courtyard.
 11. Metal grillework to SUDs (Sustainable Surface Drainage) beneath.
 12. Feature tree to arrival space, grillework cut around trunk.

13. Perforated metal bench to arrival space.
 14. Reeds and grasses planted through grillework.
 15. Metal grillework to entrances and niches, with drainage runs through and grasses and reeds planted through grillework.
 16. Metal, linear drains to SUDs.
 17. Perforated metal panels, with planting in front; backlit by LED strip lighting at night.
 18. Concrete garden wall sections, pigmented to match adjacent block.
 19. Paving to private courtyards.
 20. Metal grillework, with SUDs underneath and grasses and reeds planted through the grillework.
 21. Perforated metal benches, with LED uplighting set behind.
 22. Communal allotments planting.
 23. Covered residential bike store in perforated metal enclosure to match fence panels.
 24. Covered residential refuse store for
 - 1 x 660l General Waste Bin
 - 1 x 240l Paper/Card Recycling Bin
 - 1 x 240l Metal Recycling Bin
 - 1 x 240l Plastic Recycling Bin
 - 1 x 240l Food Waste Bin
- Total Capacity = 1620l

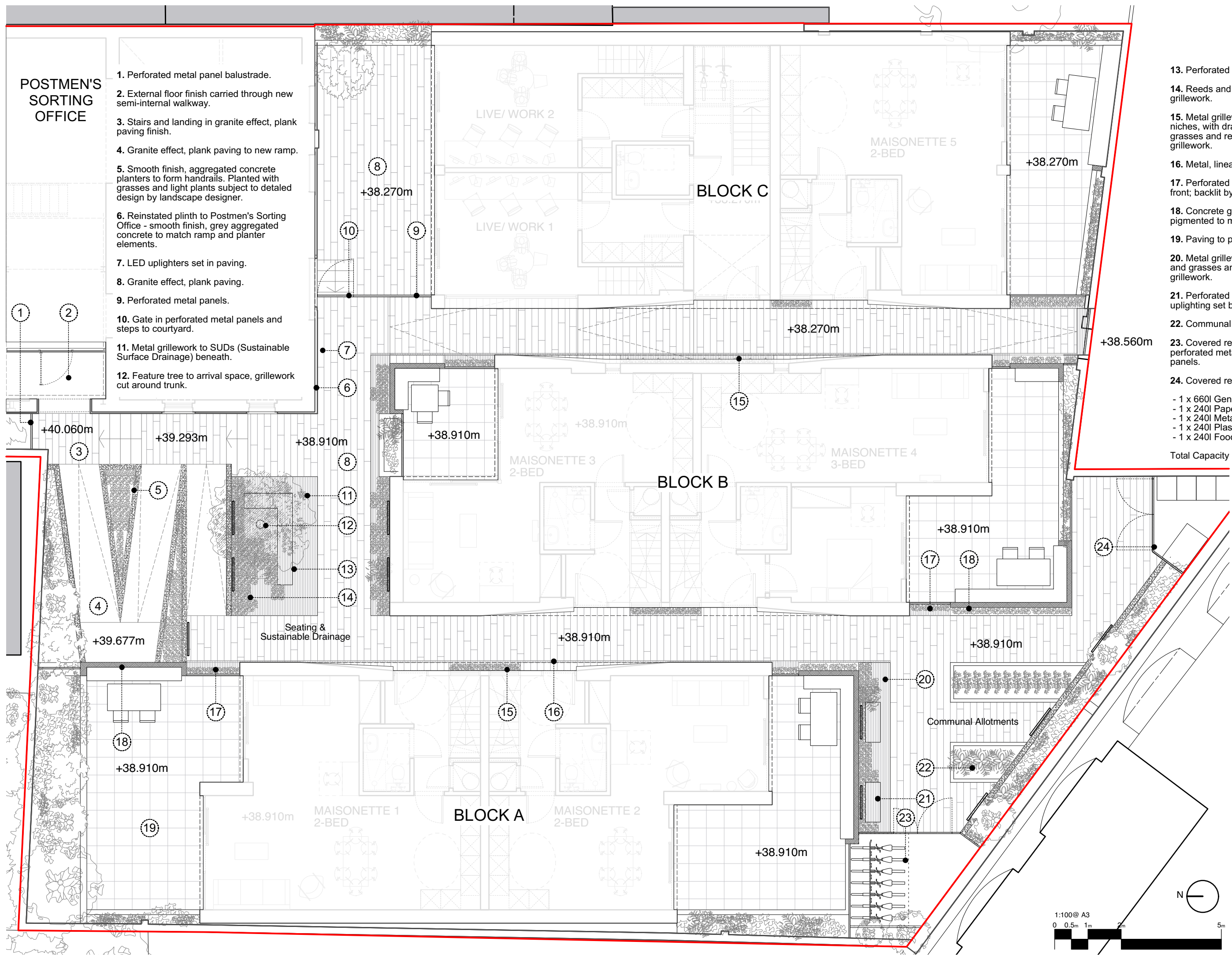

Revisions		
Date:	Rev:	Details:
24/08/15	A	Site boundary line revised.
14/12/15	B	Refuse store and cycle storage details amended.

STUDIO MACKERETH		
ARCHITECTS 7B ST PANCRAS WAY LONDON NW1 0PB		
TELEPHONE + 44 (0)20 7042 8335 EMAIL: INFO@STUDIOMACKERETH.COM		
Project 30 Leighton Road		
Drawing Title Proposed Landscape Plan		
Scale 1:100 @ A3	Creation Date June 2015	Status Plan
Project No. 015	Drawing No. 145	Revision B