

01 Tray storage
592

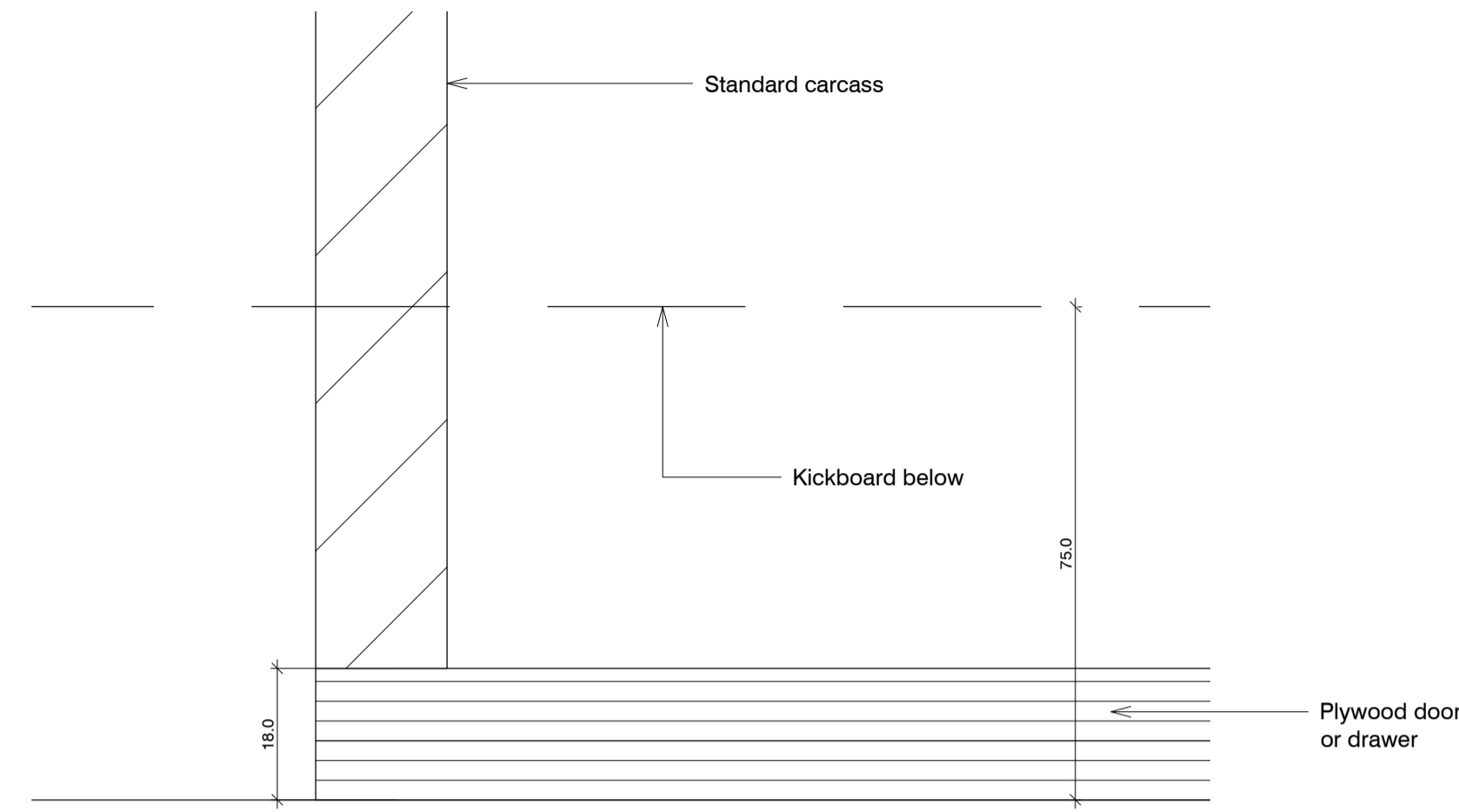

02 Plan of base cupboard at edge
592

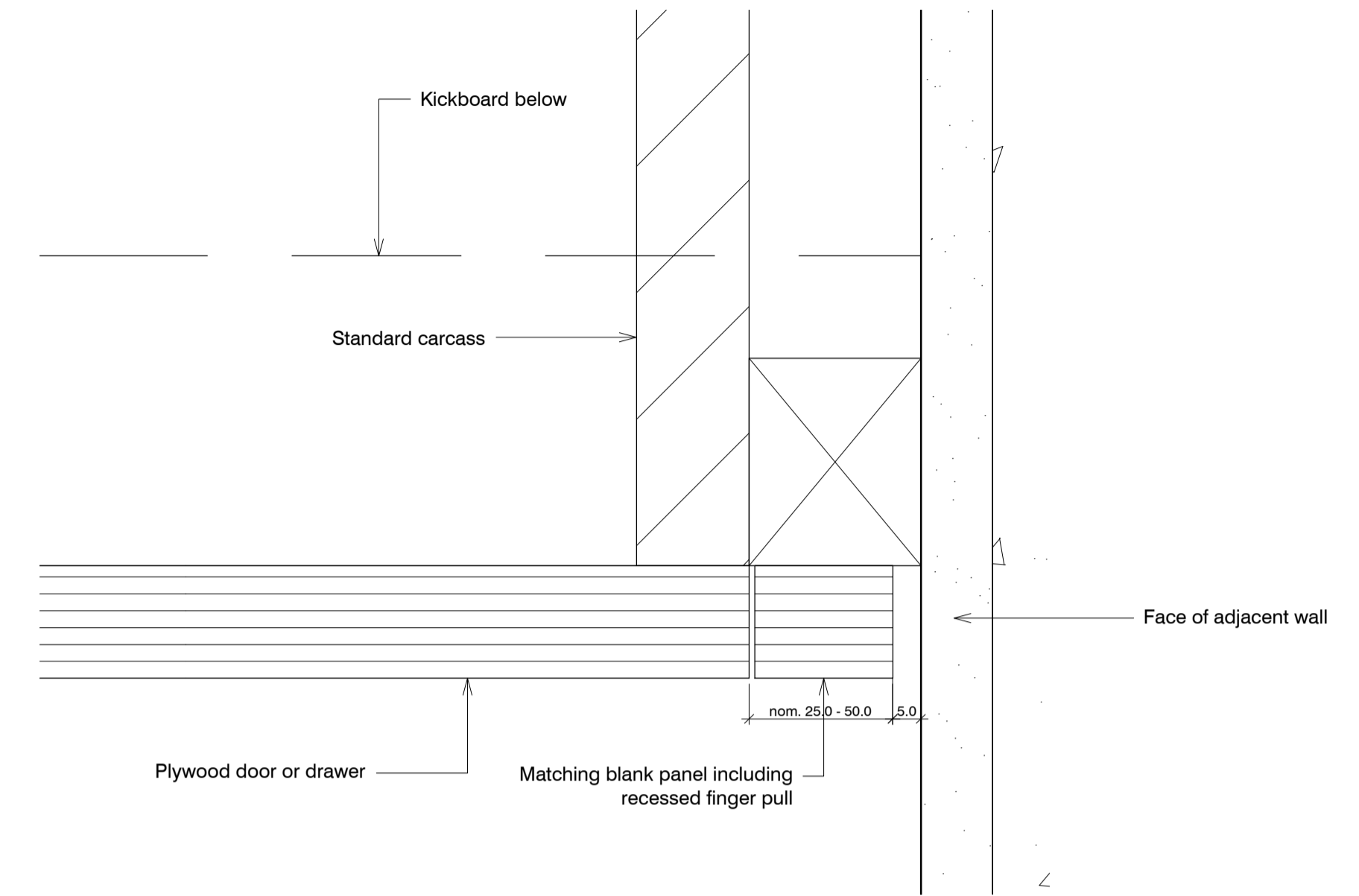

03 End detail of cupboard at adjacent wall
592

Kitchen replacement details ALEXANDRA RD. ESTATE

date Dec 2015	client LB CAMDEN	Levitt Bernstein 1 Kingsland Passage London E8 2BB
scale 1:1@A1	drawing Replaced cupboards: Plans	t: 020 7275 7676 f: 020 7275 9348 w: levittbernstein.co.uk e: post@levittbernstein.co.uk
drawn KS	checked JM	drawing number 2504_A_592
rev P2		

J:\2504 Alexandra Road Estate Management Guidelines\CAD\AutoCAD\1 Architecture Levitt Bernstein

standard notes

1. Do not scale this drawing.
2. All dimensions must be checked on site and any discrepancies verified with the architect.
3. Unless shown otherwise, all dimensions are to structural surfaces.

THIS IS NOT A CONSTRUCTION DRAWING. IT IS UNSUITABLE FOR THE PURPOSE OF CONSTRUCTION AND MUST ON NO ACCOUNT BE USED AS SUCH.

drawing notes

1. Note that these drawings show typical dimensions whereas dwelling will vary in particular, to suit the curvature of the railway line adjacent.
2. Services routes cannot be confirmed until full, invasive surveys are undertaken. Services are therefore shown indicatively.

revisions

- | | | |
|----|------------|---------------------------------|
| P1 | 27.11.2015 | Draft issue for HPA application |
| P2 | 15.12.2015 | HPA Submission |