

01 Section 01
304 1:20

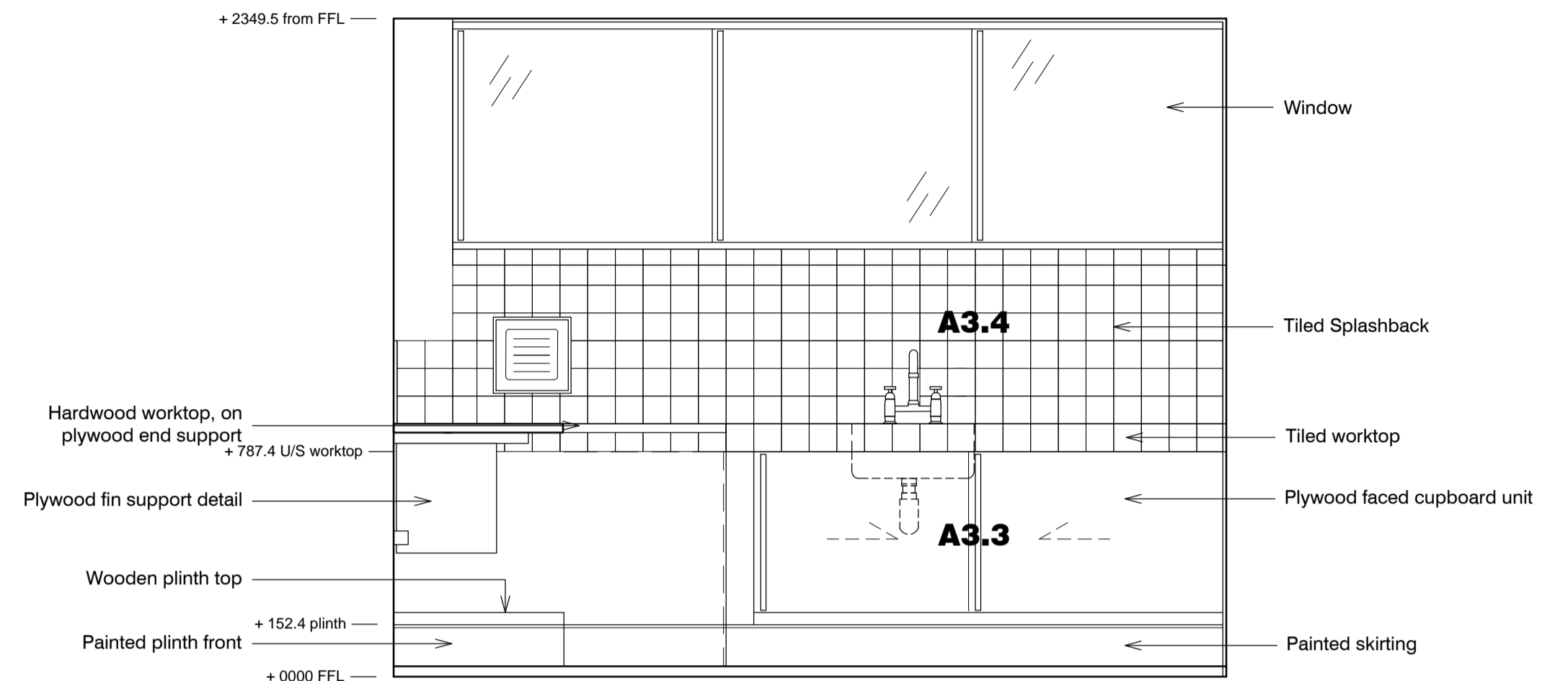

02 Section 02
304 1:20

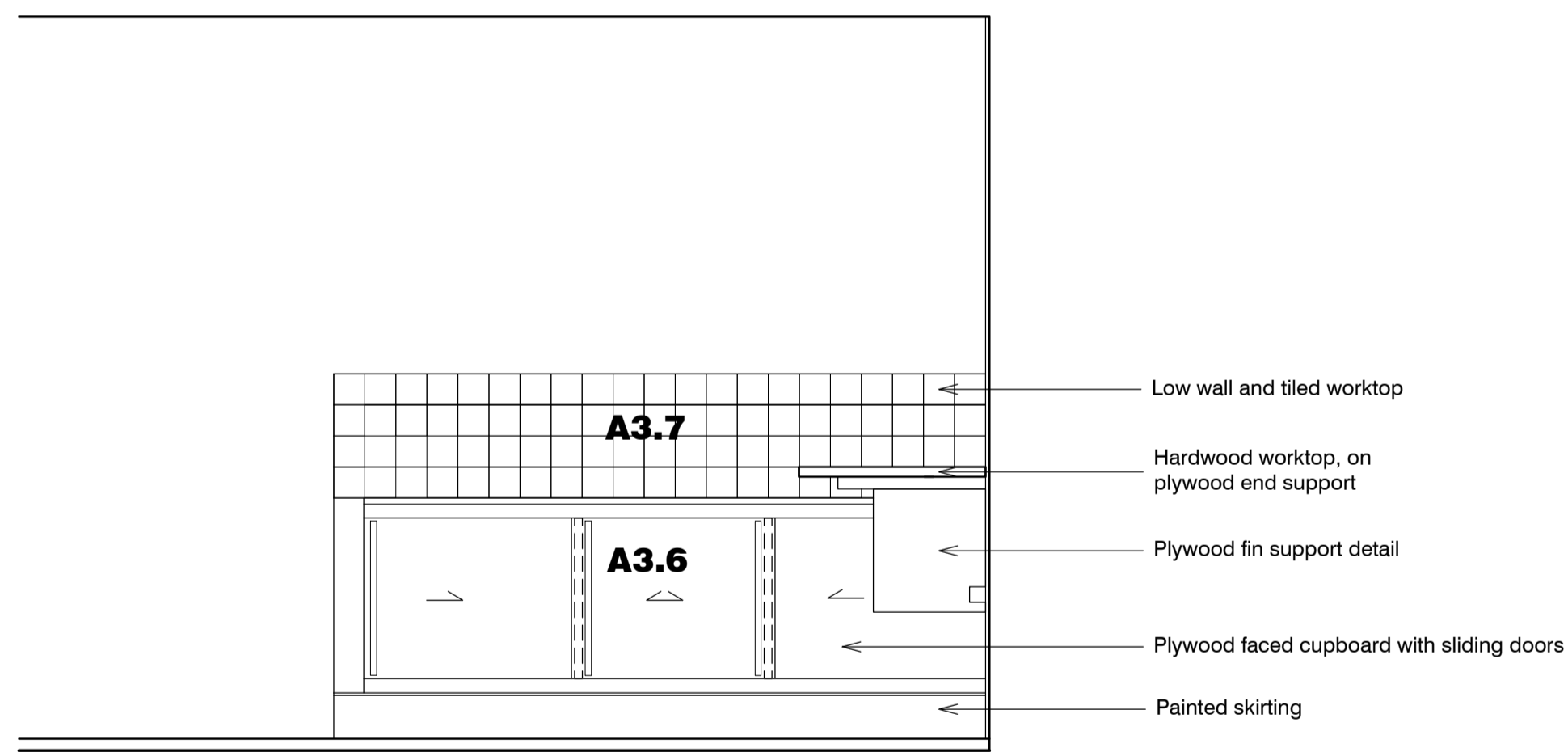

03 Section 03
304 1:20

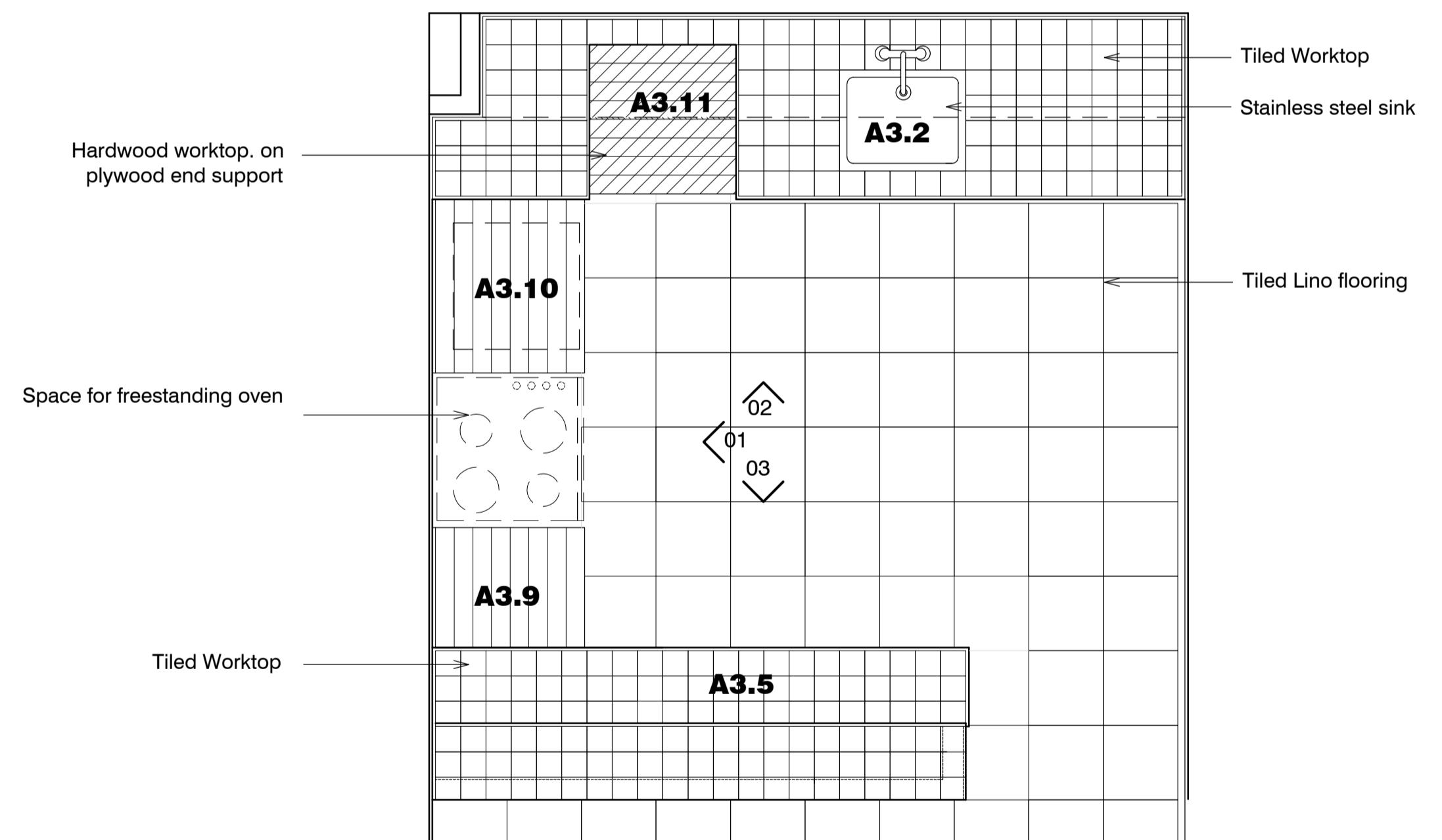

04 Plan
304 1:20

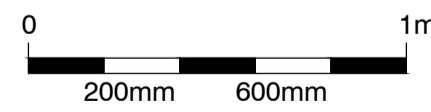

Key:
Salvage in all cases.
Refer to C90 specification

standard notes

1. Do not scale this drawing.
2. All dimensions must be checked on site and any discrepancies verified with the architect.
3. Unless shown otherwise, all dimensions are to structural surfaces.

THIS IS NOT A CONSTRUCTION DRAWING, IT IS UNSUITABLE FOR THE PURPOSE OF CONSTRUCTION AND MUST ON NO ACCOUNT BE USED AS SUCH.

drawing notes

1. Note that these drawings show typical dimensions whereas dwellings will vary - in particular, to suit the curvature of the railway line adjacent.
2. Services routes cannot be confirmed until full, invasive surveys are undertaken. Services are therefore shown indicatively.

revisions

- | | | |
|----|------------|---------------------------------|
| P1 | 27.11.2015 | Draft issue for HPA application |
| P2 | 15.12.2015 | HPA Submission |

Flat Type A3 ALEXANDRA RD. ESTATE

date
Dec 2015

client
LB CAMDEN

scale
1:20@A1

drawing
Original Kitchen: Flat Type A3

drawn
KS

checked
JM

drawing number
2504_RL_304

rev
P2

Levitt Bernstein
1 Kingsland Passage
London
E8 2BB

t: 020 7275 7676
f: 020 7275 9348
w: levittbernstein.co.uk
e: post@levittbernstein.co.uk