

All inspection of the underground drainage was not possible on survey. Contractor should check drainage runs and invert levels prior to starting work on any opening. All proposed work on the ground MUST BE VERIFIED BY CONTRACTOR.

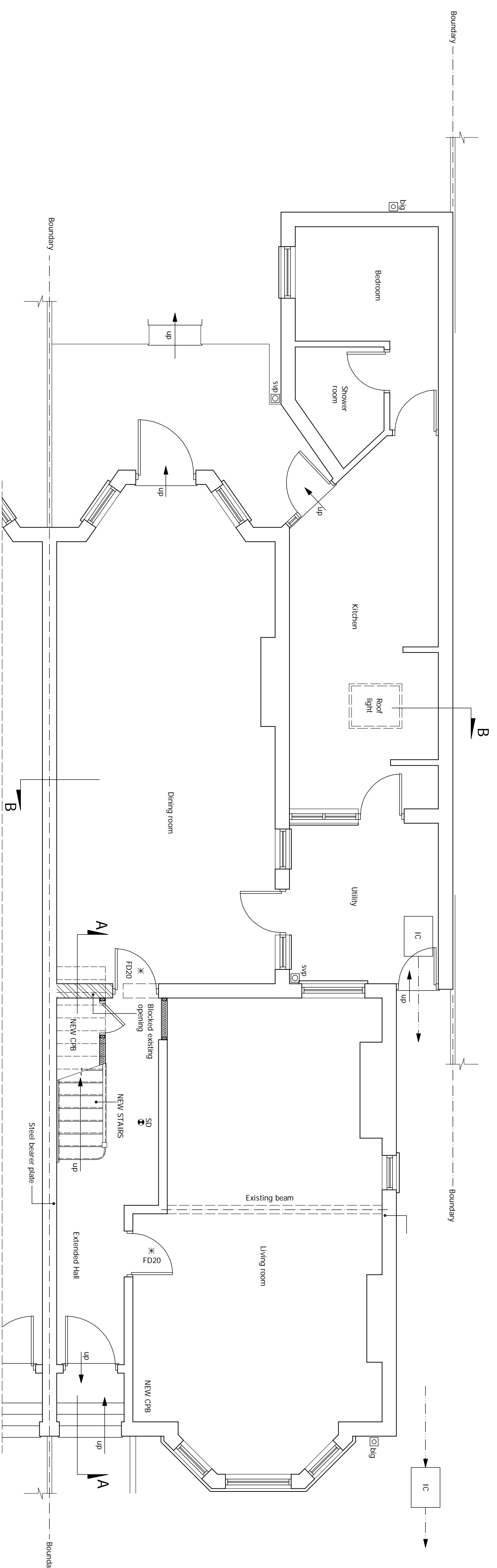

PROPOSED GROUND FLOOR PLAN
Scale 1:50

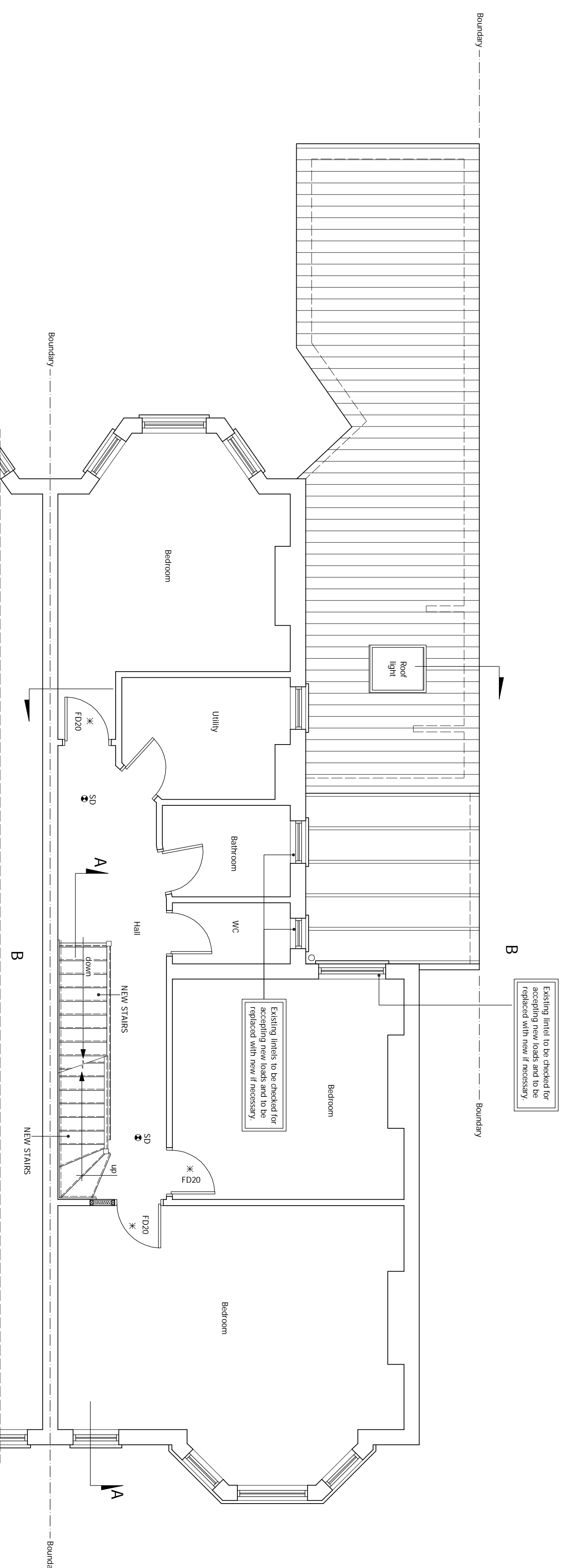

PROPOSED FIRST FLOOR PLAN
Scale 1:50

10. ELECTRICAL INSTALLATION and PART P BUILDING REGULATIONS ELECTRICAL SAFETY:-

Where electrical work is required to comply with Schedule 1 of the Building regulations it will either:
a. Be installed, by electrician who is registered as Part P approved by an authorised body (a completion certificate/certificate of compliance will need to be obtained from their authorised body (NICEIC, ELECSA, NAPIT etc.).
b. Any other electrician will require and Electrical Safety Building Notice application.

The proposed electrical installation, earthing and bonding to be installed to current IEE regulations & to comply with Part P requirements of the Building regulations. Inter-linked.

self-contained smoke alarms shall be provided in the circulation areas of the dwelling. The smoke alarms shall be mains operated in accordance with Section 1 of Approved Document B Volume 1. Fixed fitting taking only lamps having a luminous efficacy of 40 lumens per circuit watt shall be used at one per 25 m² of floor area or three of four or 75% fittings which ever is the greater. Fixed external lighting shall be either lamp capacity not exceeding 150 w per light fitting that switches off automatically or fittings taking only lamps of 90 lumens per circuit watt.

11. GAS INSTALLATIONS & HEATING:-

The proposed gas installation shall be designed and installed by GASSAFE registered person in accordance with the manufacturer's instructions. Central pre-combustion. Extend existing central heating to new areas to client's instructions. Where new or replacement boilers are installed must be a condensing boiler and must have a SEDBUK rating of Class A or B and the condense outlet must be taken to the foul drainage system. New radiators fitted with thermostatic type valves with pipework installed to non heated locations.

12. NATURAL AND MECHANICAL VENTILATIONS:-

Prior to completion details of commissioning and testing of mechanical systems for extracts to be deposited with building Control to show compliance with F1 (2).

- a) Habitable room:
- Rapid ventilation - 1/20th of floor area - for a hinged or pivot window that opens 30° or more, or for sliding sash window that opens less than 30°.
- Background ventilation - 8000 mm²
b) Bathroom (with or without WC):
- Rapid ventilation - opening window
- Background ventilation - 2500 mm²
c) Sanitary accommodation (separate from bathroom):
- Rapid ventilation - opening window
- Background ventilation - 2500 mm²
- Extract ventilation fan rates - 6 l/s

The extract fans to rooms like utility, WC and bathroom having no external opening window to be provided with a 15 minic overran. Location of mechanical ventilation devices in rooms:
a) Mechanical extract fans should be placed as high as practicable and preferably less than 400mm below the ceiling. Refer to Appendix E Approved Document F for further guidance of installation of fans in dwellings.

13. STAIRS:- New softwood staircase min. 90 23mm max. rise 200mm width unobstructed 810mm. Handrail 900mm above pitch line measured vertically with stair rails at max 95mm c/c where required. Minimum headroom over pitch 2100mm measured vertically. New staircase as per detail closed tread design. Site measure for new staircase prior to ordering. All to comply with approved Deck.
THE CONTRACTOR SHALL ALLOW FOR MAKING GOOD OF ALL DISTURBED WORKS.

Other Notes, Alterations.

1. All existing foundations, beams and/or lintels accepting additional load, are to be exposed, if necessary, for consideration by the Building Control Surveyor and upgraded if found necessary.

drawnplans.co.uk

Project: Loft Conversion with
Dormer Windows to Rear.

For: Mrs. Shelley Malhotra
36 Sarre Road
Cricklewood
London
NW2 3SL

Scale: AS Shown	Drawn no: Sheet 3 of 5	Rev. no: 01
Drawn by: I.M.	Date drawn: 05-January-2016	
For Drawings Tel: 0800 7836790		
E-mail :- drawnplansco@aol.com		

