

T:\2332 Centre Point\02-Sheets\25 Series External Wall\2332(25)512\_Ground Floor Facade Transom Detail.dgn  
29/04/2013  
2332  
Conran

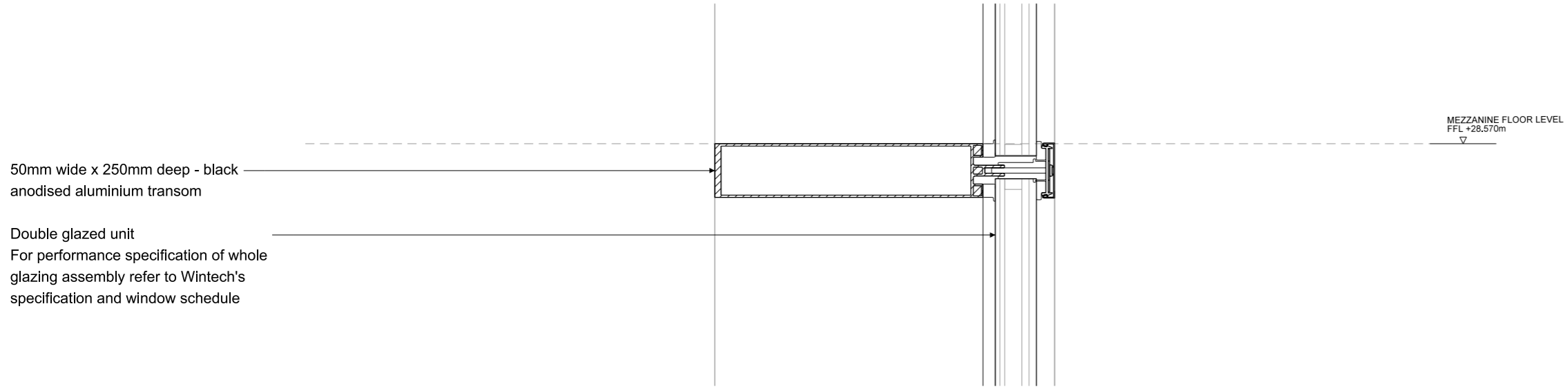

50mm wide x 250mm deep - black anodised aluminium transom

Double glazed unit  
For performance specification of whole glazing assembly refer to Wintech's specification and window schedule

MEZZANINE FLOOR LEVEL  
FFL +28.570m  
▽

① GRD FL FACADE TRANSOM DETAIL (DOUBLE HEIGHT SPACE) 1:5

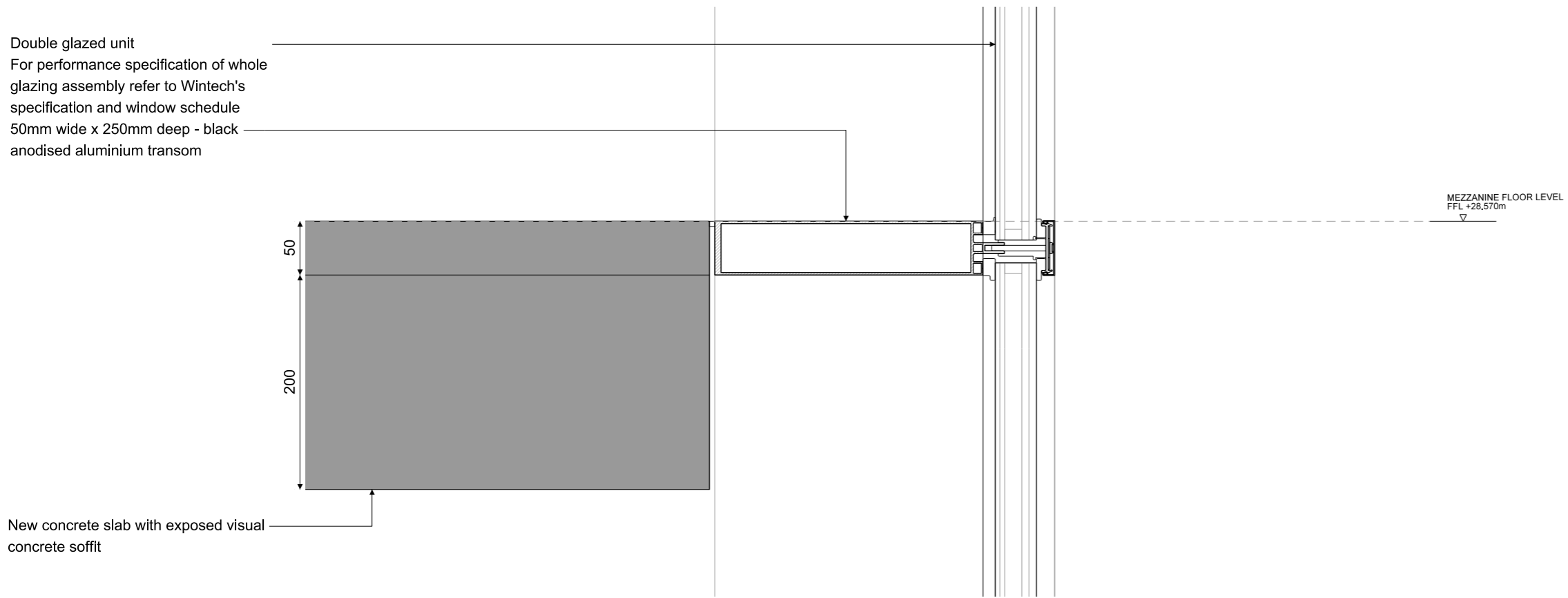

Double glazed unit  
For performance specification of whole glazing assembly refer to Wintech's specification and window schedule

50mm wide x 250mm deep - black anodised aluminium transom

MEZZANINE FLOOR LEVEL  
FFL +28.570m  
▽

New concrete slab with exposed visual concrete soffit

② GRD FL FACADE TRANSOM DETAIL (NEW SLAB) 1:5

All dimensions must be checked on site and not scaled from this drawing. © Conran and Partners Limited

Rev	Date	Reason	By	Checked	Rev	Date	Reason	By	Checked
-	30.04.13	Stage E	PG	AS					

Notes  
The cladding configuration shown is based on structural dimensions taken from the original design drawings  
Structural dimensions are subject to confirmation by site survey  
For floor build up details refer to drawing series (43) Floor Finishes

Project: Centre Point  
Client: Almacantar  
Drawing title: Ground Floor Facade  
Transom Details  
Scale 1:5@A3 Date: April 2013 Drawn by: PG  
Project number: 2332 Drawing No: (25)512 Rev:-  
Status: STAGE E Checked by: AS

**CONRAN+ PARTNERS**  
Architects Designers  
LONDON OFFICE  
Conran Building  
22 Shad Thames,  
London SE1 2YU  
Telephone +44 (0) 20 7403 8899  
Email cp@conran.com