

27/03/2014 \\conran-partners\projects\2332 Centre Point\02-Sheets\25 Series External Wall\2332(25)510_Ground Floor Facade Base Detail.dgn

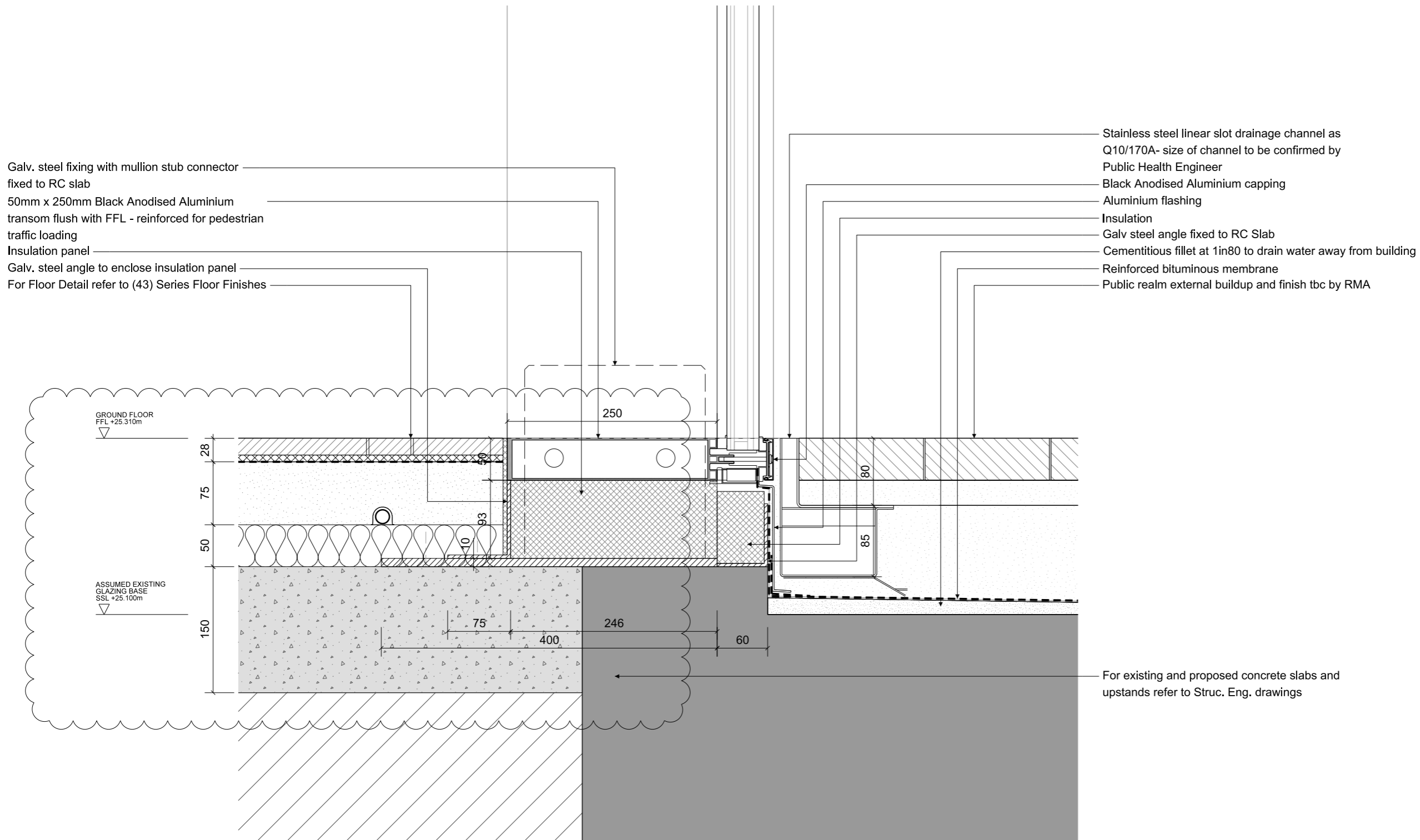

Galv. steel fixing with mullion stub connector fixed to RC slab
 50mm x 250mm Black Anodised Aluminium transom flush with FFL - reinforced for pedestrian traffic loading
 Insulation panel
 Galv. steel angle to enclose insulation panel
 For Floor Detail refer to (43) Series Floor Finishes

Stainless steel linear slot drainage channel as Q10/170A- size of channel to be confirmed by Public Health Engineer
 Black Anodised Aluminium capping
 Aluminium flashing
 Insulation
 Galv steel angle fixed to RC Slab
 Cementitious fillet at 1in80 to drain water away from building
 Reinforced bituminous membrane
 Public realm external buildup and finish tbc by RMA

1 DETAIL 1:5

For existing and proposed concrete slabs and upstands refer to Struc. Eng. drawings

All dimensions must be checked on site and not scaled from this drawing. © Conran and Partners Limited

Rev	Date	Reason	By	Checked	Rev	Date	Reason	By	Checked
-	30.04.13	STAGE E	PG	AS					
A	31.03.14	Floor build up updated	NT	AS					

Notes
 The cladding configuration shown is based on structural dimensions taken from the original design drawings
 Structural dimensions are subject to confirmation based on site survey
 For floor build up details refer to drawing series (43) Floor Finishes

Project: Centre Point
 Client: Almacantar
 Drawing title: Ground Floor Facade
 Base Detail
 Scale 1:5 Date: April 2013 Drawn by: PG
 Project number: 2332 Drawing No: (25)510 Rev: A
 Status: STAGE E Checked by: AS

CONRAN+ PARTNERS
 Architects Designers
 LONDON OFFICE
 Conran Building
 22 Shad Thames,
 London SE1 2YU
 Telephone +44 (0) 20 7403 8899
 Email cp@conran.com