

27/03/2014 \\conran-partners\projects\2332 Centre Point\02-Sheets\02 Series External Walls\2332\25505_Ground\Mezzanine Floor Sections_Main.dgn

2332
Conran

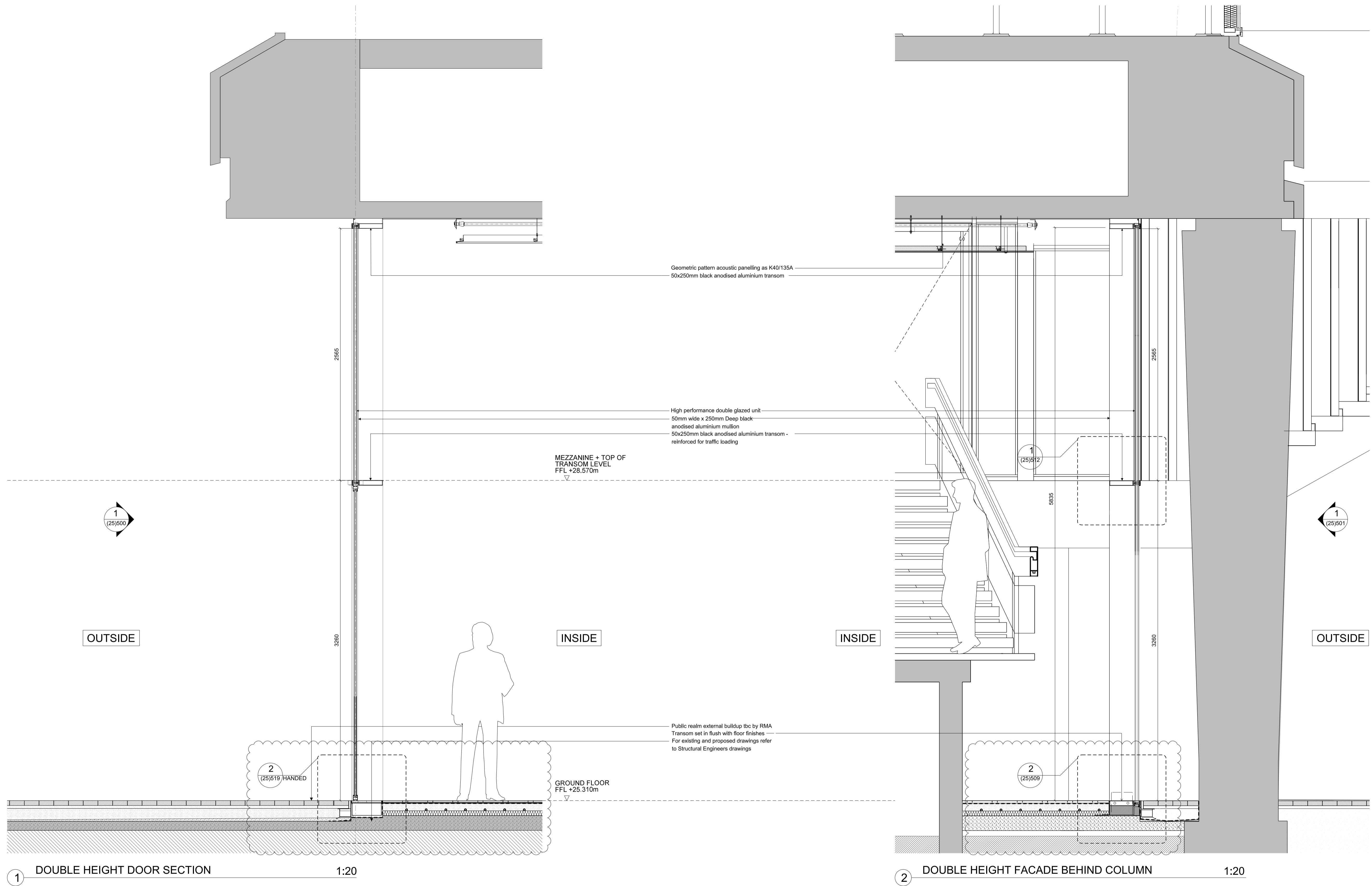

1 DOUBLE HEIGHT DOOR SECTION 1:20

2 DOUBLE HEIGHT FACADE BEHIND COLUMN 1:20

All dimensions must be checked on site and not scaled from this drawing. © Conran and Partners Limited

Rev	Date	Reason	By	Checked	Rev	Date	Reason	By	Checked
-	03.08.12	Stage D Draft	TG	AS					
A	31.08.12	STAGE D	PG	AS					
B	30.04.13	Stage E	PG	AS					
C	31.03.14	Floor build up updated	NT	AS					

Notes
 The cladding configuration shown is based on structural dimensions taken from the original design drawings
 Structural dimensions are subject to confirmation by site survey
 For floor build up details refer to drawing series (43) Floor Finishes

Project: Centre Point
 Client: Almacantar
 Drawing title: Ground/Mezzanine Floor Sections
 Full Height and Mezzanine Height
 Scale 1:20@A1 Date: August 2012 Drawn by: TG
 Project number: 2332 Drawing No: (25)505 Rev: C
 Status: STAGE E Checked by: AS

CONRAN+ PARTNERS
 Architects Designers
 LONDON OFFICE
 Conran Building,
 22 Shad Thames,
 London SE1 2YU
 Telephone +44 (0) 20 7403 8899
 Email cp@conran.com