

T:\2332 Centre Point\02-Sheets\25 Series External Wall\2332(25)512_Ground Floor Facade Transom Detail.dgn
29/04/2013
2332
Conran

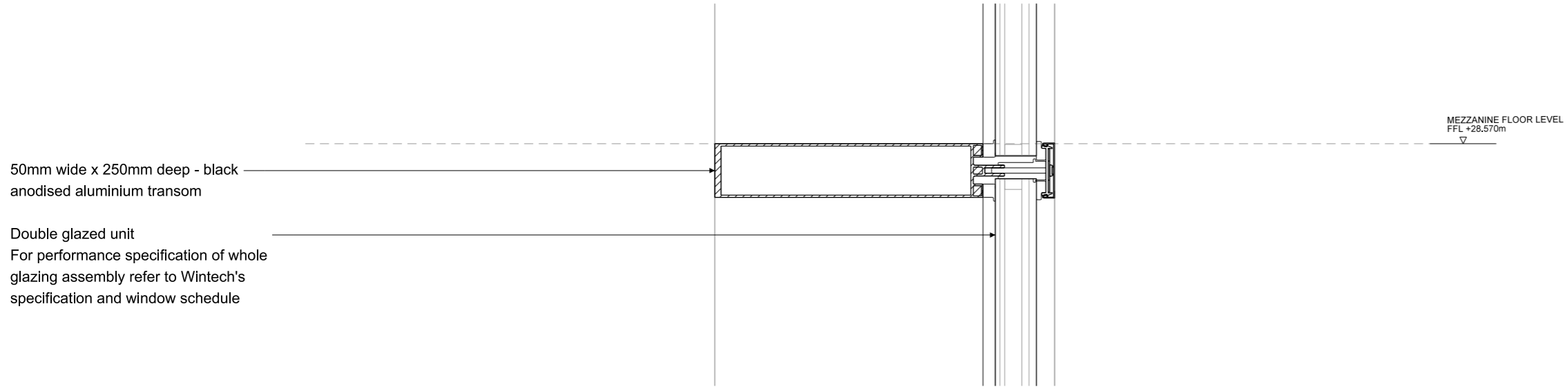

① GRD FL FACADE TRANSOM DETAIL (DOUBLE HEIGHT SPACE) 1:5

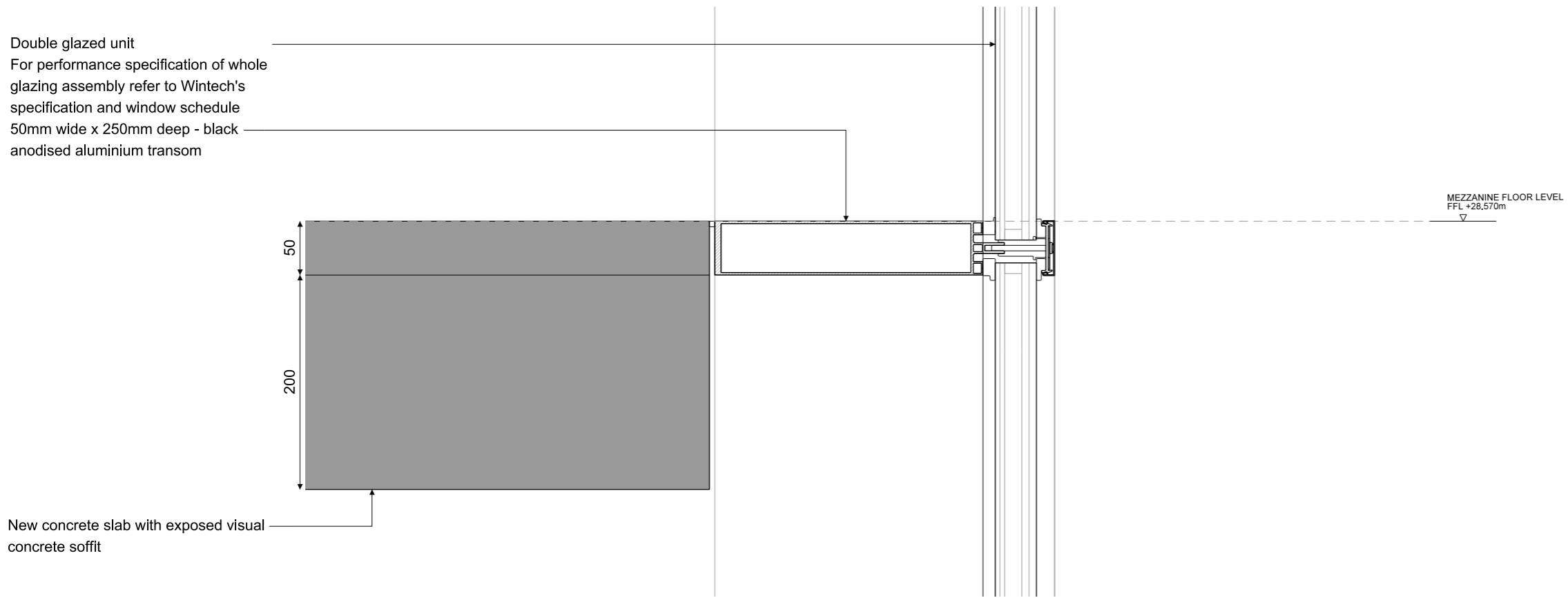

② GRD FL FACADE TRANSOM DETAIL (NEW SLAB) 1:5

All dimensions must be checked on site and not scaled from this drawing. © Conran and Partners Limited

Rev	Date	Reason	By	Checked	Rev	Date	Reason	By	Checked
-	30.04.13	Stage E	PG	AS					

Notes
 The cladding configuration shown is based on structural dimensions taken from the original design drawings
 Structural dimensions are subject to confirmation by site survey
 For floor build up details refer to drawing series (43) Floor Finishes

Project: Centre Point
 Client: Almacantar
 Drawing title: Ground Floor Facade
 Transom Details
 Scale 1:5@A3 Date: April 2013 Drawn by: PG
 Project number: 2332 Drawing No: (25)512 Rev:-
 Status: STAGE E Checked by: AS

CONRAN+ PARTNERS
 Architects Designers
 LONDON OFFICE
 Conran Building
 22 Shad Thames,
 London SE1 2YU
 Telephone +44 (0) 20 7403 8899
 Email cp@conran.com