

27/03/2014 \\conran-partners\projects\2332 Centre Point\02-Sheets\02 Series External Wall\2332\25505_Ground/Mezzanine Floor Sections_Main.dgn

2332
Conran

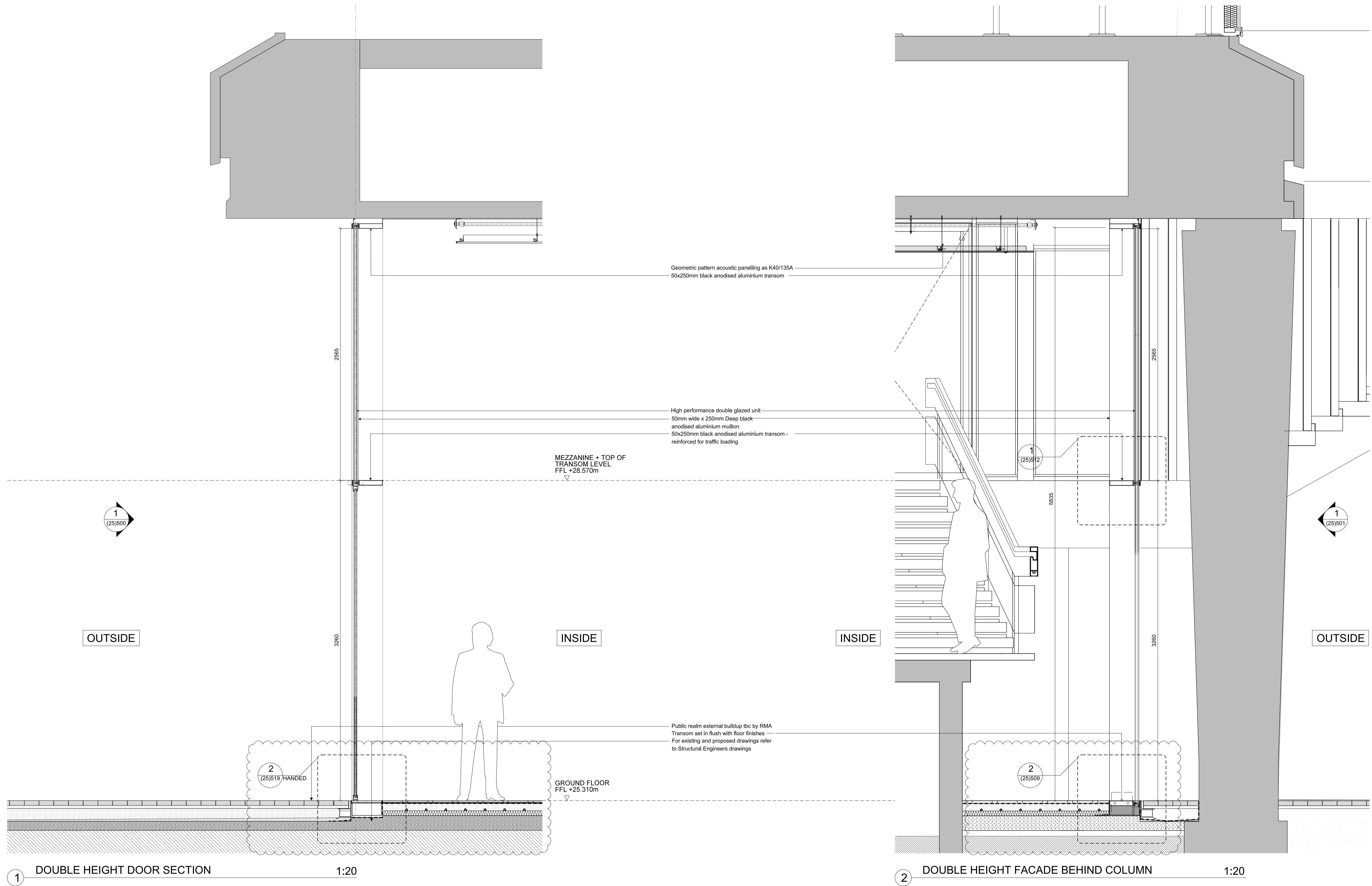

1 DOUBLE HEIGHT DOOR SECTION 1:20

2 DOUBLE HEIGHT FACADE BEHIND COLUMN 1:20

All dimensions must be checked on site and not scaled from this drawing. © Conran and Partners Limited

Rev	Date	Reason	By	Checked	Rev	Date	Reason	By	Checked
-	03.08.12	Stage D Draft	TG	AS					
A	31.08.12	STAGE D	PG	AS					
B	30.04.13	Stage E	PG	AS					
C	31.03.14	Floor build up updated	NT	AS					

Notes
The cladding configuration shown is based on structural dimensions taken from the original design drawings
Structural dimensions are subject to confirmation by site survey
For floor build up details refer to drawing series (43) Floor Finishes

Project: Centre Point
Client: Almacantar
Drawing title: Ground/Mezzanine Floor Sections
Full Height and Mezzanine Height
Scale 1:20@A1 Date: August 2012 Drawn by: TG
Project number: 2332 Drawing No: (25)505 Rev: C
Status: STAGE E Checked by: AS

CONRAN+ PARTNERS
Architects Designers
LONDON OFFICE
Conran Building,
22 Shad Thames,
London SE1 2YU
Telephone +44 (0) 20 7403 8899
Email cp@conran.com