

Notes

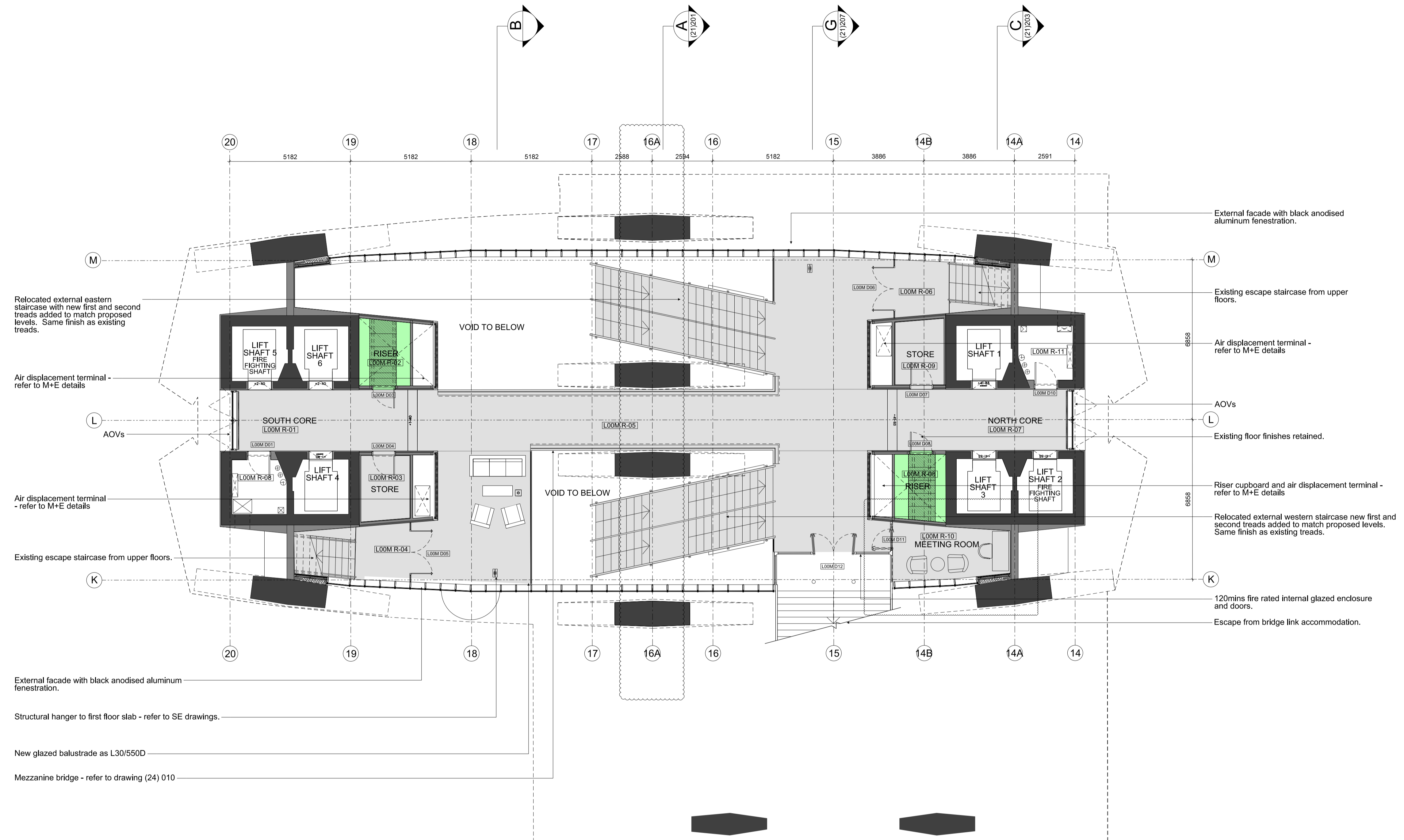

1 MEZZANINE PLAN 1:100 PROPOSED

N	20.10.14	Meeting room door updated	NT	AS
M	31.03.14	Grid line 16A added	NT	AS
L	16.12.13	Wayfinding signage updated	NT	AS
K	17.10.13	L00 D02 Door No. added	NT	AS
J	14.10.13	Lift lobby doors omitted	PG	AS
I	24.05.13	Lift lobby doors omitted	PG	AS
H	30.04.13	STAGE E	NT	NE
G	28.01.13	FOR INFORMATION	NT	AS
F	23.11.12	Concierge desk removed + store added	PG	NE
E	31.08.12	Post rooms relocated to ground floor	NT	NE
D	23.08.12	STAGE D ADDENDUM	NT	AS
C	03.08.12	Seating area added	NT	NE
B	27.07.12	Lift notation	PG	AS
A	01.06.12	STAGE D	TG	AS
-	22.05.12	FOR INFORMATION	NT	AS

Rev	Date	Reason	By	Ckd
-----	------	--------	----	-----

**CONRAN+ PARTNERS**  
Architects Designers

**LONDON OFFICE**  
Conran Building,  
22 Shad Thames,  
London SE1 2YU  
Telephone +44 (0) 20 7403 8899  
Email cp@conran.com

Project: Centre Point  
Client: Almacantar  
Drawing title: GA PROPOSED PLANS  
MEZZANINE  
Scale 1:100@A1 Date: APRIL 2013 Drawn by: NT  
Project number: 2332 Drawing No: (20)002 Rev: N  
Status: STAGE E Checked by: NE

20/10/2014 11:32:32 Centre Point02 - Sheets (20) Series GA Plans2332(20)002\_Proposed\_Mezzanine.dgn 2332 Conran