

1 SECOND FLOOR - FRONT BEDROOM 3 ENTRANCE - DOOR AND ARCHITRAVE ELEVATION
SCALE 1:25@A3

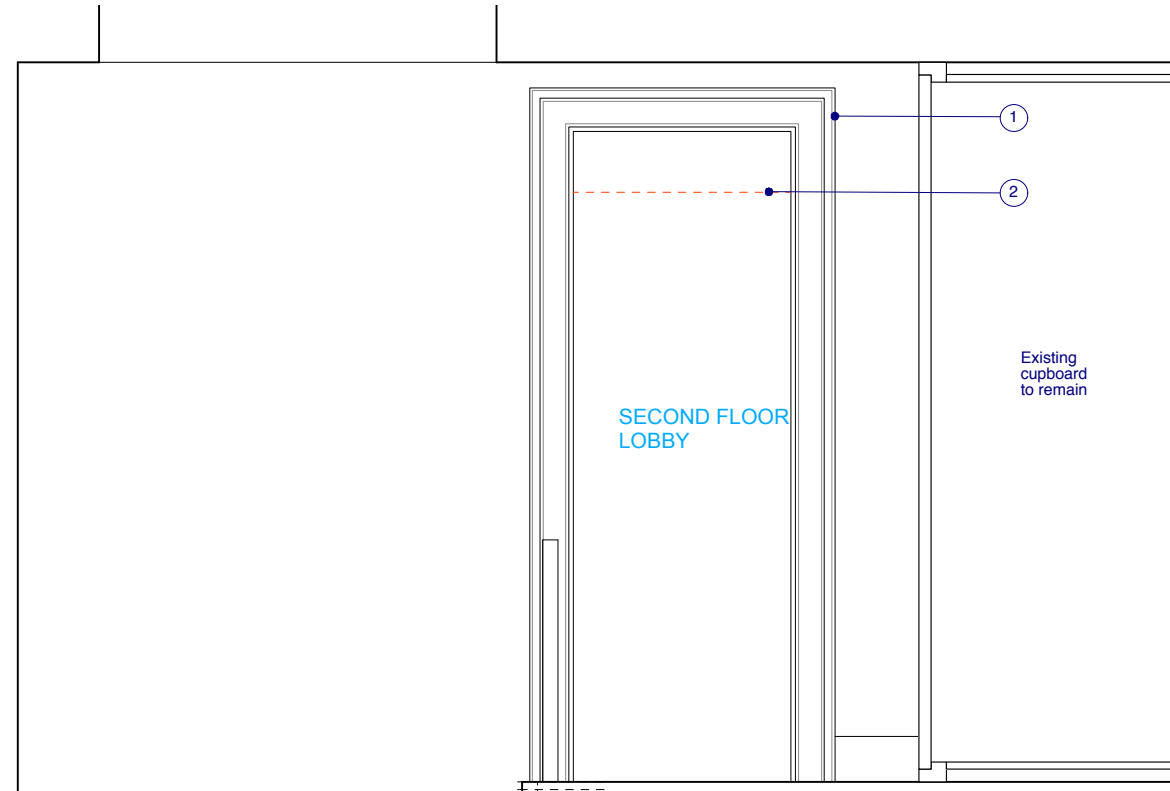

2 SECOND FLOOR - REAR BEDROOM 4 ENTRANCE - OPENING AND ARCHITRAVE ELEVATION
SCALE 1:25@A3

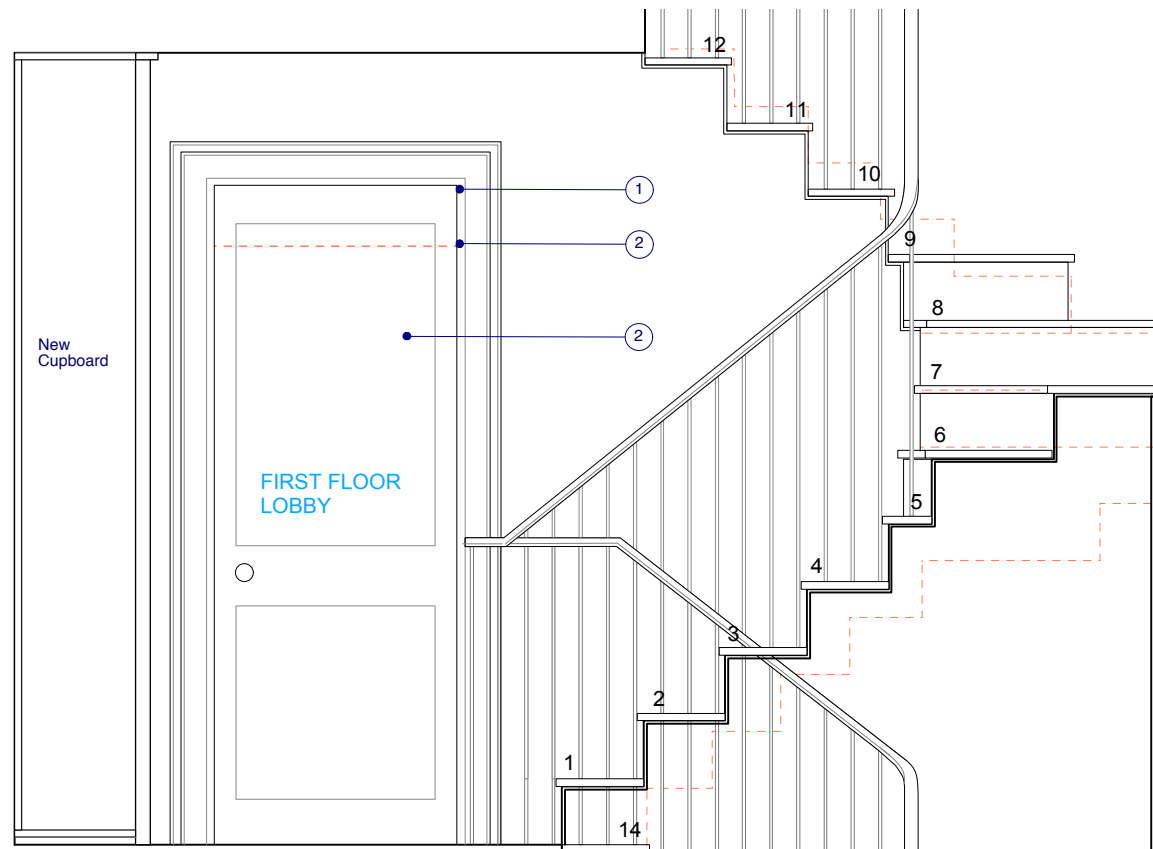

3 FIRST FLOOR - FRONT BEDROOM 2 ENTRANCE - DOOR AND ARCHITRAVE ELEVATION
SCALE 1:25@A3

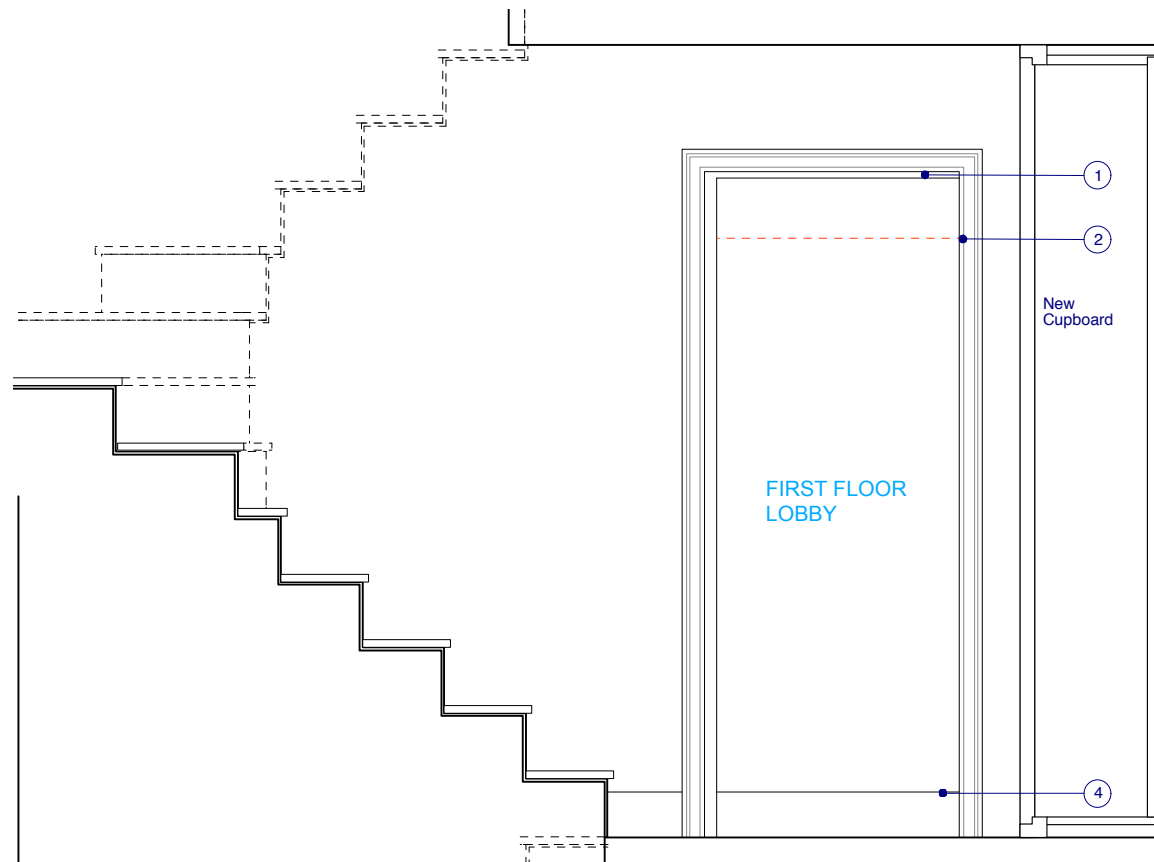

4 FIRST FLOOR - REAR BEDROOM 1 ENTRANCE - OPENING AND ARCHITRAVE ELEVATION
SCALE 1:25@A3



Notes:

All construction to comply with all relevant and current Buildings regulations and British Standards.
All dimensions are to be checked on site by the contractor prior to construction. Any queries are to be notified to the author of the drawing.
For all structural works information refer to Structural Engineers drawings.

Key:

--- Line of existing to be removed or altered

- ① Modify existing door architrave detail to accommodate taller opening. Architrave to match existing.
- ② Increased door head room by 200mm.
- ③ Panelled timber door to match existing
- ④ Raised step beyond opening

Rev P1 - 18.12.15 Issued for Planning

TRELLIK DESIGN STUDIO
UNIT 1A HAZELWOOD, GOLBORNE GARDENS
LONDON W10 5DT

T: +44 (0)7776 085694
E: HELLO@TRELLIKDESIGNSTUDIO.COM
W: WWW.TRELLIKDESIGNSTUDIO.COM

Client:
EDOUARD & ANNE-SOPHIE

Date Created:
SEPTEMBER 2015

Project:
66 LEIGHTON ROAD

Drawing Title:
PROPOSED DOOR ARCHITRAVE ELEVATIONS

Scale:
1:25

Revision Date:
18.12.15

Drawing No:
1502-P-201

Checked by:
NG

Revision:
P1

DO NOT SCALE FROM DRAWING, ALL DIMS TO BE CHECKED ON SITE. REPORT OMISSIONS AND DISCREPANCIES TO THE ARCHITECT IMMEDIATELY