

# Boward Oxford Ltd.

Tree Surgery | Surveying | Consultancy | Planting  
 TEL: 01993 880500  
 Email: boward.ox@btopenworld.com

E. Tree Protection Plan, 11 Rosslyn Hill,  
 London, NW3 5UL

SCALE : 1 : 700  
 DATE : 26/03/2015

MAP FILE REFERENCE :  
 Jinny Blom, Rosslyn Hill

Pear Technology Services Ltd. Email info@peartechnology.co.uk  
 Maps based on Ordnance Survey MasterMap or 1:25000 Mid-scale data

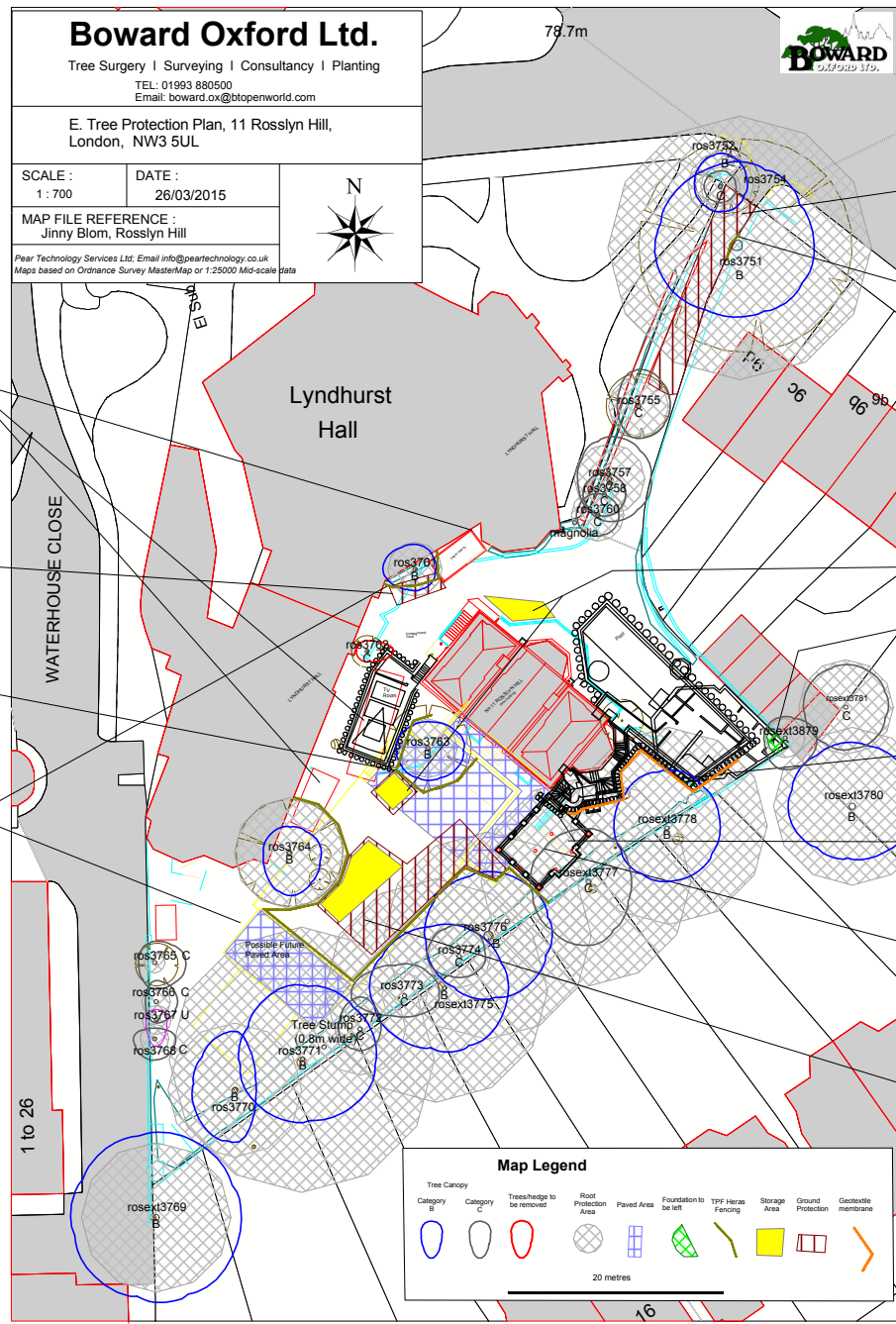

Out-buildings to be removed.

Ground protection (Terram).

Heras protection to be positioned around magnolia. Arrange as best as possible over level changes.

Heras tree protection (back braced) To be extended fully around the trees 3761 & 3764 once outbuildings demolished.

Ground protection along entranceway (TERRAM).

Heras tree protection without back bracing.

Potential storage area.

Guest house to be demolished. Small area of original foundation to be left 1m away from tree stem 3879.

Non-permeable geotextile membrane separating piles from soil.

Foundations of dining room to be laid on piles to north outside RPA being utilised by 3776/7778.

Location of 7 piles (in red) to be determined by hand digging and wells located where no roots are >25mm in diameter.

Ground protection with storage area.

**Map Legend**

	Tree Canopy Category B		Trees/hedge to be removed		Root Protection Area		Paved Area		Foundation to be left		TFF Heras Fencing		Storage Area		Ground Protection		Geotextile membrane
--	------------------------	--	---------------------------	--	----------------------	--	------------	--	-----------------------	--	-------------------	--	--------------	--	-------------------	--	---------------------

20 metres