



**Notes:**

- 
**Pret outdoor seating - 6no**  
 External 460x530mm aluminium frame (black) and teak slatted chair
- 
**Pret outdoor seating - 3no**  
 External 460x530mm aluminium frame (grey) and teak slatted chair
- 
**Square tables - 9no**  
 External 500x500mm aluminium 12mm thick table top with aluminium base

**note: external furniture to be brought into store outside of trading hours**

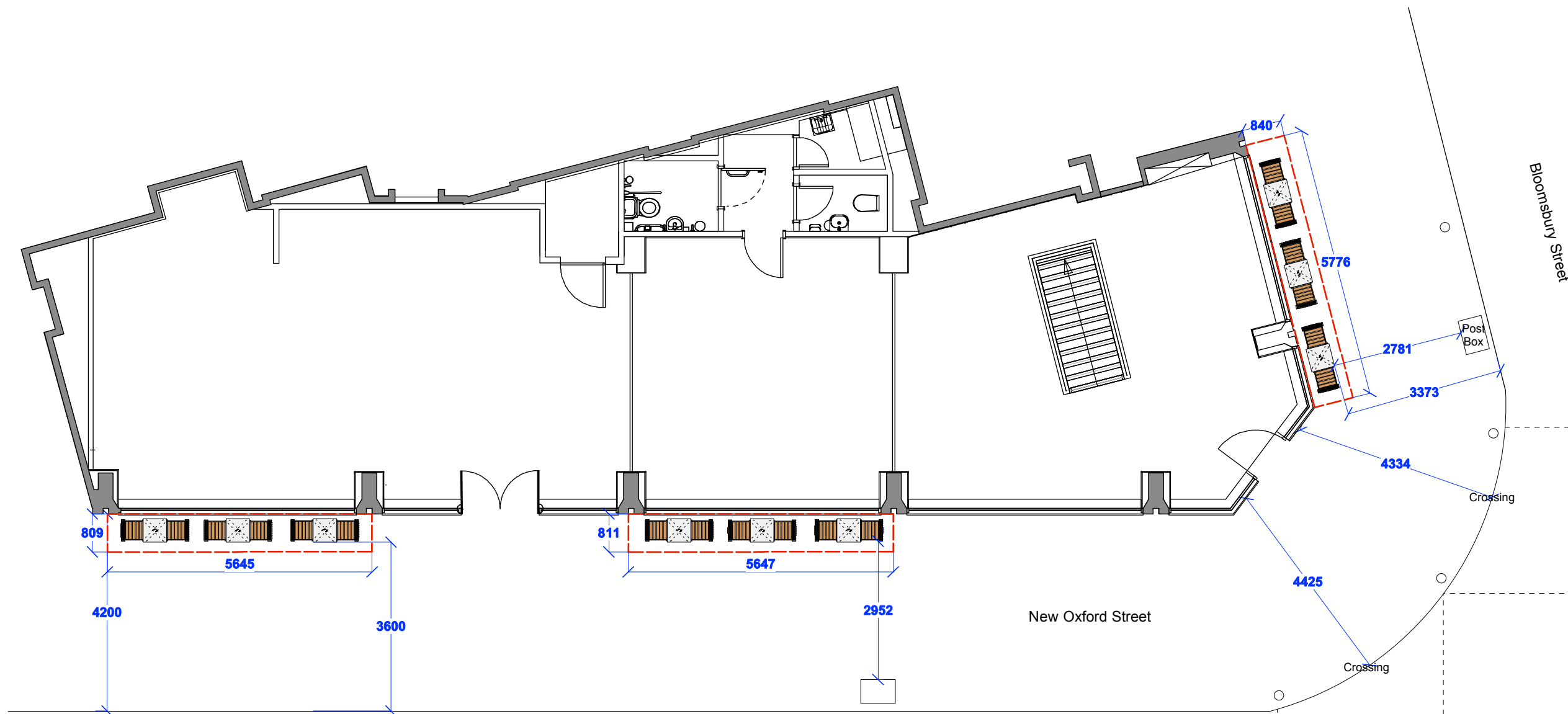

External Seating Layout

**For Approval**

**★ PRET A MANGER ★**  
 1 Hudson Place, London, SW1V 1PZ

Site: **64 - 76 New Oxford Street**

Title: External Seating

Rev: Date: Drawn By:  
 A 12.10.15 LJB  
 As discussed  
 B 11.12.15 LJB  
 External Elements

Dwg No. NEWOX-Pret-01

Date: 03.08.11	Revision: B
Scale: 1:100 @ A3	Drawn By: FS

**THIS DRAWING IS NOT TO BE SCALED**  
 Figured dimensions only to be used. This drawing is subject to and protected by the provision of the copyrights acts. Any discrepancies or queries to be notified immediately. All dimensions to be verified on site.  
 © PRET A MANGER (EUROPE) LTD 2004