

FIRST

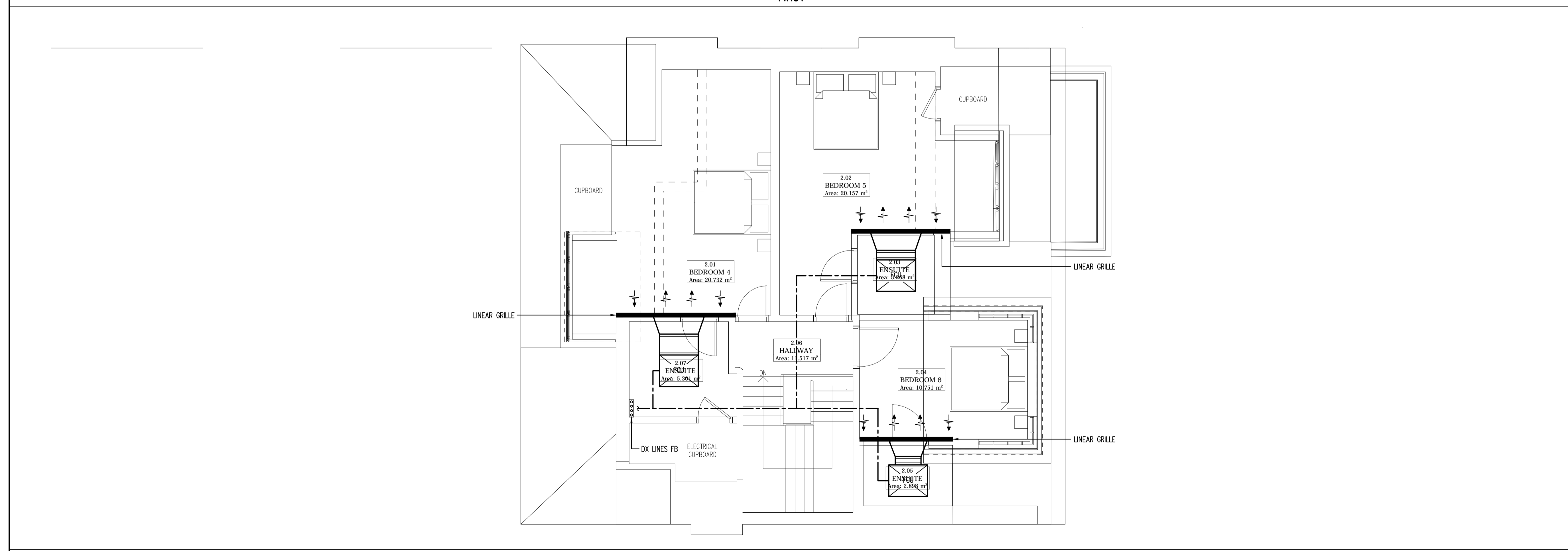

SECOND

Note
ALL DIMENSIONS TO BE VERIFIED ON SITE BEFORE SETTING OUT OR MAKING ANY SHOP DRAWINGS. THIS DRAWING IS TO BE READ IN CONJUNCTION WITH THE CONSULTANT ENGINEER'S SPECIFICATION.

Orientation

Rev./Date	REVISIONS
P 22.06.15	PRELIMINARY ISSUE
P1 06.07.15	PLANNING ISSUE
P2 24.07.15	UPDATED PLANNING ISSUE

ME7

ME7 Ltd.
Unit 2, Rays Farm Barns, Roman Road
Ingatestone, Essex CM4 9EH
Email: jb@me7.eu
Web: www.me7.eu
Tel: +44(0)1277 353225
M&E Consultants Energy Consultants



Description
FIRST & SECOND FLOOR COOLING

Project
9 HARLEY ROAD LONDON NW3 3BX

Architect
SHH Architects
1 Vencourt Place
Ravenscourt Park
Hammersmith, London, W6 9NU
Tel: 0208 600 4171

Scale
A1 @ 1:50 A3 @ 1:100
Date
June 2015

Drawn
JB / CA
Checked

Issue
PRELIMINARY

Project No.	Services	Dwg No.	Rev.
607	M	3	P2

First & Second