

Information contained within this drawing is the sole copyright of HDDA Ltd. and is not to be reproduced without express permission. No implied licence exists. This drawing not to be used for land transfer or valuation purposes. Do not scale from this drawing. All dimensions & levels are to be checked on site by the contractor. Issued for purposes indicated only. Drawing errors and omissions to be reported to the architect.

Notes

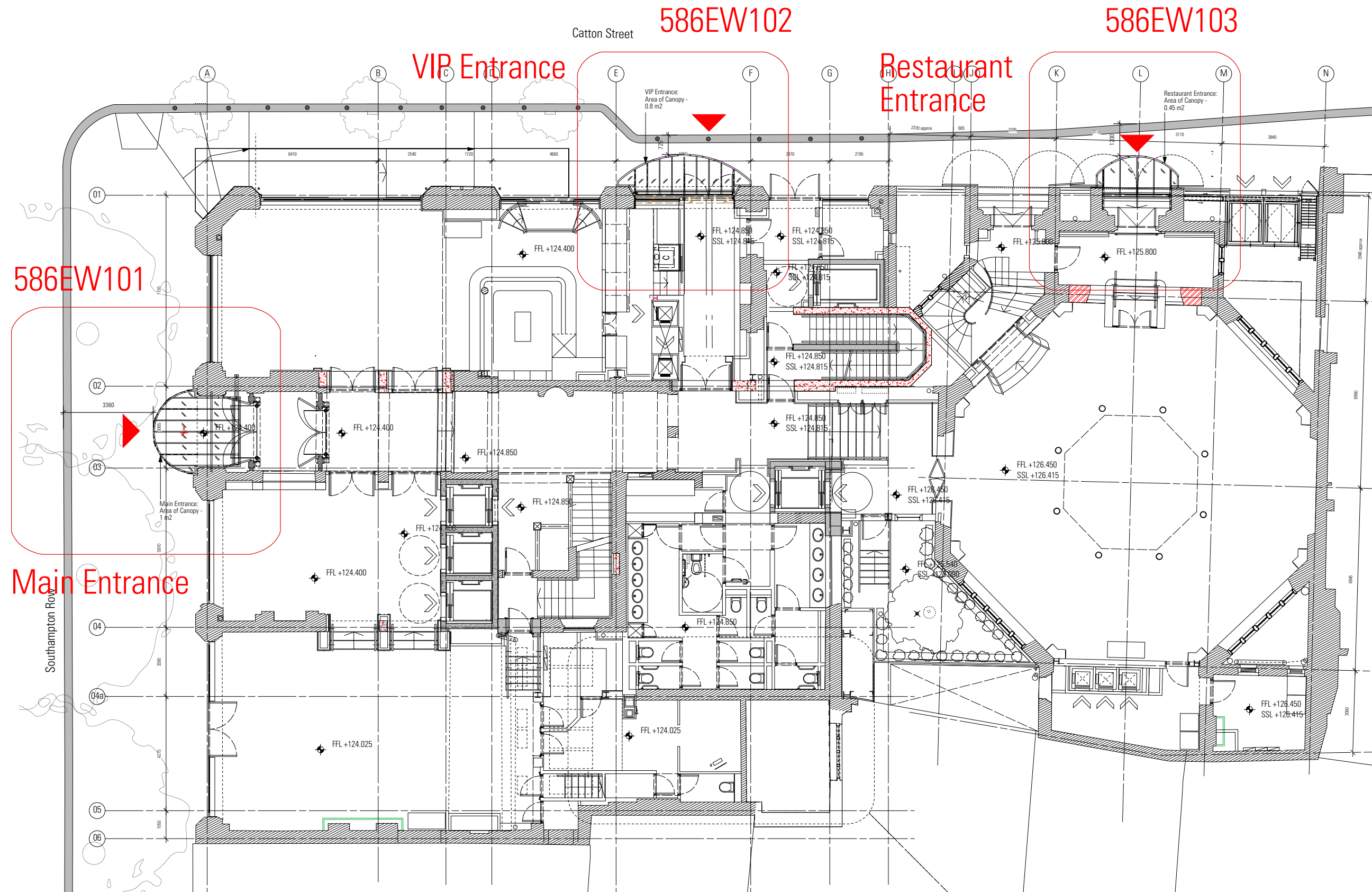

- P1 01/12/15 Issued for planning
- C1 16/10/15 Issued for Construction (VIP Entrance, Restaurant Entrance canopies extended)
- I1 29/09/15 Issued for Information

Revisions

Revision	Description
P1	01/12/15 Issued for planning
C1	16/10/15 Issued for Construction (VIP Entrance, Restaurant Entrance canopies extended)
I1	29/09/15 Issued for Information

PLANNING

**HARPER  
DOWNIE**  
CREATIVE  
ARCHITECTURE

Gate House  
1 St. John's Square  
London EC1M 4DH  
T +44 20 7490 7674  
studio@harperdownie.com  
www.harperdownie.com

Client: Havza Ltd  
Project: 2-6 Southampton Row

Drawing Title: Design Intent for Canopy Entrance Key Plan

Status	Drawn	Checked
Planning	IG	MM
Scale	Date	
A1 - 1:25, A3 - 1:50	Sept 2015	
Drwg. No.	Revision	
586EW100	P1	

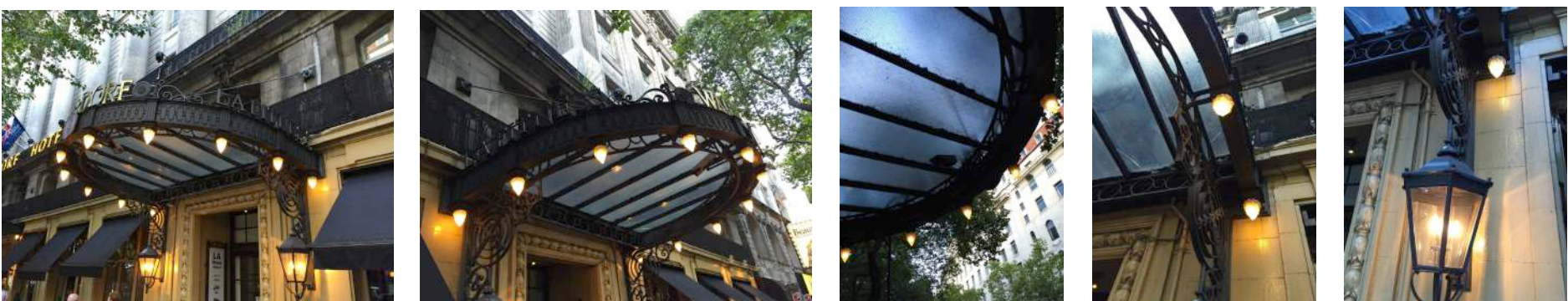

Precedent Images  
Design Intent Base  
Waldorf Hotel Entrance

Entrance Key  
Plan View