



Notes

1. This drawing has been prepared in accordance with the scope of RPS's appointment with its client and is subject to the terms and conditions of that appointment. RPS accepts no liability for any use of this document other than by its client and only for the purposes for which it was prepared and provided.
2. If received electronically it is the recipients responsibility to print to correct scale. Only written dimensions should be used.

EXISTING

Site boundary

PROPOSED

-  Sedum 'Naturemat' as Q37/ 440A;
- Sedum acre 'Aureum'
- Sedum album
- Sedum reflexum
- Sedum hispanicum glaucum
- Sedum lydium
- Sedum sexangulare
-  Hedgerow planting in raised planter as Q50/ 210
-  Extent of Green (Living) Wall as Q37/ 125

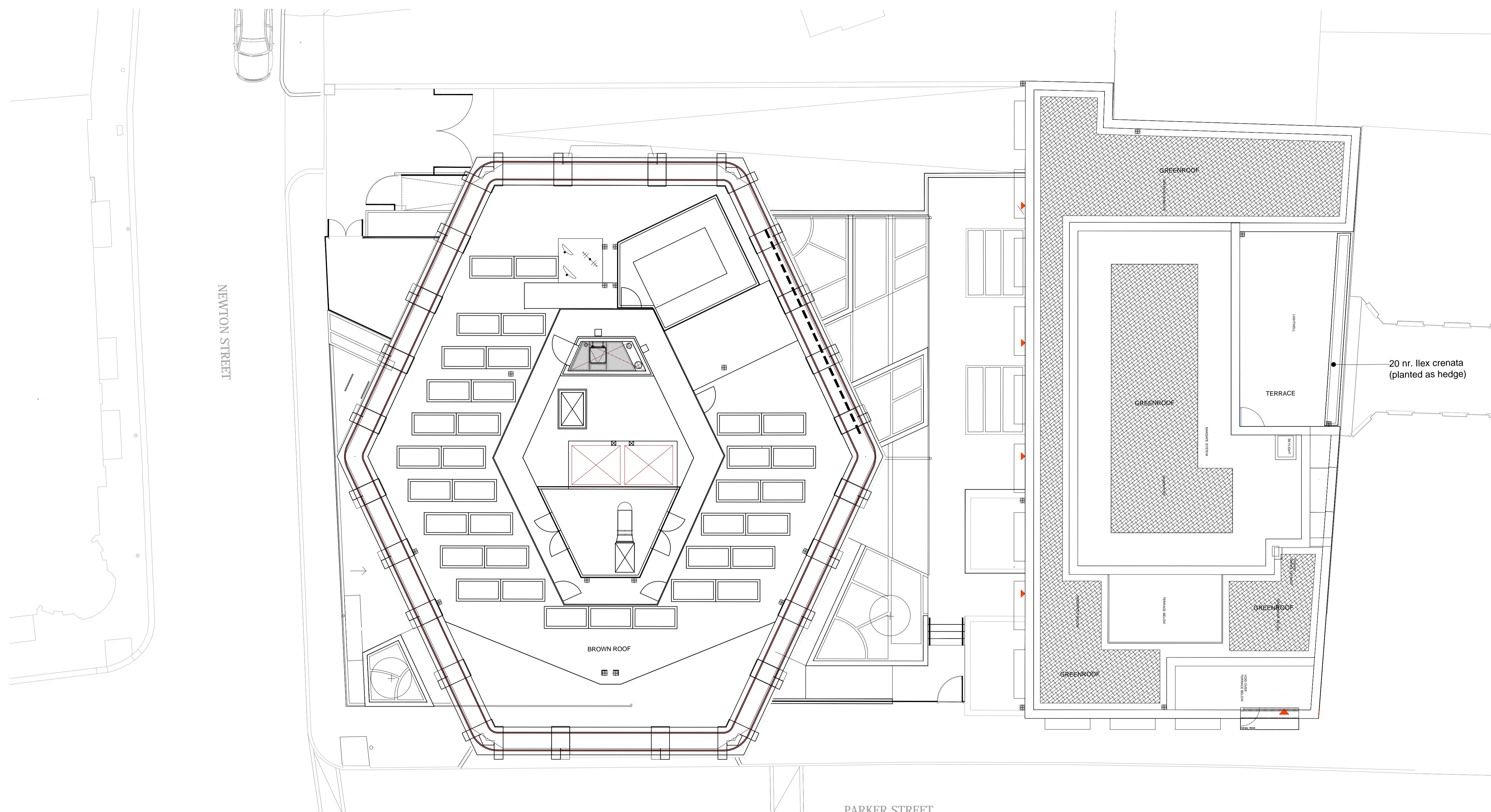

20 nr. Ilex crenata
(planted as hedge)

Rev	Description	Date	Initial	Checked
A	Paving removed	16:11:15	NJ	

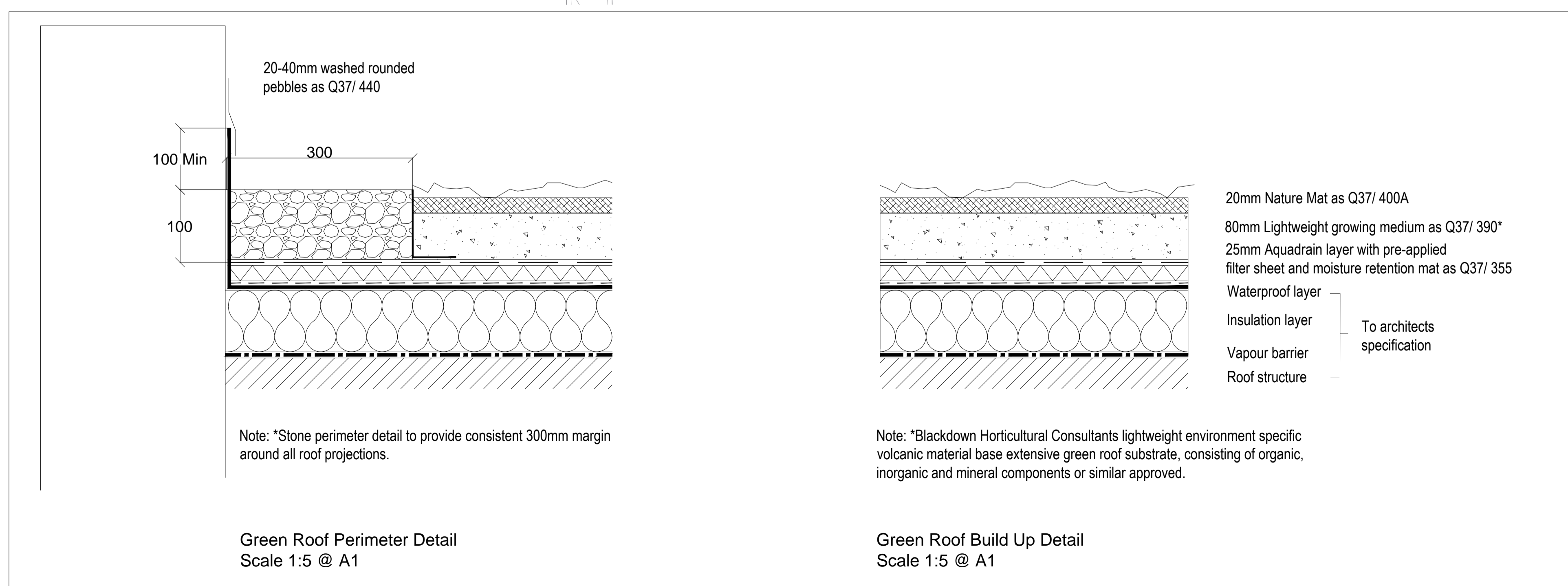

Lakesbury House, Hittingbury Road, Chandlers Ford, Hampshire, SO53 5SS
T: +44(0)2380 810 440 E: rpsso@rpsgroup.com F: +44(0)2380 810 449

Client BNP Paribas Real Estate
Project Parker Tower London
Title Planting Proposals Roof Scope

Status For Planning
Job Ref JSL2545
Drawn By NJ
Scale @ A1
1:100
PM/Checked by CT
Date Created 24/10/2015

Drawing Number 501
Rev A