

**DISCLAIMER:**

- 1 - Do not scale off this drawing. All dimensions should be checked on site by the Contractor prior to commencement of works. Any discrepancies are to be reported to the Architect immediately.
- 2 - This drawing is to be read in conjunction with all Architects drawings and specifications.
- 3 - This drawing is to be read in conjunction with all Structural Engineers drawings and specifications.
- 4 - This drawing is to be read in conjunction with all Service Engineers drawings and specifications.
- 5 - If in doubt, seek clarification with Architect.
- 6 - All works must comply with the Building Regulation 2000 and subsequent modifications and Local Authority Bylaws. No material to be used or method of workmanship employed unless conformity with the current relevant British Standards is ensured.
- 7 - This drawing and its contents remain the copyright of Francesco Pierazzi Architects.

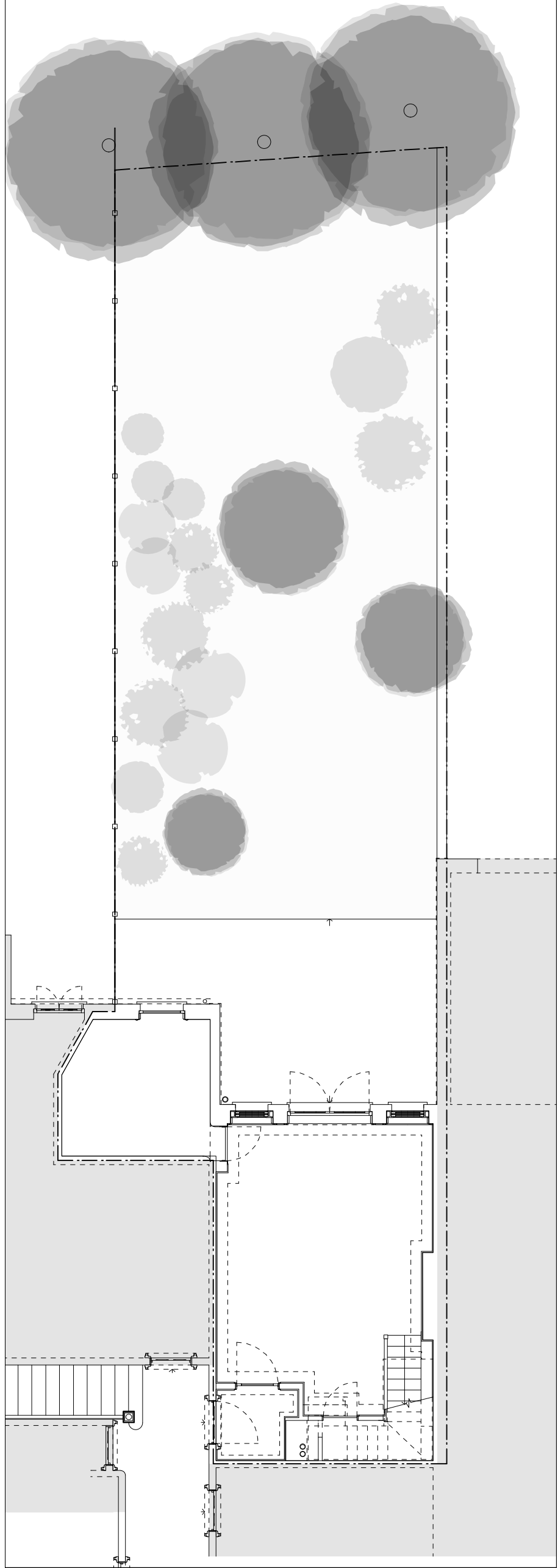

**SITE PLAN  
AS EXISTING  
SCALE 1:100 @ A3**

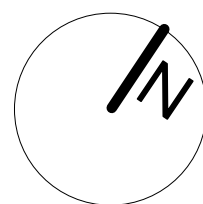

DATE		
BY		
CHECKED		
APPROVED		
DATE		
BY		
CHECKED		
APPROVED		
DATE		
BY		

**DEVELOPED  
DESIGN  
PLANNING**

**SITE PLAN  
AS EXISTING**

Drawing number: **199** Revision: **07\_DD**

Scale: **1:100 @ A3** Date: **18th NOV 2015** Drawn by: **F.P.** Approved by: **F.P.**

Detailed description: **GROUND FLOOR REAR EXTENSION AND INTERNAL ALTERATIONS**  
Address: **FLAT 3, 70 GREENCROFT GARDENS LONDON, NW6 5JQ**  
Client: **JENNY TE AND OSCAR CHOI**

**FRANCESCO PIERAZZI**  
Architects

186 Pullman Court, Streatham Hill  
London, SW2 4TA, United Kingdom  
T: +44 (0)20 86209378  
M: +44 (0)7944 180967

office@fparchitects.london  
www.fparchitects.london

