

SCALE BAR ~ Meters

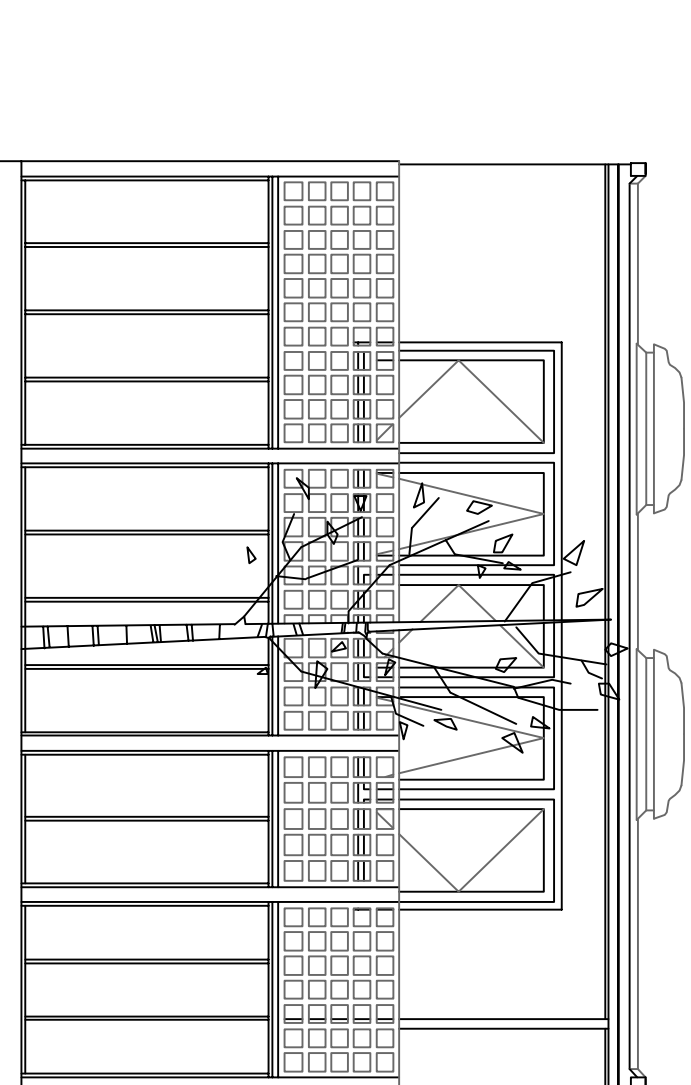

Existing timber panel fence 1.7m high above wall with 0.8m tall square trellis on top giving a total height of 2.5m above wall along rear boundary and garden of 34 Hillfield Road

REAR ELEVATION

From rear of
34 Hillfield Road
ENGLISH IW

Hedera helix – English ivy can be used to cover a wall in shade where few other plants thrive, it can be trained to climb up or spread out along a low wall. Being evergreen, it is perfect for covering pergola poles, or creating a leafy backdrop under clematis and climbing roses that provides winter interest. English ivy can be trimmed into shape at any time of year. It is a valuable plant for wildlife and is recommended by the RSPB and loved by Bill Oddie, particularly for providing berries for birds in winter when most others have been eaten. Many insects also feed on the nectar of its white flowers. Be careful when handling it if you have sensitive skin as its sap can be irritating.

Skill Level: Beginner

Exposure: Full sun, Partial shade, Shade

Hardiness: Hardy

Soil type: Well-drained/light, Clay/heavy, Acidic, Chalky/alkaline, Dry, Sandy
Height: 100cm – unsupported 200–300cm supported – Width: 75–100cm

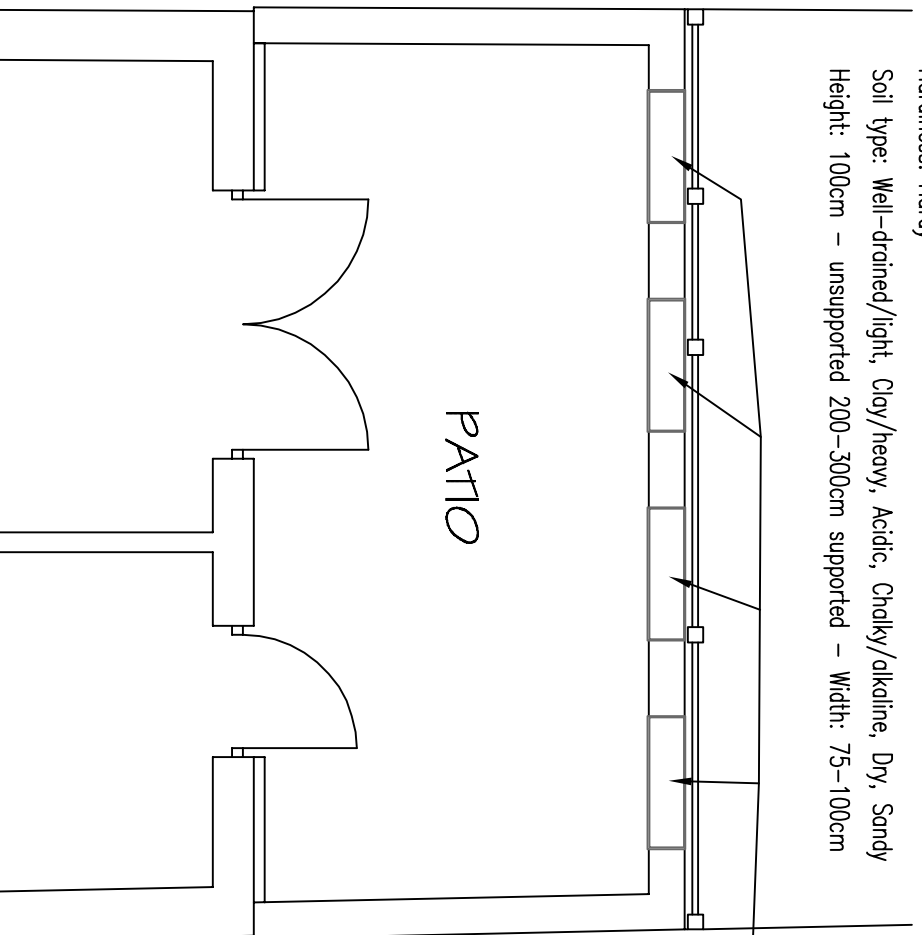

English ivy to be planted in 4no containers at top of rear boundary retaining wall and allowed to grow up fence and trellis to form an evergreen screen. One plant from 9 litre pot in each container

REV B – Planting containers and plant size revised 30/11/2015

following site meeting with LPA landscape officer & Wilson Lloyd Landscaping
REV A – Size & spacing of plants together with expectant growth within a short time frame 17/11/2015

Architectural Design & Planning

32 Grange Road
Plymouth PL7 2HY

t: 01752 341696
f: 01752 342503

TITLE PROPOSED LANDSCAPING
CONDITION DRAWING (1 of 22)

ADDRESS
33c MILL LANE
LONDON NW6 1NZ

CLIENT
COBSTAR Ltd

SCALE 1:50 DATE OCTOBER 2015

DRAWING No. 12124/LC/01 REV. B

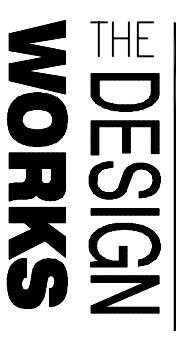

Pt LOWER GROUND
FLOOR PLAN