

NOTES

- 1.Existing Lighting Circuit to be modified to suit new layout.
- 2.Emergency Lighting to be in accordance with BS 5266-2011

LEGEND

- M32 MODULAY LED; 3200 DALI 4K
EATON LIGHTING CAT No.-AB-MLL66324K00
- M38 MODULAY LED; 3800 DALI 4K
EATON LIGHTING CAT No.-AB-MLL66384K00
- E MICROPPOINT 2 ACCESSED 3H MTD ESCAPE
EMERGENCY CAT No.-AB-MP203HP
- P 360 DEG. DEGREE LIGHTING PIR
- SUSPENDED LED - TBC

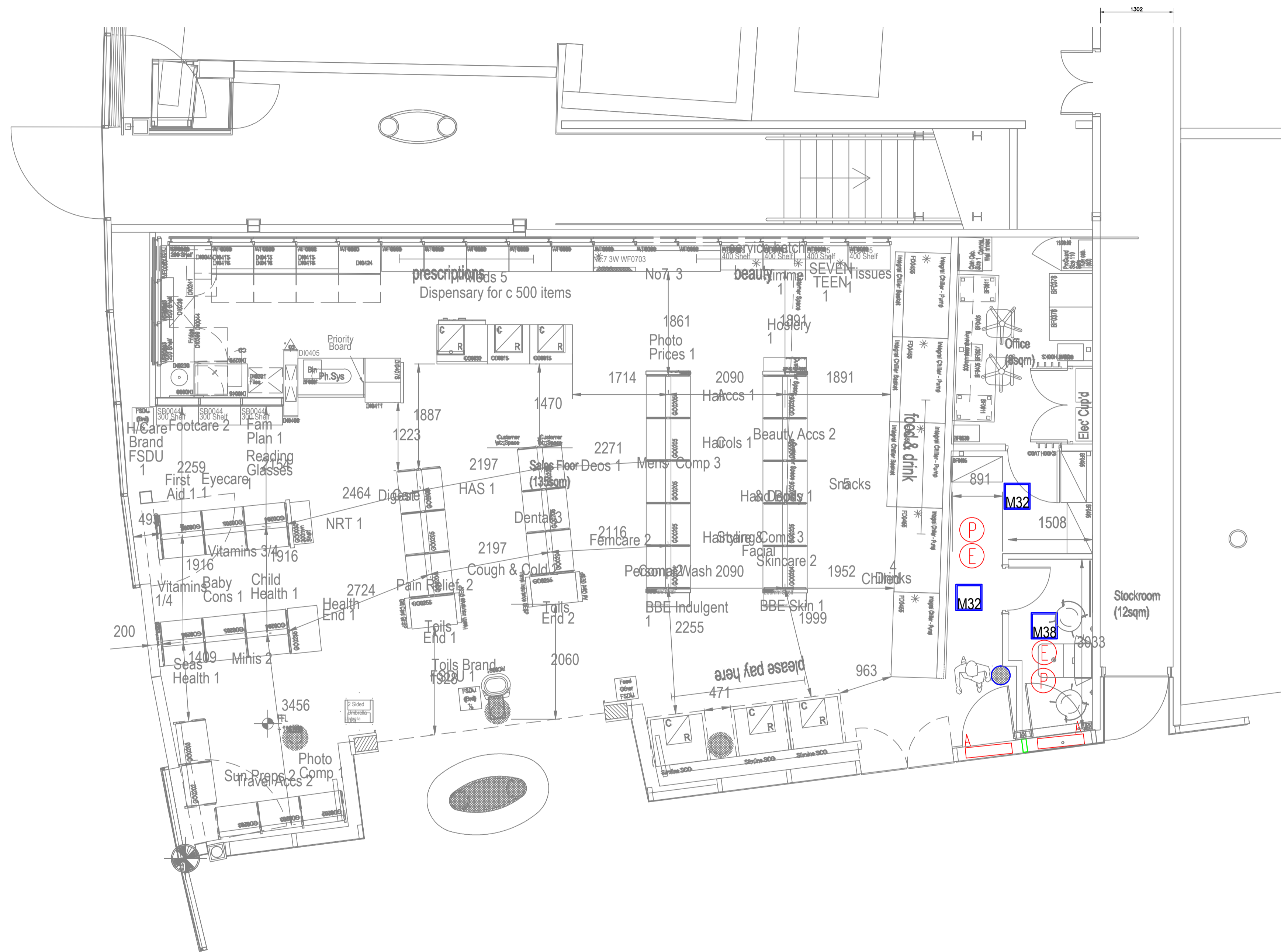

1	SEP.15	AS INSTALLED
Rev.	Date:	Description:

J.M.SCULLY Ltd

J M Scully Ltd
10, Wimborne Road,
Walford, Wimborne,
Dorset, BH21 1NN
Tel: 01202 843700
Fax: 01202 843727

Project:
**BOOTS STORE 1126
GROUND FLOOR
KINGS CROSS STATION**

Drawing Title:
**GROUND FLOOR
LIGHTING MODIFICATIONS
INTERVENTION 2015**

Scale: 1:50 @ A1 Date: 21.08.15

Drawn: JMS-TH Checked: JMS-CS

Drawing Status: FOR APPROVAL Revision: 0

Drawing No. JMS-1126-301