

0 0.5 1 2

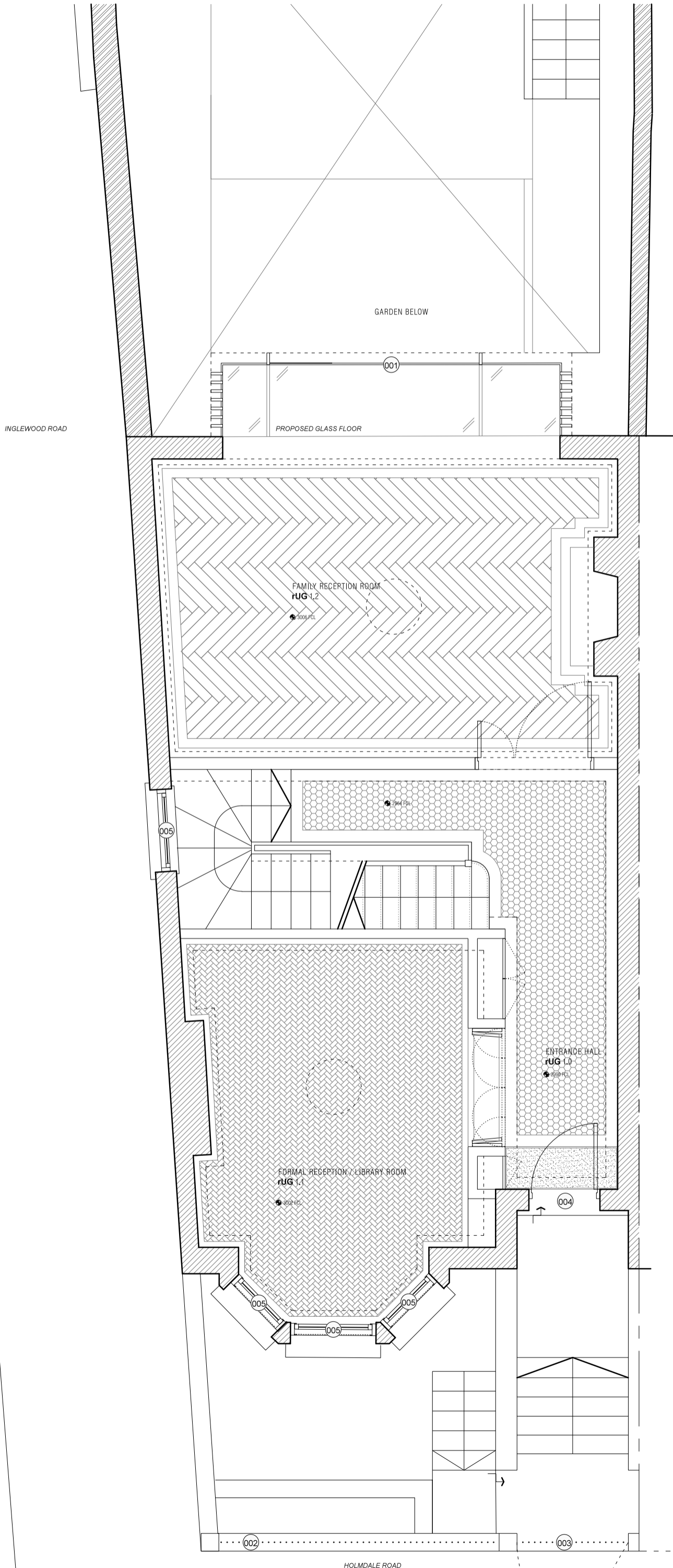

NOTES

ALL SETTING-OUT TO BE CONFIRMED ON SITE WITH ARCHITECT DRAWINGS TO BE READ IN CONJUNCTION WITH STRUCTURAL ENGINEER'S DRAWINGS

- 001 PROPOSED NEW ORIEL IN GLASS AND TIMBER
- 002 PROPOSED NEW RAILINGS
- 003 PROPOSED NEW GATE IN TRADITIONAL STYLE
- 004 PROPOSED NEW SOLID TIMBER FRONT DOOR TO MATCH TRADITIONAL DETAILING / STYLE
- 005 PROPOSED NEW DOUBLE GLAZED TIMBER SLIDING SASH WINDOWS TO MATCH TRADITIONAL DETAILING / STYLE

MARTYN CLARKE ARCHITECTURE LTD
 78 CROUCH HILL
 LONDON N8 9EE
 020 7263 7121
 info@martynclearchitecture.com

Project	Suhail & Kelsey Shaikh 11 Holmdale Road London, NW6 1BE	Project No. 6228
---------	---	----------------------------

Date	SEPTEMBER 2015	Drawing No.
Scale / Format	1:50 @ A3	6228_03_009

Drawing Name	PROPOSED UPPER GROUND FLOOR	PLANNING
Revision	-	