





CONSTRUCTION KEY

-  existing retained
-  line over/under/behind
-  demolished
-  new construction



NOTE:
 External and party walls – to be surveyed by damp proofing specialist and areas of dampness re-injected & re-plastered. All skirtings to be renewed to match existing.
 Existing, non fire-rated flush internal doors to be replaced with solid timber flush fire doors.

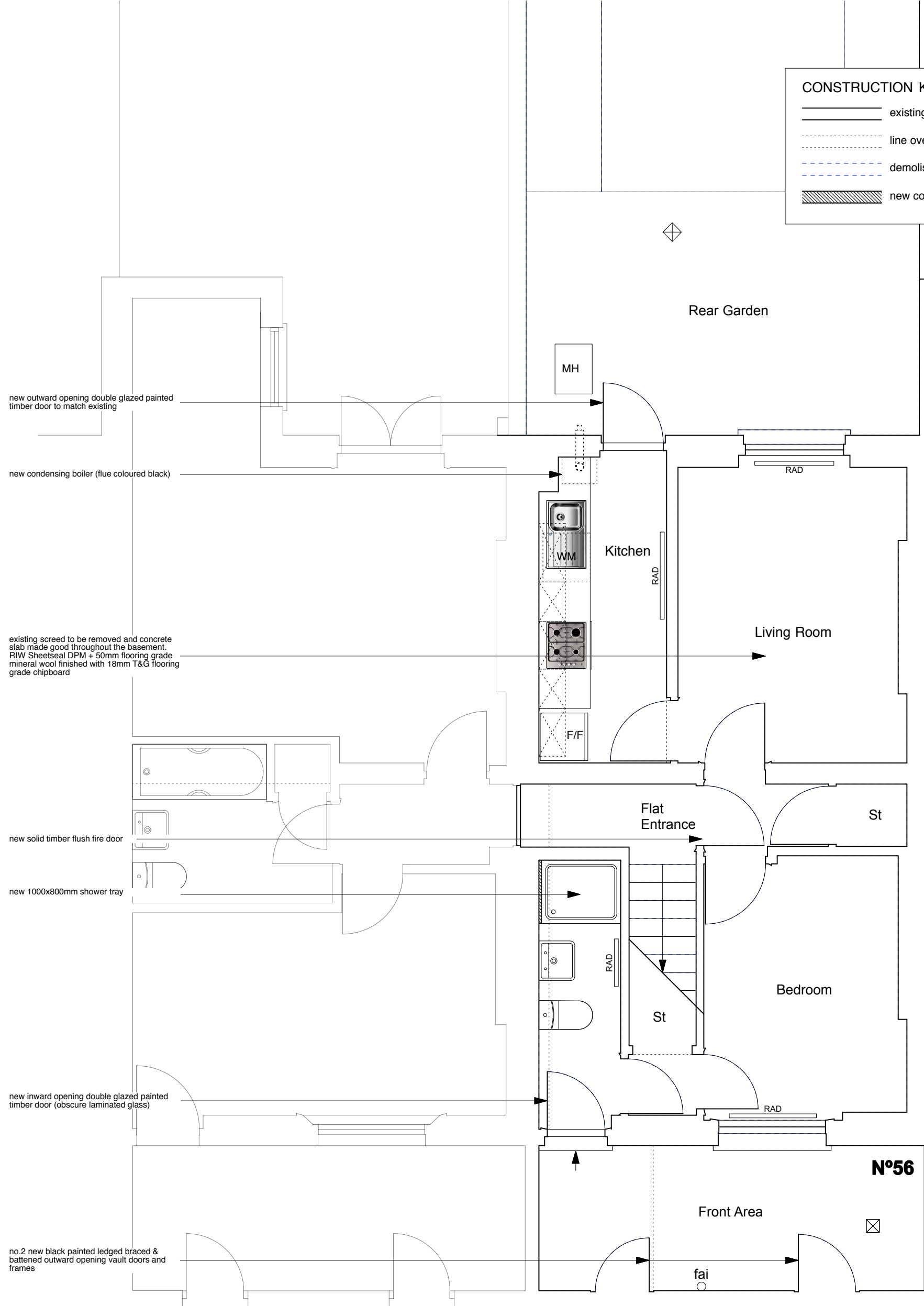

	PROJECT 5 ARCHITECTURE LLP 8 Waterson Street London E2 8HL T: +44 (0)20 7739 9131 F: +44 (0)20 7739 3687 E: info@p5a.co.uk	job title 56-58 FREDERICK STREET, LONDON WC1X 0ND	1:50 @ A3	drawn SA	drawing no. 6214-FS56+58-P01
	drawing BASEMENT PLAN - PROPOSED	date JUNE 2015	checked XX	RH Unit	