

All dimensions to be verified on site by Main Contractor before the start of any shop drawings or work whatsoever either on their own behalf or that of sub-contractors.

Report any discrepancies to the Contract Administrator at once.
This drawing is to be read with all relevant Architect's and Engineer's drawings and other relevant information.

© Ingleton Wood LLP

Notes: DO NOT SCALE

- Do not scale from this drawing.
- All dimensions are in millimeters unless stated.
- This drawing is to be read in conjunction with all other Drawings and Specifications.
- Any discrepancies to be referred to the engineer.
- This installation is to be co-ordinated with all other trades and existing site installations.
- All dimensions to be checked and verified on site prior to the commencement of the works.

Legend:

- Pipework runs Under Floor
- Pipework runs at Low Level
- Pipework runs at High Level
- Pipework runs in Ceiling Void
- H/L High Level
- L/L Low Level
- TB To Below
- FB From Below
- TA To Above
- F&R Flow & Return

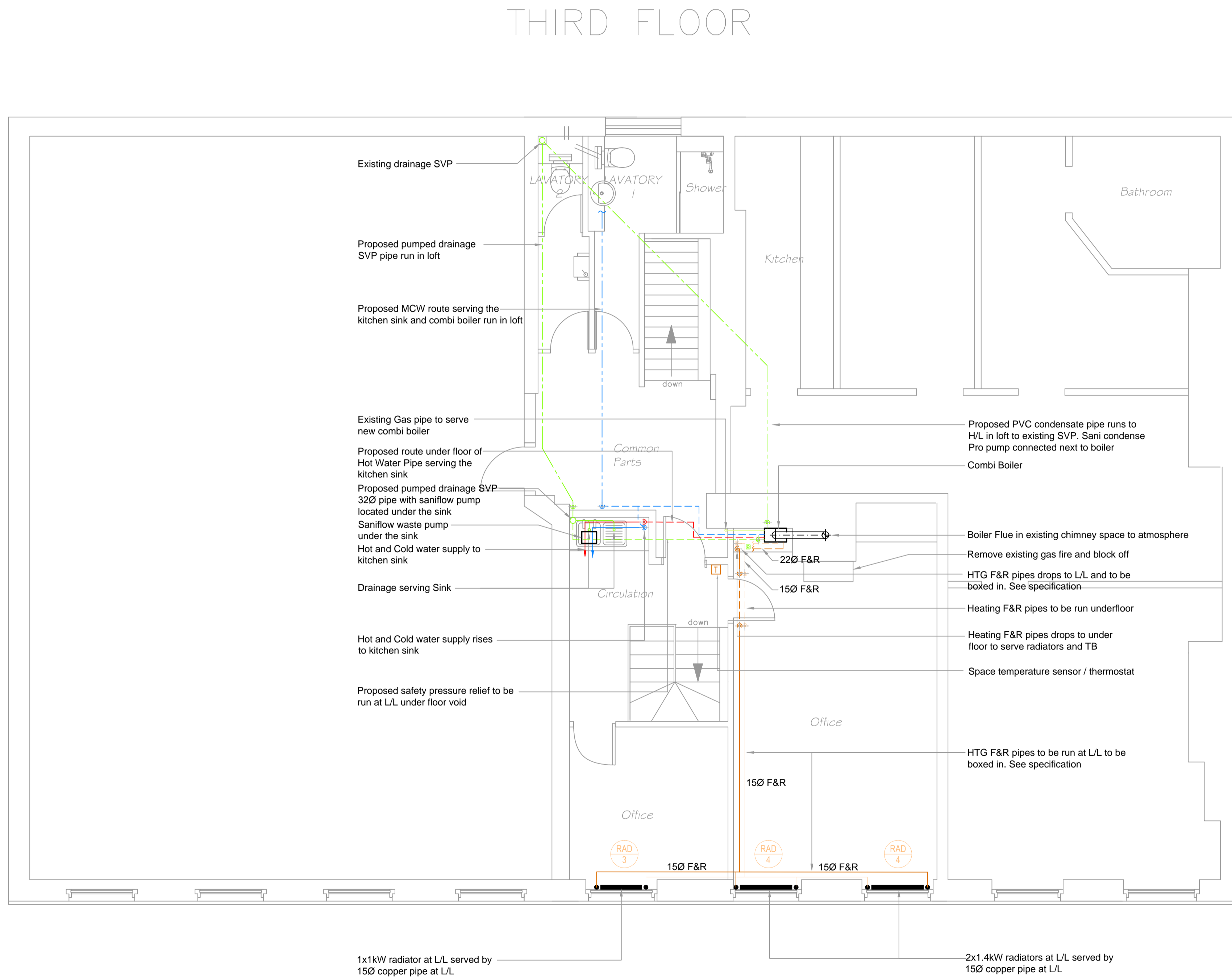

Rad Ref	Location	Casing Size (mm)			No.	Rad Type	Actual Output (Watts)	Flow Rate (l/s)
		L	H	D				
R1	Office (2nd.floor)	585	599	138	1	MHS Multiseq 3 Column Radiators MS-NMF-0500-3-13	844	
R2	Office (2nd.floor)	945	599	138	2	MS-NMF-0500-3-21	1364	
R3	Office (3rd.floor)	765	599	138	1	MS-NMF-0500-3-17	1105	
R4	Office (3rd.floor)	945	599	138	2	MS-NMF-0500-3-21	1364	
R5	Office (2nd.floor)	585	599	138	1	MHS Multiseq 3 Column Radiators MS-NMF-0500-3-13	844	

Revision:	Date:	Description:	Drw:	Chk:
P1	09.10.15	Preliminary	DH	IF



London
1 Alie Street
London E1 8DE
T: 020 7680 4400
www.ingletonwood.co.uk

Project: 1 New Square, Lincoln's Inn, Newman's Row, London, WC2A 3TL

Drawing Title: Third Floor Mechanical Services Layout

Client: The Honourable Society of Lincoln's Inn

Drawn:	Checked:	Date:	Scale:	Paper Size:
DH	IF	02.10.15	1:50	A1
Job No.:	Dwg No.:	Stage:	Revision:	
84963	421	Preliminary	P1	