

- Notes: DO NOT SCALE
- Do not scale from this drawing.
  - All dimensions are in millimeters unless stated.
  - This drawing is to be read in conjunction with all other Drawings and Specifications.
  - Any discrepancies to be referred to the engineer.
  - This installation is to be co-ordinated with all other trades and existing site installations.
  - All dimensions to be checked and verified on site prior to the commencement of the works.

- Legend:
- Pipework runs Under Floor
  - Pipework runs at Low Level
  - Pipework runs at High Level
  - Pipework runs in Ceiling Void
- H/L High Level  
L/L Low Level  
TB To Below  
FB From Below  
TA To Above  
F&R Flow & Return

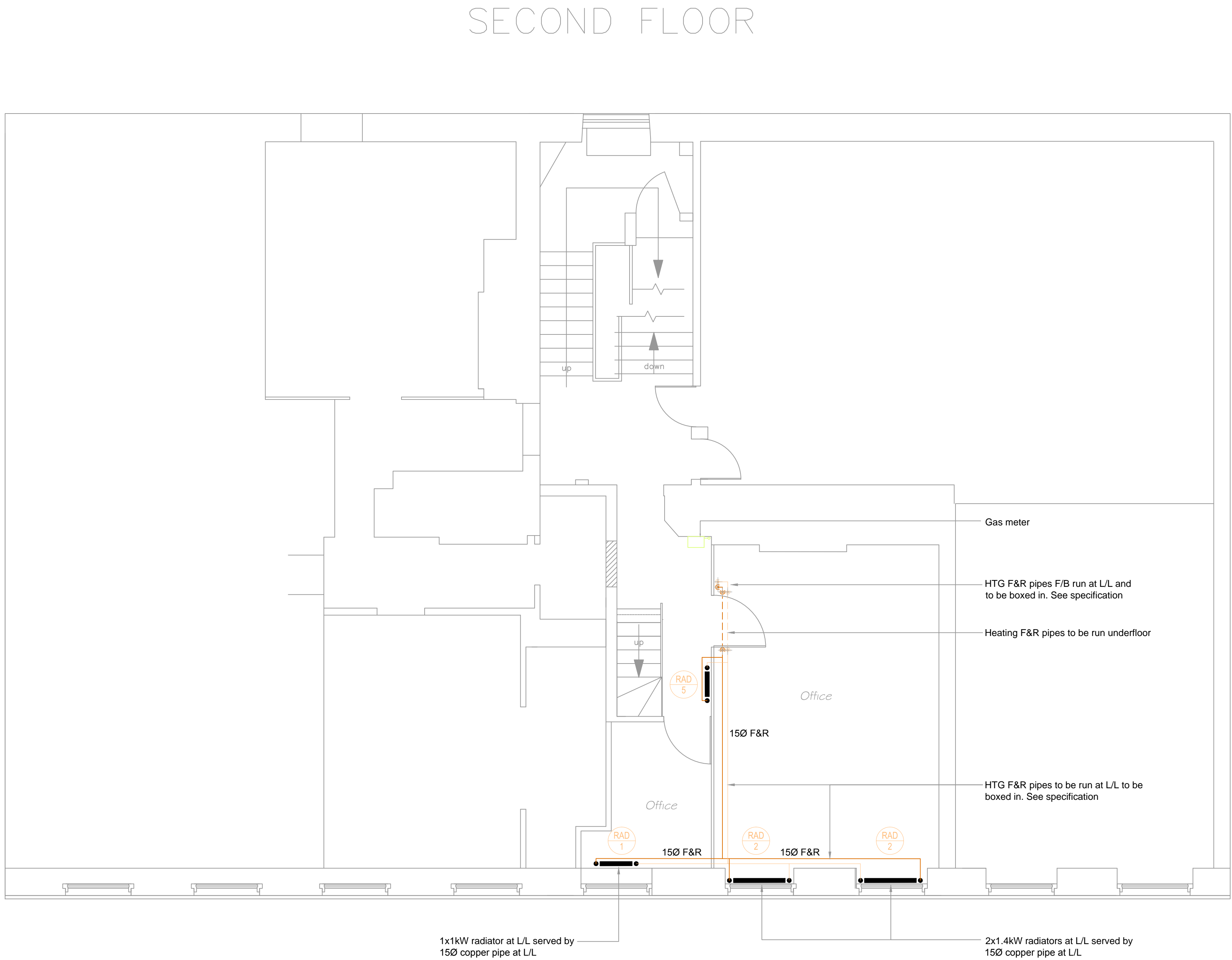

| Rad Ref | Location           | Casing Size (mm) |     |     | No. | Rad Type   | Actual Output (Watts) | Flow Rate (l/s) |
|---------|--------------------|------------------|-----|-----|-----|--|-----------------------|-----------------|
|         |                    | L                | H   | D   |     |  |                       |                 |
| R1      | Office (2nd.floor) | 585              | 599 | 138 | 1   | MHS Multisec 3 Column Radiators MS-NMF-0500-3-13 | 844                   |                 |
| R2      | Office (2nd.floor) | 945              | 599 | 138 | 2   | MS-NMF-0500-3-21                                 | 1364                  |                 |
| R3      | Office (3rd.floor) | 765              | 599 | 138 | 1   | MS-NMF-0500-3-17                                 | 1105                  |                 |
| R4      | Office (3rd.floor) | 945              | 599 | 138 | 2   | MS-NMF-0500-3-21                                 | 1364                  |                 |
| R5      | Office (2nd.floor) | 585              | 599 | 138 | 1   | MHS Multisec 3 Column Radiators MS-NMF-0500-3-13 | 844                   |                 |