

Baths

Grafton Arms (PH)

PRINCE OF WALES ROAD 30.3m

HEALEY STREET

N CRESCENT

REAR EXTENSION

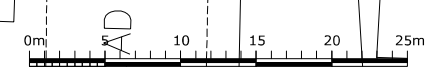
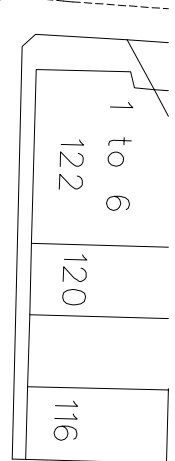

Rev Date Note

Services
Built

Structures
Fluid Structures

Client **Nicole Verity & Nadav Kander**

Project title
29 Prince Of Wales Road

Drawing Title
Context Plan Proposed

Scale 1:500 @ A3

Project No. 191	Drawing no. 1108	Revision P1
---------------------------	----------------------------	-----------------------

Status Planning	Date of Issue 02.12.13
---------------------------	----------------------------------



Clive Sall Architecture Ltd.

2 Providence Yard
Ezra Street
London E2 7RJ

Copyright CLIVE SALL ARCHITECTURE LTD