

Note:

Existing architecture and features to be restored/ repaired or replaced throughout in accordance with Grade 2 listing guidance - unless otherwise specified.

All obsolete services to be removed and essential services to be concealed as much as possible. New services to be as invisible as possible.

Grey marble seafood bar with bronze trims and a glass display. LED lighting for display, below counter level and at skirting level.

White Marble bar - Plain & fluted white cararra marble with bronze trims. LED lighting below counter level and at skirting level.

Timber cabinet for storing / displaying wine. Glass shelves with lip detail to retain bottles - Internally lit Sliding glass doors.

Wine display system to be proposed by contractor & discussed.

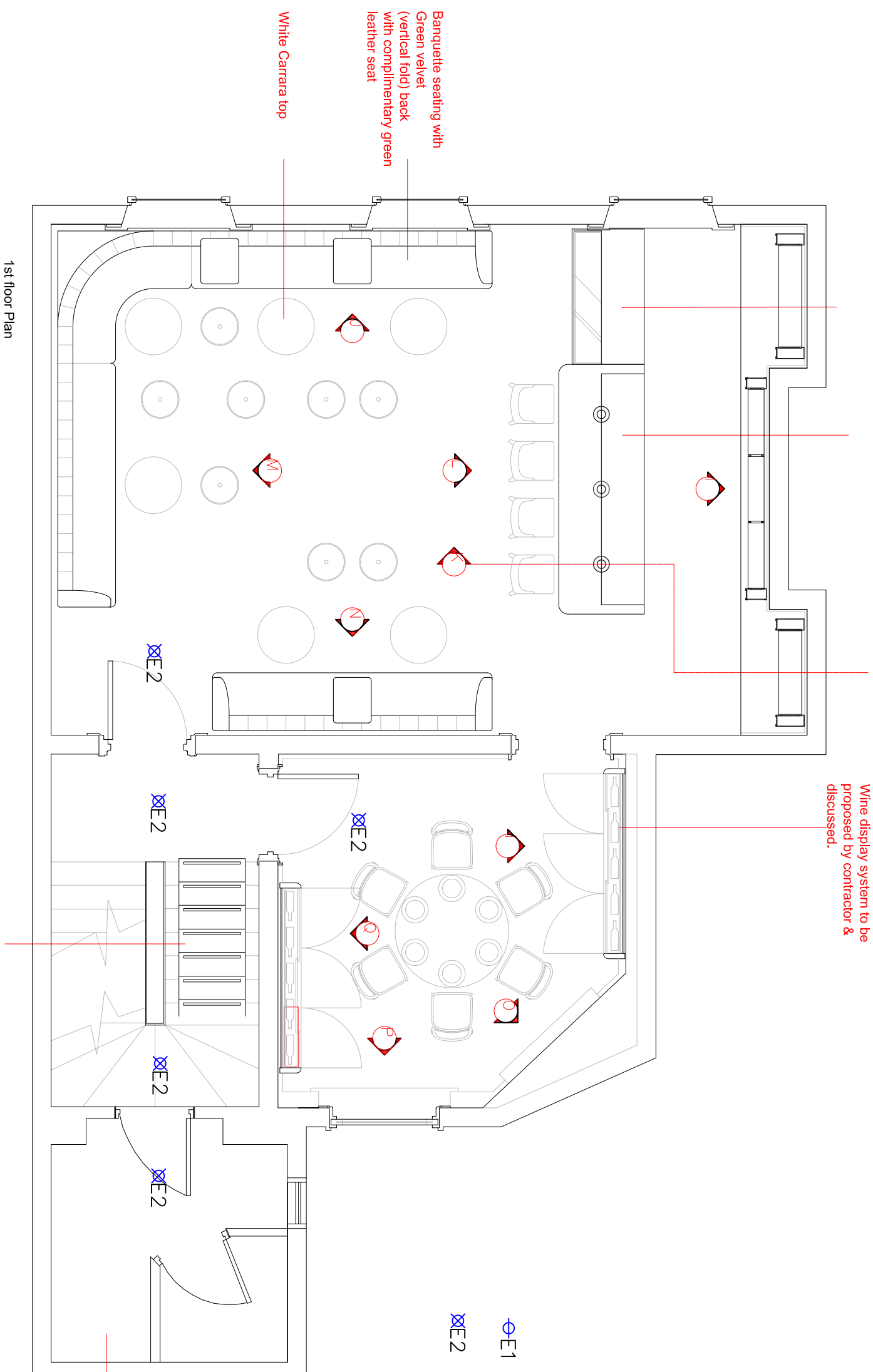

1st floor Plan

LUMINAIRE LEGEND

- ⊕E1 Merlin emergency downlight with escape route lens - AMELED/ER/3NM/ST
- ⊗E2 Merlin emergency downlight with open area lens - AMELED/OA/3NM/ST

Layout of WC to be left as is, with surfaces refinished. Mid-range tiles, ironmongery, sanitary wear to be spec.ed.

Central stair runner with Bronze nosing throughout.
Stairs to be stripped, restored and painted with handrail left in raw timber

JEFF LIM

Contact

+44 (0)7454 278756
jefflim007@googlemail.com

This drawing shows design intent only. Not for Date: 27 July 2015

Title: Floor 1 Plan

Drawing No.: 107

construction. This drawing is not to scale unless specified.

Details to be provided by appointed contractor(s) based on existing survey, conditions and restrictions.

All dimensions are in millimetres unless otherwise indicated.

Scale: 1:50

Drawn by: SW

Client: House of Ho

Remarks: -

Revision: -

Job: 1 Percy Street