

Notes

1. This drawing has been prepared in accordance with the scope of RPS's appointment with its client and is subject to the terms and conditions of that appointment. RPS accepts no liability for any use of this document other than by its client and only for the purposes for which it was prepared and provided.
2. If received electronically it is the recipient's responsibility to print to correct scale. Only written dimensions should be used.

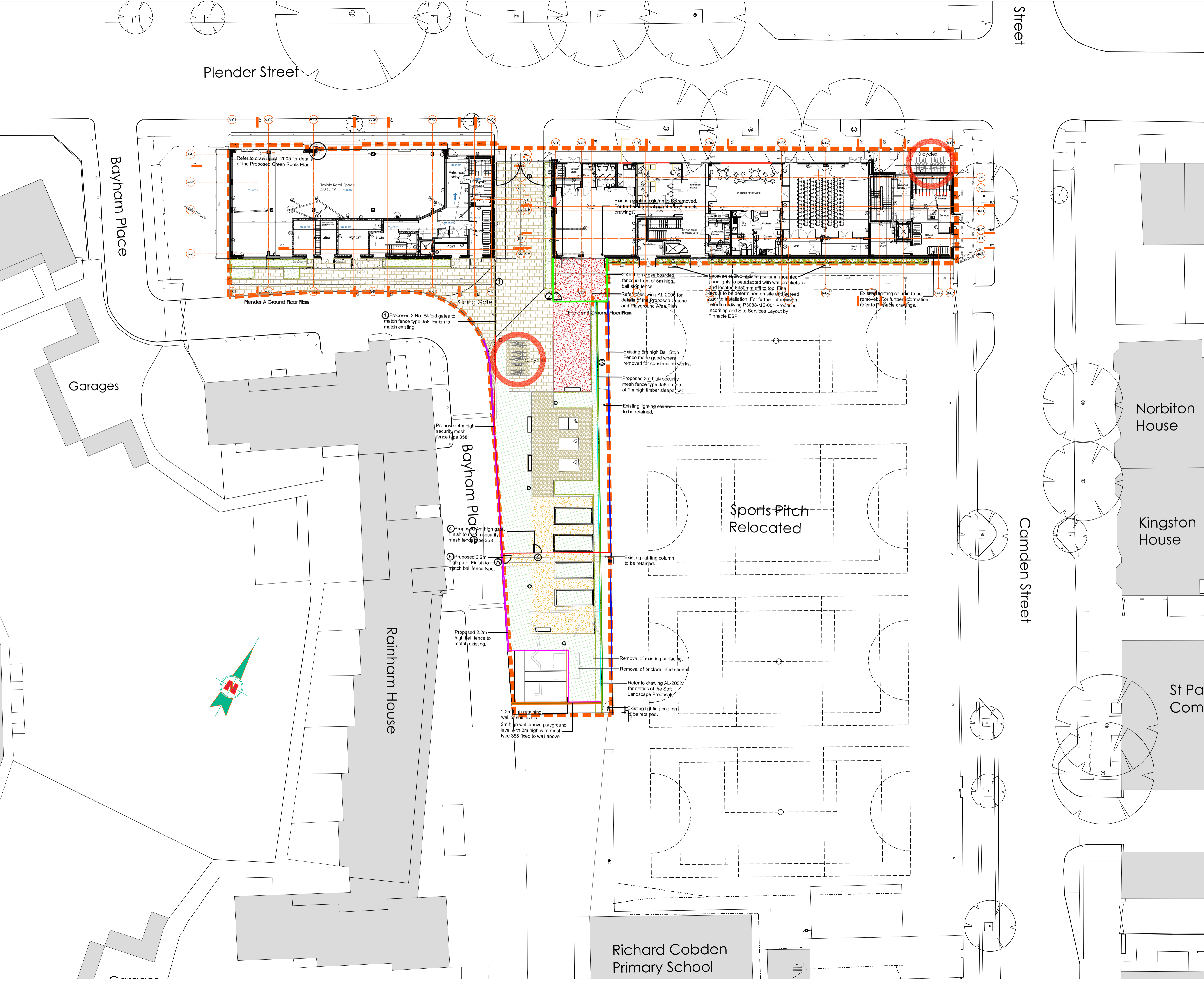

Rev	Description	Date	Initial	Checked
E	Agreed boundary with Richard Cobden School added	19.02.2015	KDR	
D	Cycle parking shown to communal space between Plender A and Plender B, and adjacent to Plender B residential entrance, 10 cycle parking spaces at each location.	21.08.2014	KDR	
C	GF Plender A and Plender B layouts amended.	23.05.2014	KDR	
B	GF Plender A and Plender B layouts amended.	05.03.2014	KDR	
A	Electricity sub station moved from community space into GF Plender A, GF Plender A layout amended	13.02.2014	KDR	

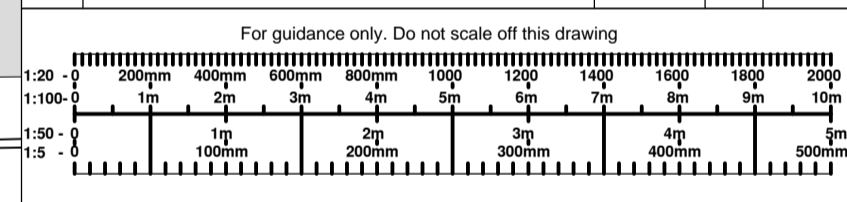

Highfield House, 5 Ridgeway
 Quinton Business Park, Birmingham B32 1AF
 T: +44(0)121 213 5500 E: rpsbm@rpsgroup.com F: +44(0)121 213 5502



Client **Higgins**
 Project **Plender Street Camden**

Title **Site Plan Proposed**

Status **Construction** Drawn By **KDR** PM/Checked by
 Job Ref **AAA5174** Scale @ **A1** Date Created
1:200 **05.12.2013**

Drawing Number **A-104** Rev **E**