

Lower Floor Plan (1:50)

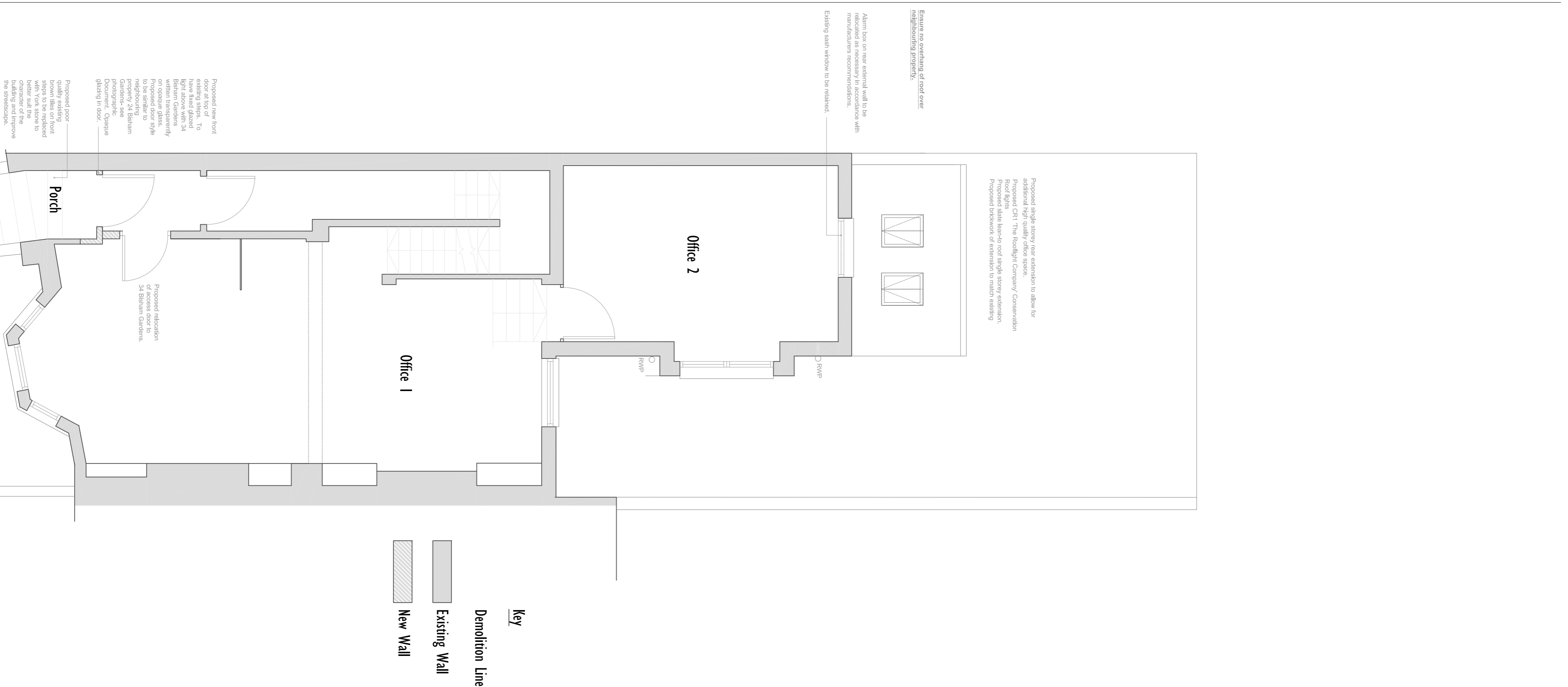

Upper Floor Plan (1:50)

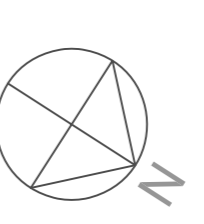

GENERAL NOTES

This drawing is the copyright of Scott Architecture Ltd. It is to be used only for the project for which it is issued. It is not to be reproduced, stored in a retrieval system, or transmitted in any form or by any means, electronic, mechanical, photocopying, recording, or otherwise, without the prior written permission of Scott Architecture Ltd. The architect's liability is limited to the design and construction of the building and its contents. The architect does not accept any liability for any other damage or loss of any kind, including consequential loss, arising from the use of the building or its contents. The architect's liability is limited to the design and construction of the building and its contents. The architect does not accept any liability for any other damage or loss of any kind, including consequential loss, arising from the use of the building or its contents.

The contractor is responsible for obtaining the consent and for carrying out all necessary works for the erection and use of the building and its contents. The contractor is responsible for ensuring that the building and its contents are used in accordance with the relevant regulations and for ensuring that the building and its contents are maintained in a safe and sound condition. The contractor is responsible for ensuring that the building and its contents are used in accordance with the relevant regulations and for ensuring that the building and its contents are maintained in a safe and sound condition.

For all structural information refer to structural engineer's drawings and details. Arrangements for fixed in situ concrete should be checked on the building works and approved by the structural engineer. All work shall be carried out in accordance with the relevant specifications, building regulations and the satisfaction of the structural engineer. All work shall be carried out in accordance with the relevant specifications, building regulations and the satisfaction of the structural engineer.

All materials and components must be suitable for use in the building and must be approved by the relevant authorities. The contractor is responsible for ensuring that all materials and components are used in accordance with the relevant specifications, building regulations and the satisfaction of the structural engineer. All work shall be carried out in accordance with the relevant specifications, building regulations and the satisfaction of the structural engineer.

All Dimensions and Levels to be checked on site