

Specification Sheet

lumenfacade™
COLOR CHANGING

Client _____ Project name _____

Order# _____ Type _____ Qty _____

FEATURES AND BENEFITS

Physical :

- Low copper content extruded aluminum housing
- Available in 1', 2', 3' or 4' sections
- Electro-statically applied polyester powder coat finish
- Machined aluminum end caps and silicone gaskets
- Stainless steel hardware
- Clear tempered glass
- Asymmetric wallwash, 10° x 10°, 10° x 60°, 30° x 60° or 60° x 60° optics
- IP66
- IK07 rated (asymmetric wallwash lens is IK06 rated)
- Corrosion-resistant coating for hostile environments**
- Meets 3G ANSI C136.31 Vibration standard for bridge applications

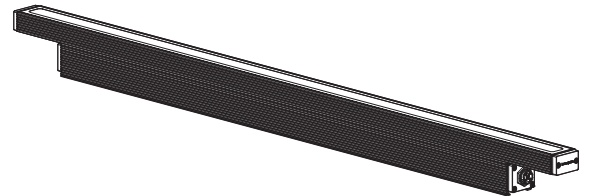

Performance :

- Minimum 1fc (10.7 lux) @ 102 feet (31.1m) distance (RGB full white, 4' unit, 10° x 60° optic)
- 2,041 delivered lumens and 10,415 candelas at nadir (RGB full white, 4' unit, 10° x 60° optic)
- Color mixing options: RGB (3 channels) or RGBW (4 channels)
- Lumen maintenance L70 @ 25°C - 120,000 hrs
- Lumen measurements comply with LM - 79 - 08 standard
- Resolution per foot or per fixture (see page 6)
- Operating temperatures: -25° C to 50° C [-13F to 122F]

Electrical :

- Line voltage luminaire for 100 to 277V
- Power and data in 1 cable (#16-5)
- Up to 112 feet with 1 power & data feed (277V)
- 17.25W/ft
- DMX 512 ready

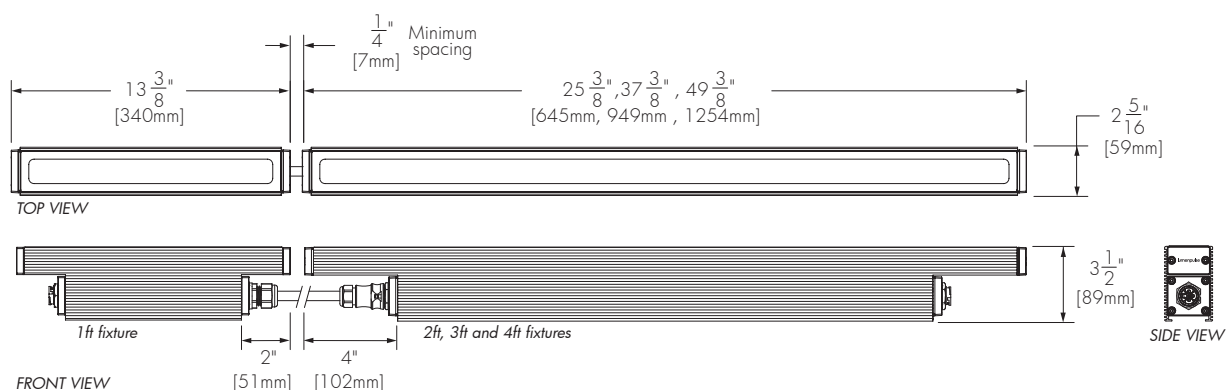

*Asymmetric wallwash lens is IK06 rated.

** Use only when exposed to salt spray and harsh chemicals. This option is not required for normal outdoor exposure!

1/8

2015.05.01
EM - R35

© Copyright Lumenpulse 2015

1751 Richardson, Suite 1505
Montreal (Quebec) Canada
H3K 1G6

1.877.937.3003

P.514.937.3003

F. 514.937.6289

info@lumenpulse.com

www.lumenpulse.com

5-year limited warranty.

Consult www.lumenpulse.com
for our complete Standard Terms
and Conditions of Sales.

lumenpulse

Lumenpulse reserves the right to make changes to this product at any time
without prior notice and such modification shall be effective immediately.

Specification Sheet

lumenfacade™

COLOR CHANGING

ASYMMETRIC WALLWASH OPTIC FEEDING SIDE DETAIL

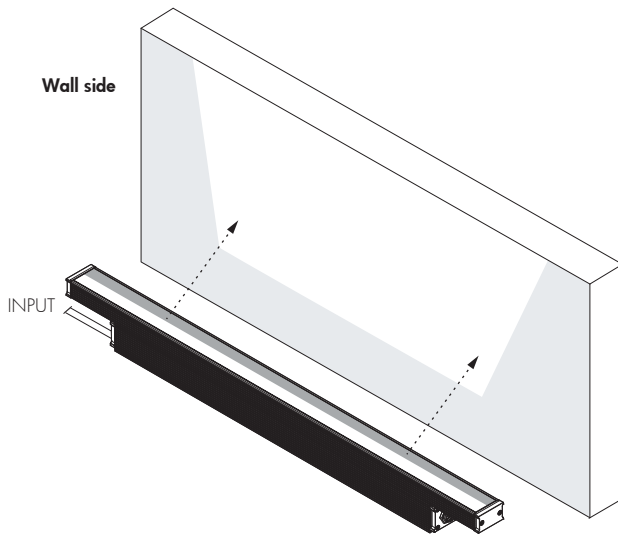

WWLF

Asymmetric Wallwash Optic, Left Feed

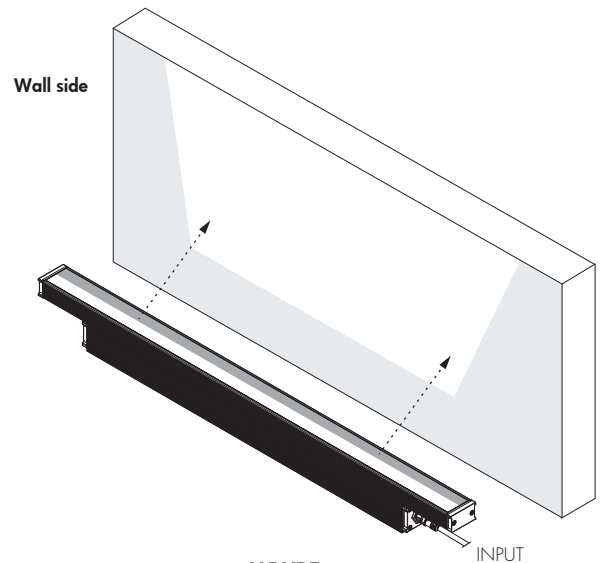

WWRF

Asymmetric Wallwash Optic, Right Feed

Always position frosted side toward the wall

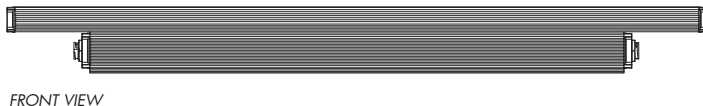
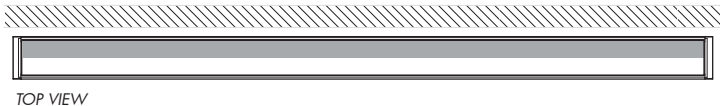

RIGHT SIDE VIEW
(Fixture pointing upwards)

*Fixture's feeding side is based on uplight installations. Feeding sides are reversed when fixture is used in a downlight application.

Recommended setback from wall is 1/10 of the wall height.

Example: 2ft setback for a 20ft wall.

Specification Sheet

MOUNTING OPTIONS

lumenfacade™

COLOR CHANGING

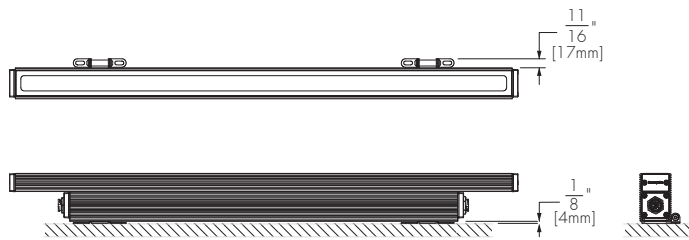

SAM
Slim Adjustable Mounting

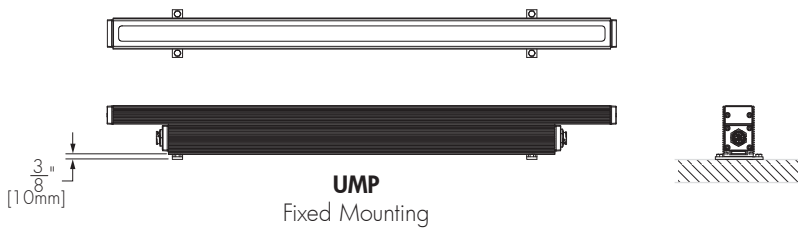

UMP
Fixed Mounting

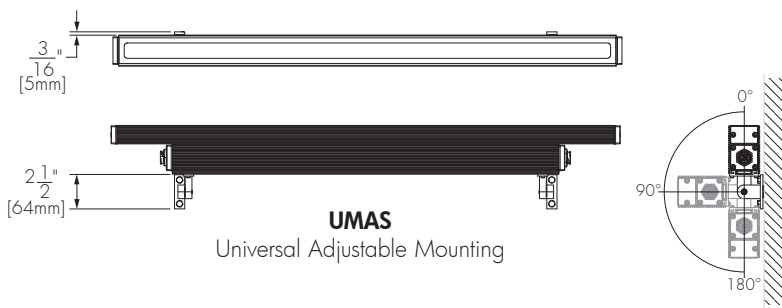

UMAS
Universal Adjustable Mounting

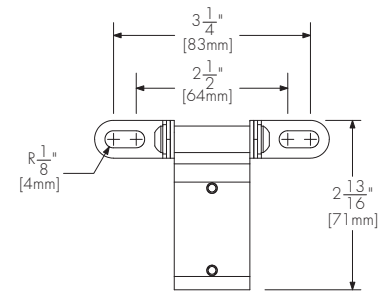

SAM
Mounting Hole Pattern

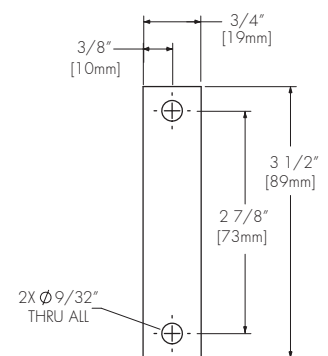

UMP
Mounting Hole Pattern

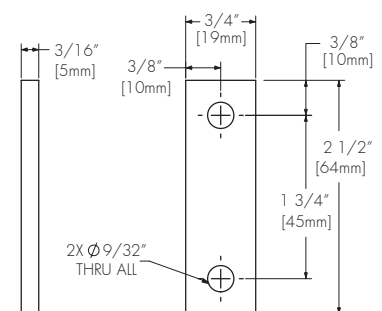

UMAS
Mounting Hole Pattern

Specification Sheet

lumenfacade™

COLOR CHANGING

MOUNTING OPTIONS - continued

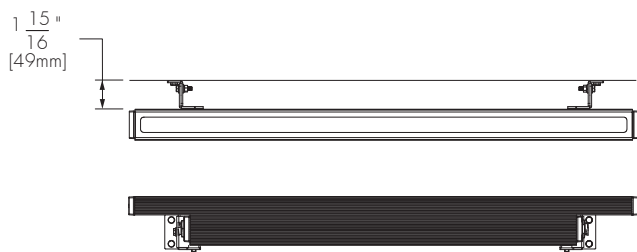

WAM2
Adjustable Wall Mounting

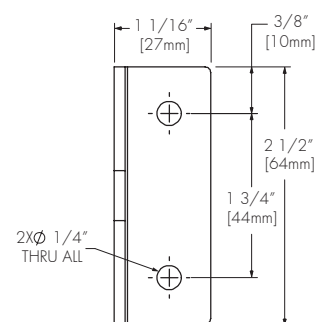
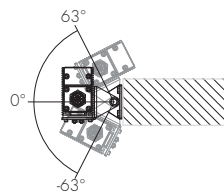

WAM
Mounting Hole Pattern

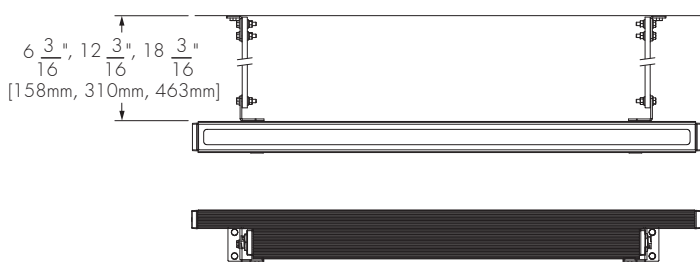

WAM6, WAM12 & WAM18
Adjustable Extended Arm Mounting

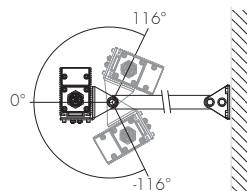

Specification Sheet

lumenfacade™

COLOR CHANGING

OPTION

ETE - End-to-end configuration,
no jumper cable needed.
16" cable included at input.

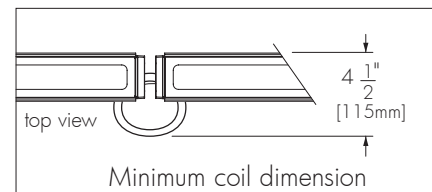
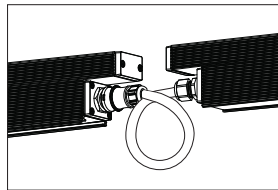

ACCESSORIES

Order separately

Control Systems:

- LTO2** Lumentouch is a wall mount DMX 512 controller keypad.
- LCU** Lumencue is a USB / mini SD DMX 512 controller.
- LID** LumenID is a diagnostic and addressing DMX 512 controller.
It must be specified on all DMX applications.
Refer to LID specification sheet for details.
- LTN** Lumentone is a simple pre-programmed DMX 512 controller
with a push button rotary dial and live feedback.

Control Boxes:

- CBX** DMX/RDM control box.
Up to six power and data outputs to fixtures or fixture runs.
Ethernet enabled option.
Refer to CBX specification sheet for details.

Leader Cable :

LOGLCD__ Leader Cable for Lumenpulse facade.
Please add desired cable length : 10', 25' or 50' [3m, 7.6m or 15.2m] standard lengths
Sealing endcap is mandatory for any unused connector.
(1) included with every leader cable

LOGLCD__-ETE Leader Cable for Lumenpulse facade, ETE option.
Please add desired cable length : 10', 25' or 50' [3m, 7.6m or 15.2m] standard lengths
Sealing endcap is mandatory for any unused connector.
(1) included with every leader cable

Jumper Cable :

LOGJCD__ Jumper Cable for Lumenpulse facade.
Please add desired cable length : 2' or 4' [0.6m, 1.2m] standard lengths

LOGJCD__-ETE Jumper Cable for Lumenpulse facade, ETE option.
Please add desired cable length : 2' or 4' [0.6m, 1.2m] standard lengths

RESOLUTION DETAILS

1FT - Resolution per foot: each foot is addressed independently (recommended for most installations).

DMX ADDRESSES:

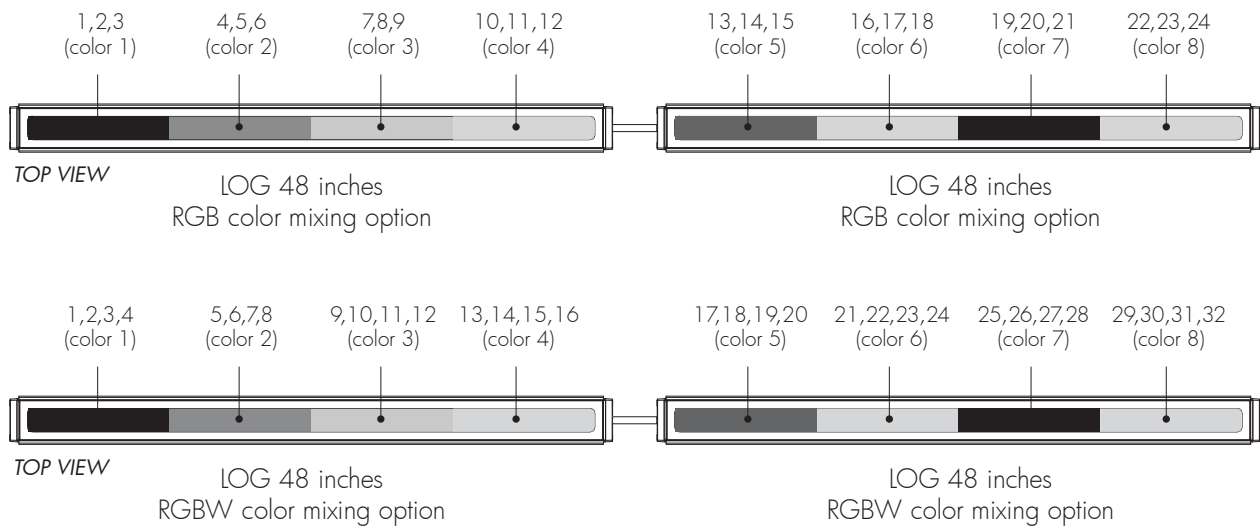

1FX - Resolution per fixture: each fixture is addressed independently

DMX ADDRESSES:



*Warning: resolution is a factory setting and cannot be changed in the field.

TYPICAL WIRING DIAGRAMS

Star Layout (DMX)

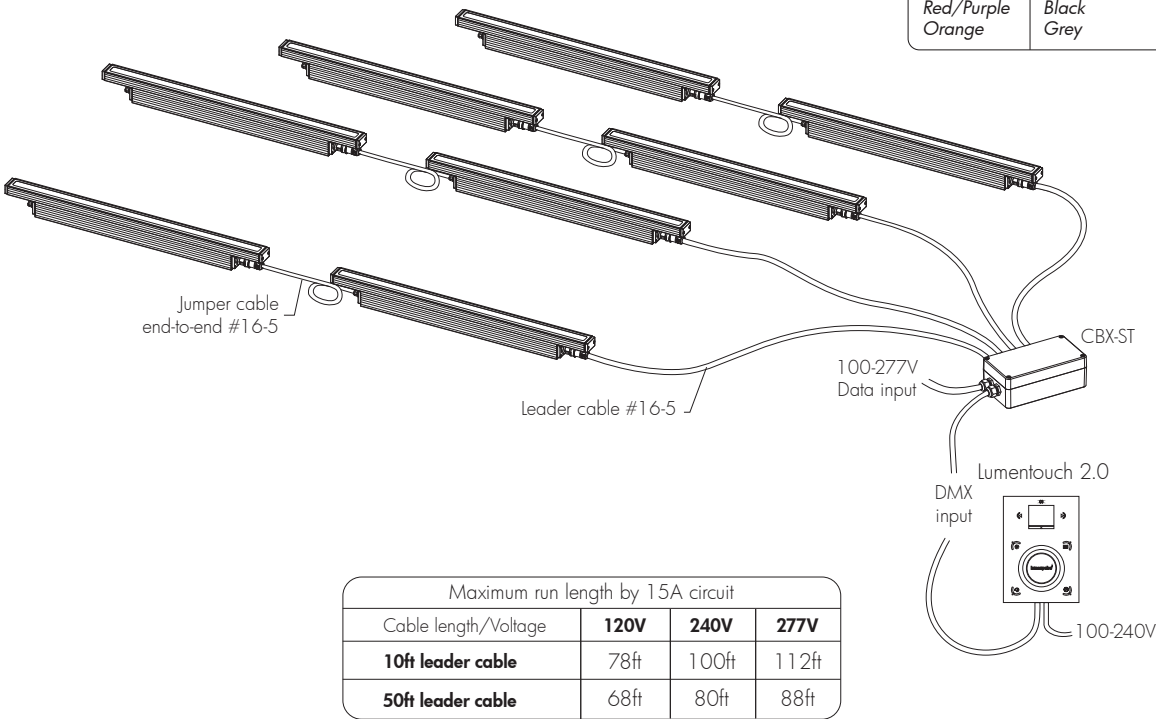

*Up to 170 individually addressable 1 foot sections per RGB DMX run.
*Up to 128 individually addressable 1 foot sections per RGBW DMX run.
*Maximum run length calculations are typically based on 4ft fixtures.
Consult factory for specific installation requirements.

Daisy Chain Layout (DMX)

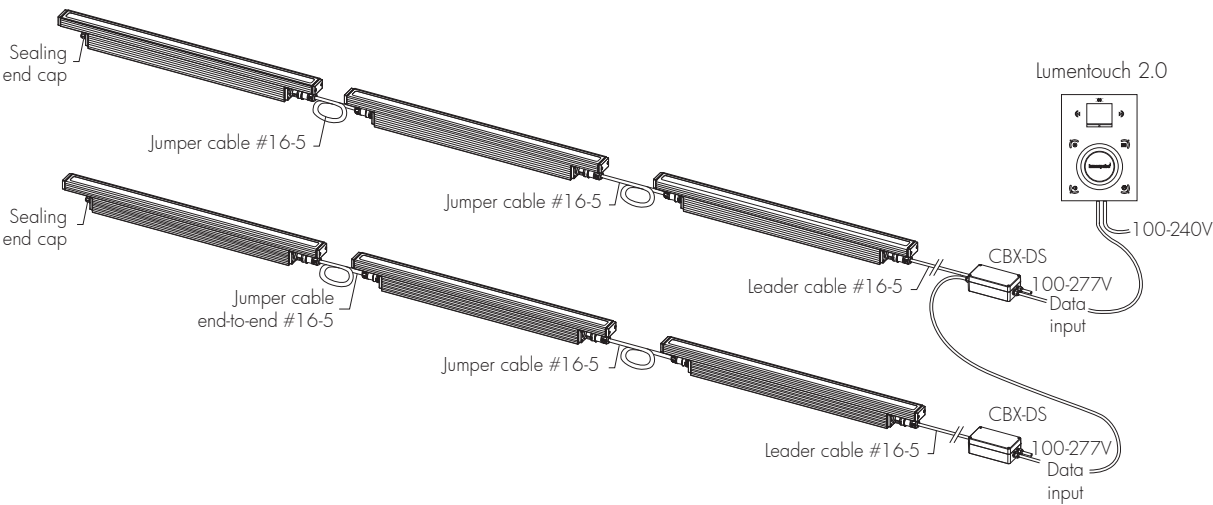

Specification Sheet

lumenfacade™

COLOR CHANGING

HOW TO ORDER

LOG	Select:	Select:	Select:	Select:	Select:	Select:	Select:	Select:
1	2	3	4	5	6	7	8	9

1

Housing:

LOG - lumenfacade™

2

Voltage:

100 - 100 volts	220 - 220 volts
120 - 120 volts	240 - 240 volts
208 - 208 volts	277 - 277 volts

3

Length:

12 - 13 3/8 inches (340mm) (2 kg/4.5 lbs)
24 - 25 3/8 inches (645mm) (3.17 kg/7 lbs)
36 - 37 3/8 inches (949mm) (4.75 kg/10.5 lbs)
48 - 49 3/8 inches (1254mm) (6.35 kg/14 lbs)

4

Colors and Color temperatures:

RGB - Additive red, green and blue
RGBW - Additive red, green, blue and white 4000K

5

Resolution:

1FT - Resolution per foot
1FX - Resolution per fixture

6

Optics:

WWLF - Asymmetric Wallwash optic, left feed*
WWRF - Asymmetric Wallwash optic, right feed*
10x10 - 10° x 10°**
10x60 - 10° x 60°
30x60 - 30° x 60°
60x60 - 60° x 60°

*Available September 2015. Right feeding side is standard unless otherwise specified.

**For best results use with 10° x 10° fixtures at a 6-inch (15cm) setback from surface. Contact factory for application support.

7

Mounting Option:

SAM - Slim Adjustable Mounting
UMP - Fixed Mounting
(Suitable to use when **3GV** option is specified)
UMAS - Universal Adjustable Mounting
(Suitable to use when **3GV** option is specified)
WAM2 - Adjustable Wall Mounting 2"
WAM6 - Adjustable Extended Arm Mounting 6"
WAM12 - Adjustable Extended Arm Mounting 12"
WAM18 - Adjustable Extended Arm Mounting 18"

8

Finish:

SI - Silver SandText
BK - Black SandText
WH - White
CC - Custom (please specify RAL color)

9

Option:

ETE - End - to - end configuration, no jumper cable needed
CRC - Corrosion-resistant coating for hostile environments
3GV - 3G ANSI C136.31 Vibration Rating
N.B. Available with UMP and UMAS mounting options only.

8/8

2015.05.01
EM - R35

© Copyright Lumenpulse 2015
1751 Richardson, Suite 1505
Montreal (Quebec) Canada
H3K 1G6

1.877.937.3003
P.514.937.3003
F. 514.937.6289
info@lumenpulse.com
www.lumenpulse.com

5-year limited warranty.

Consult www.lumenpulse.com
for our complete Standard Terms
and Conditions of Sales.

lumenpulse

Lumenpulse reserves the right to make changes to this product at any time without prior notice and such modification shall be effective immediately.