

CONSENTED SCHEME

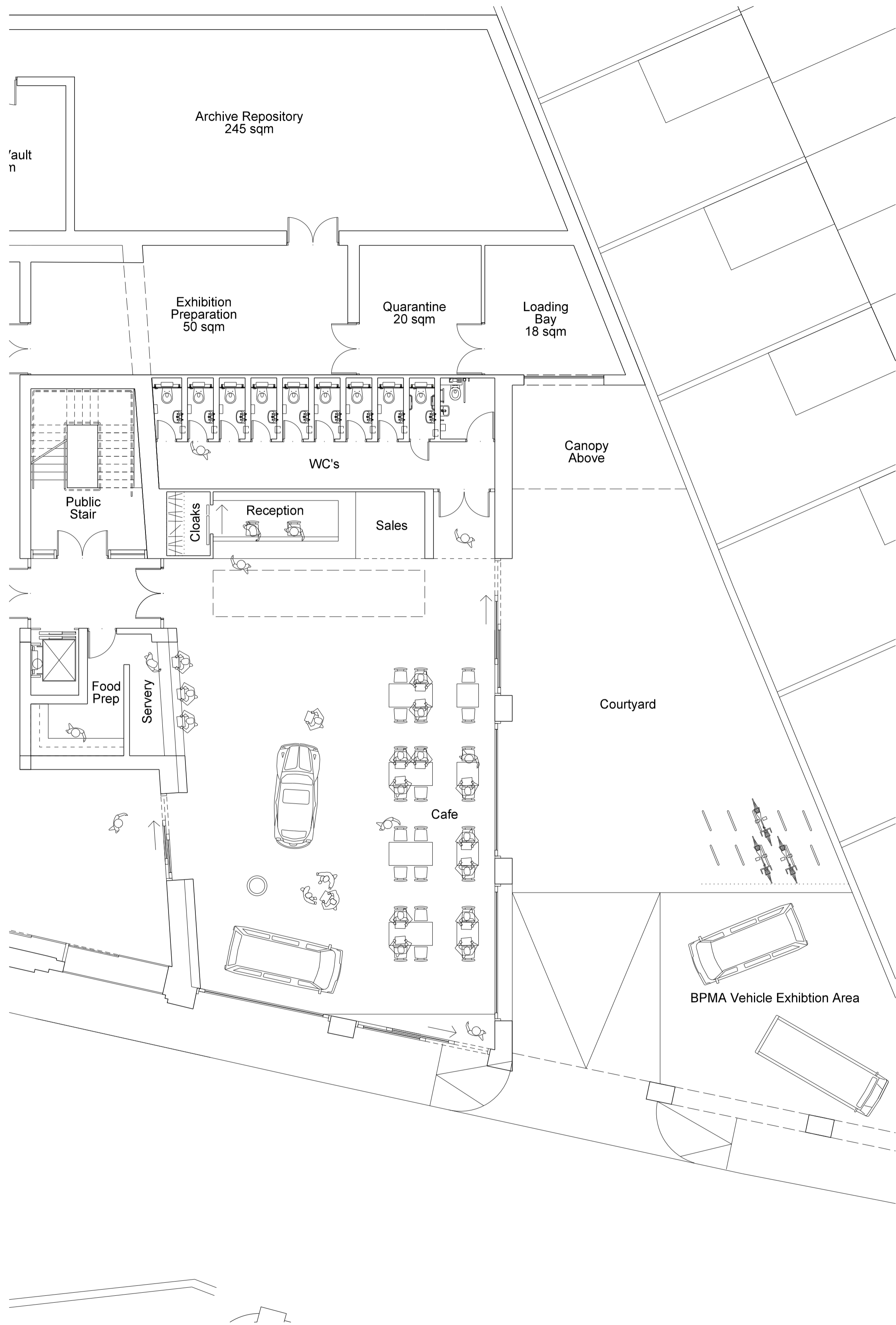

PROPOSED AMENDMENTS

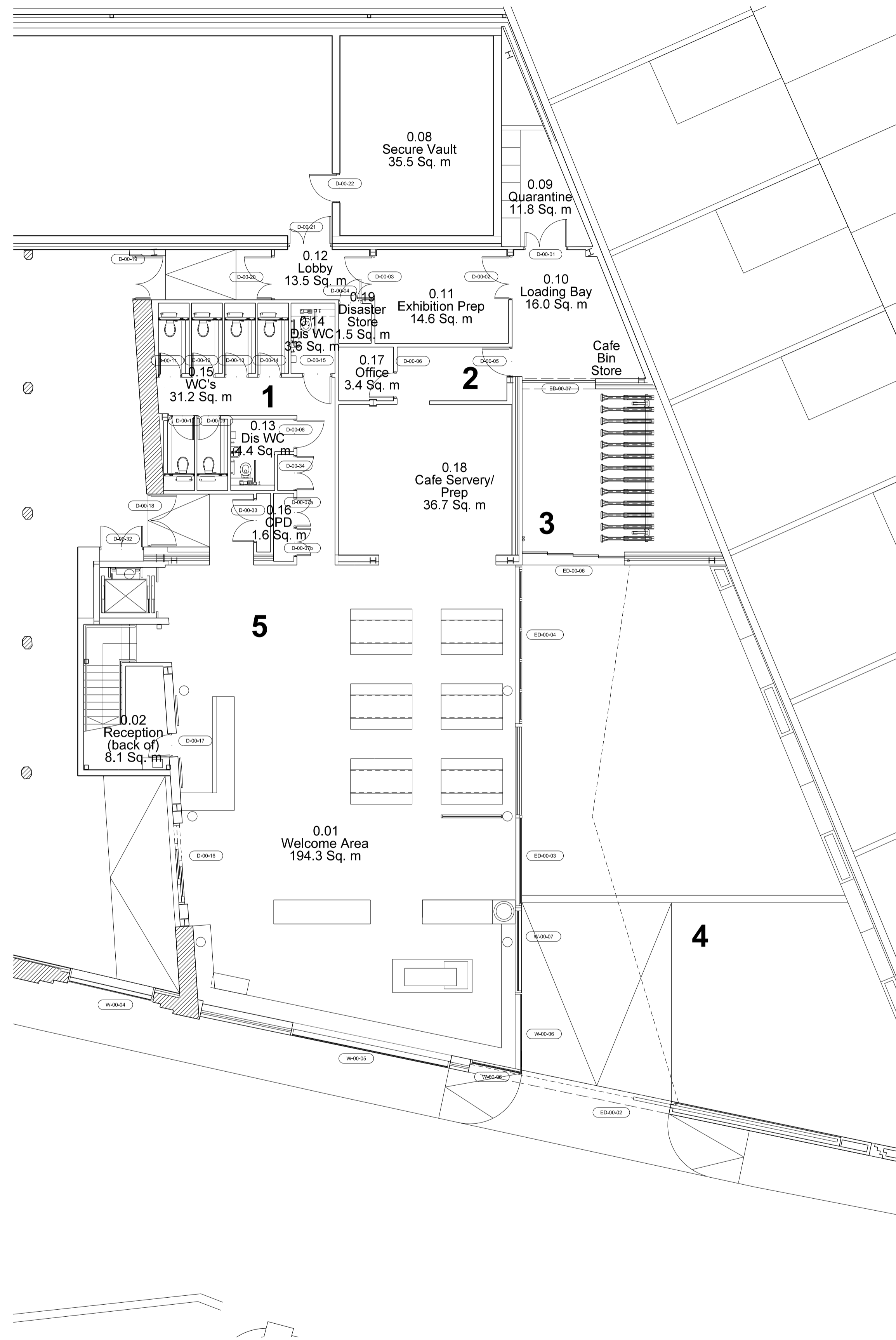

CHANGES TO CONSENTED SCHEME

- 1 WC's reconfigured to a unisex provision more efficient use of space, and economical provision.
- 2 Café and back of house reconfigured revised to meet client needs and requirements of specialist designer.
- 3 Cycle parking added behind new screen provides a more secure and discreet provision.
- 4 Raised area in the courtyard omitted no longer required.
- 5 Rooflight omitted Internal changes mean that this is no longer required.

Note:
Survey information contained in this drawing has been created by Plowman Craven Ltd.
All survey information is issued in good faith.
Feilden Clegg Bradley Studios LLP will not be held responsible for any inaccuracies identified.

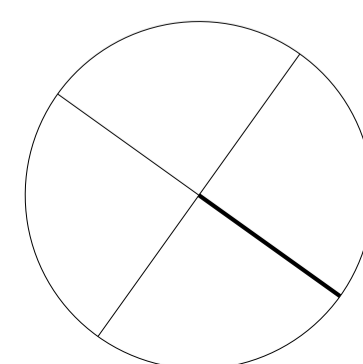

FeildenCleggBradleyStudios
LLP
Bath Brewery
Toll Bridge Road
Bath BA1 7DE
t 01225 852545
f 01225 852528
e bath@fcbstudios.com

Amendment _____ Date _____

APPLICATION FOR NON MATERIAL AMENDMENT

POSTAL MUSEUM, CALTHORPE HOUSE
MOUNT PLEASANT, LONDON
GROUND FLOOR PLAN
CONSENTED SCHEME &
PROPOSED AMENDMENTS
Do not scale
Original printed at A1

Job/Drawing No
1625/P/315
Amendment
Scale 1:100 (1:200 @ A3)
Date OCTOBER 2015
Drawn AT GROUP
All dimensions to be checked on site