

Section CC

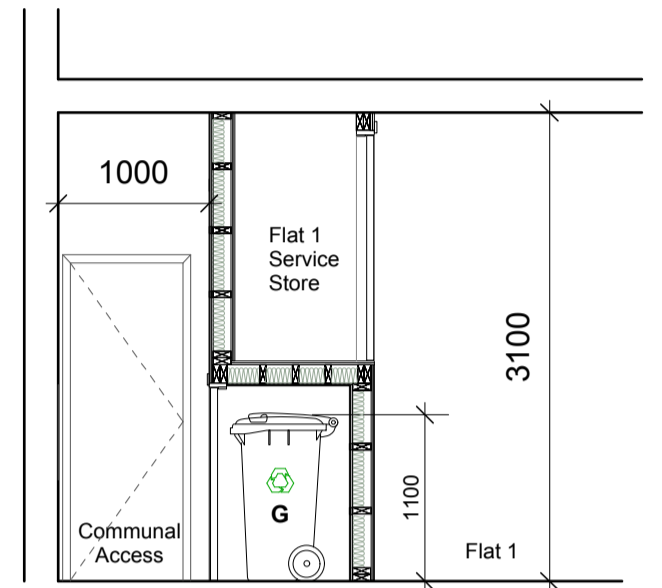

Section BB

240lt Mixed Used Recycle bin
Only to encourage recycling (dry waste)

Additional:
 Each flat to have 8lt food waste bin and 1x 70lt garbage waste bin.

General & Mixed Recycle Bins 240 litre

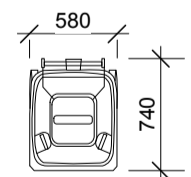
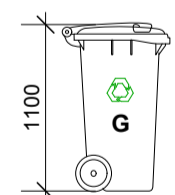

8 litre Food Waste Bin

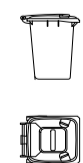

Niveda Realty

Address: Berkeley Square House, Berkeley Square, Mayfair, London, W1J 6BD, UK

Tel: 0207 887 6274
 E-mail: realty@niveda.com
 Website: www.niveda.com

Project:	LYME TERRACE	REVISION	DATE
	Proposed ground floor	REV 1	12/11/15
Drawing No:	NR04		
Scale:	Drawn		
1:50 @ A2 Size	INFORMATION ONLY		

Note:

FOR INFORMATION PURPOSES ONLY
 PROPERTY OF NIVEDA REALTY