

16 - 18

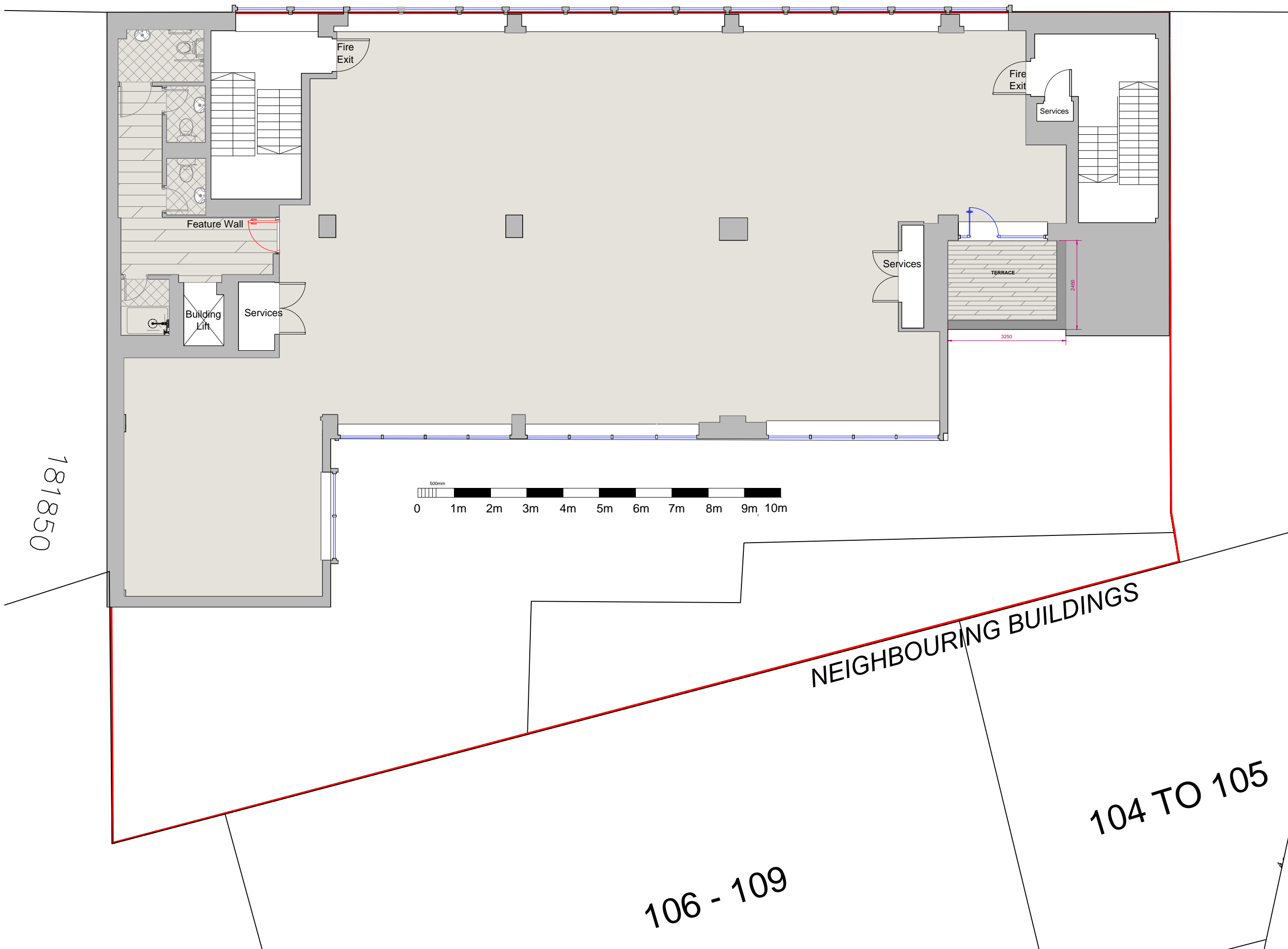

181850

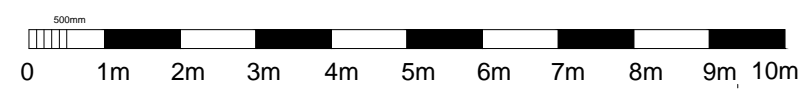

NEIGHBOURING BUILDINGS

104 TO 105

106 - 109

ThirdWay  
©Copyright

Copyright of this drawing belongs to & is vested in **THIRDWAY INTERIORS** and may not be reproduced or without written consent by **THIRDWAY INTERIORS**. Any persons, firm or company unlawfully reproducing or distributing this drawing or in any way infringing the copyright therein will be prosecuted.

This document is the property of **THIRDWAY INTERIORS**. Copyright is reserved by them, and the drawing is issued on the condition that it is not copied, reproduced or retained by, nor disclosed to any unauthorised person, either wholly or in part, without the consent in writing from **THIRDWAY INTERIORS**.

**Note**  
ALL DIMENSIONS MUST BE CHECKED ON SITE. DO NOT SCALE FROM THIS DRAWING. THIS DRAWING IS FOR DISCUSSION PURPOSES ONLY AND IS SUBJECT TO FIRE OFFICER AND BUILDING REGULATION APPROVALS BEING OBTAINED.

**Drawing Approval**

Client Signature	
Printed Name	
ThirdWay Signature	
Date	
Specification Ref	

**Status**

- Preliminary/Info.
- Contract
- Construction
- Approval/Comment
- As-Built
- Building Control

**Revision Detail**

Rev	Detail	By	Date

**PRELIMINARY DRAWING**

Client

Project Title  
4TH FLOOR  
16 - 18 KIRBY STREET  
EC1N, LONDON

Drawing Title  
PROPOSED PLAN  
CONCEPTUAL LAYOUT

Date: 02/11/2015 Drawn By: DT

Scale: 1:100@A3 Rev: D

Drawing No: TWI-1075-04- PROPOSED

ThirdWay  
ThirdWay Interiors Ltd  
2nd Floor 3-5 Bleeding Heart Yard  
London EC1N 8SJ