

**Notes:**

1. This drawing is for the purpose of Planning Application only. It is not to be used for construction.
2. Copyright of this drawing is the property of Francis Hur Architecture Ltd (FHA) and may not be reproduced without their permission.
3. Written dimensions to be used in preference to scaled dimensions at all times. Dimensions marked with +/- are indicatively approximate only. All dimensions and levels to be verified on site and any discrepancies to be reported to FHA.
4. Drawings are based on the assumption that adequate load bearing capacity stratum will be encountered at the depths indicated. If this is found not to be the case, the depths must be increased to the satisfaction of the building inspector and building regulation requirements.

Front garden lightwell with metal grille per Planning Permission Ref: 2014/7077/P, decision dated 27 Oct 2015

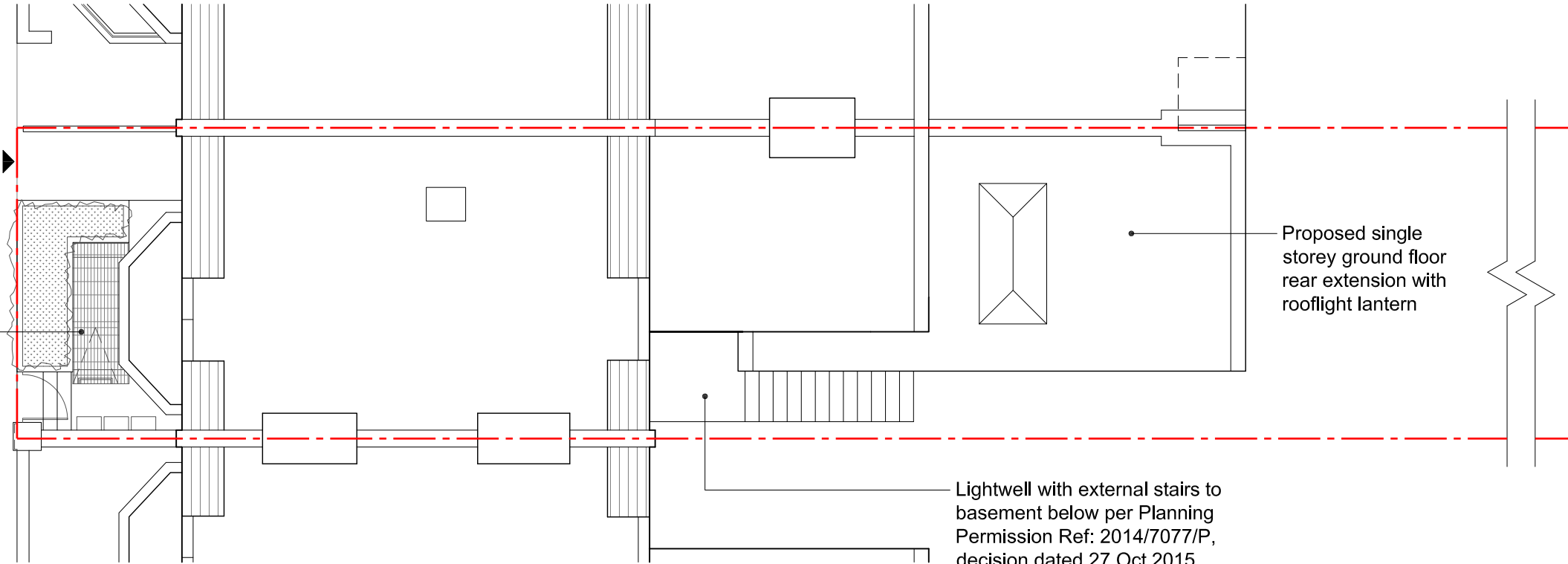

**2 Site / Roof Plan - Proposed**  
 Scale 1:100 5m

Lightwell with external stairs to basement below per Planning Permission Ref: 2014/7077/P, decision dated 27 Oct 2015. Amended to accommodate ground floor rear extension

Proposed single storey ground floor rear extension with rooflight lantern

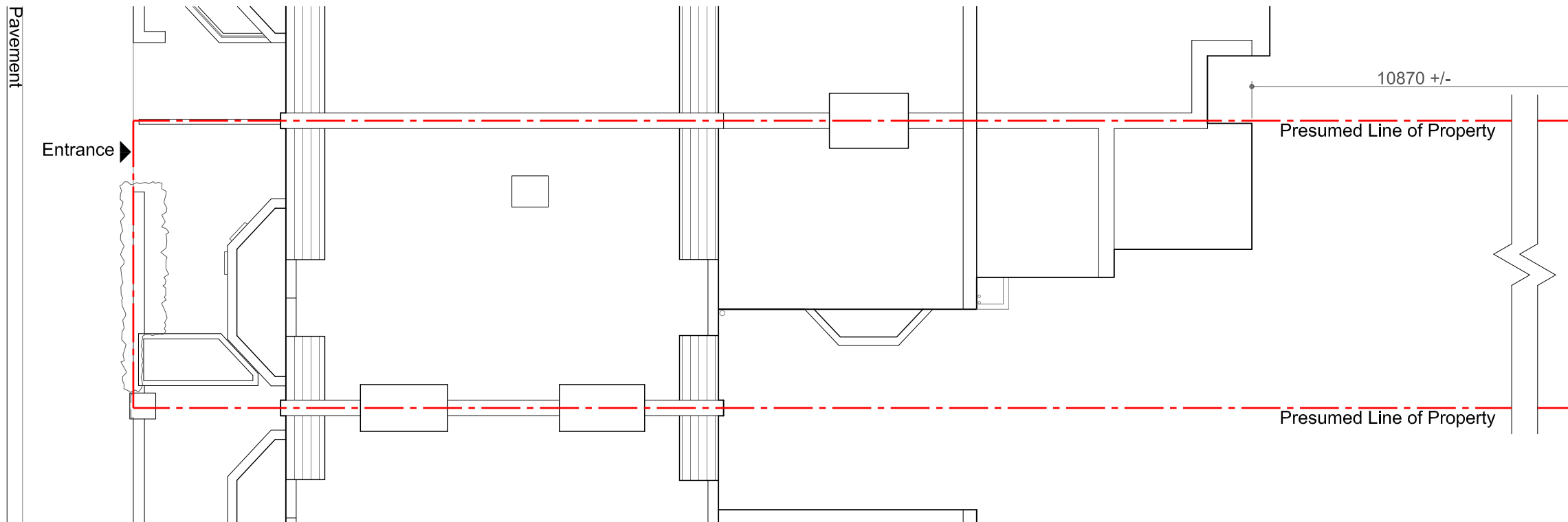

**1 Site / Roof Plan - Existing**  
 Scale 1:100 5m



Rev:	Date:	Description:

Status:  
**Planning Application**

Project Address:  
**Ground Floor Flat  
 6 Sumatra Road  
 London, NW6 1PU**

Drawing Title:  
**Site / Roof Plan -  
 Existing / Proposed**

Project no: 1413	Drawn by: FH	Date: 11 Nov 2015
---------------------	-----------------	----------------------

Page size: A3	Page no: 1 of 9	Drawing no. <b>A-001</b>
------------------	--------------------	-----------------------------